

Manual addendum for: PL-REM

Change Relay A/B mode

The relays A & B can be used to control auxiliary circuits like garden lighting or a pool cover.

The operation mode of these relays can be modified:

Option 1: Normal open/closed contact

Option 2: Pulsed contact

Modification process:

1. Locate the 5 pinholes on the circuit board.
2. Make a connection between pin 1 and 2.
(use a piece of wire, or a paperclip)
3. Power ON the device by connecting a 230VAC power source to the 220-240VAC INPUT terminal.
4. Power OFF the device.
5. Remove the connection between pin 1 and 2.

Every time the above process is repeated, the A & B relays switch between Normal open/closed mode and Pulsed operation mode.

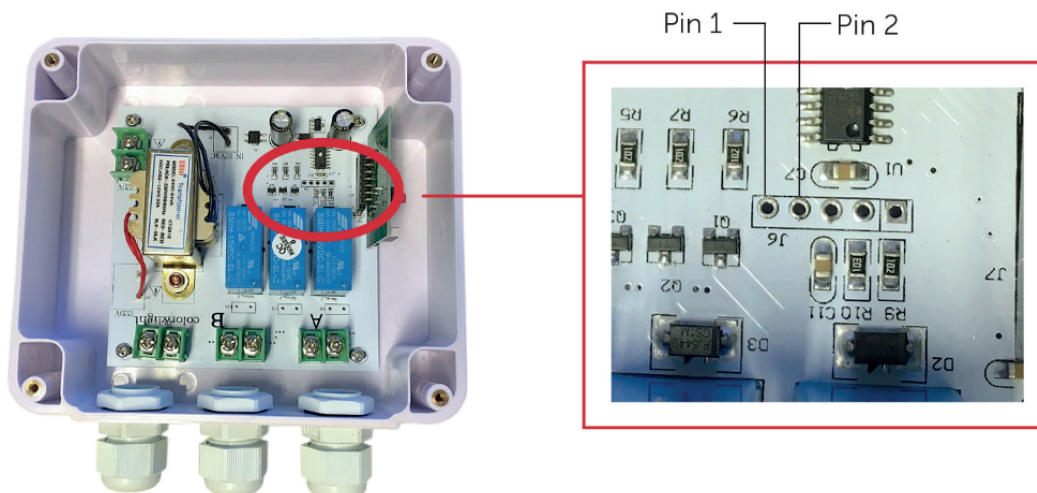

402-0239-190523

LINK Driver