

AUTOMATIC COVER

Rollinside

Roll-inside 1 side

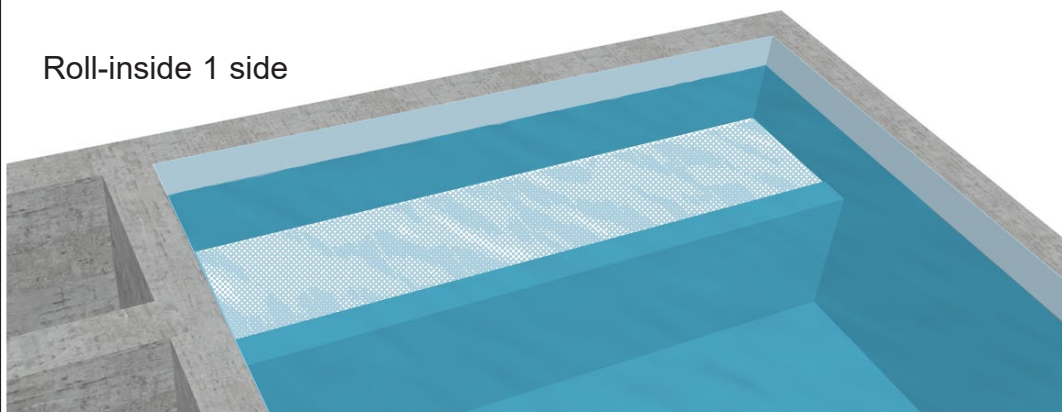

Roll-inside 2 sides

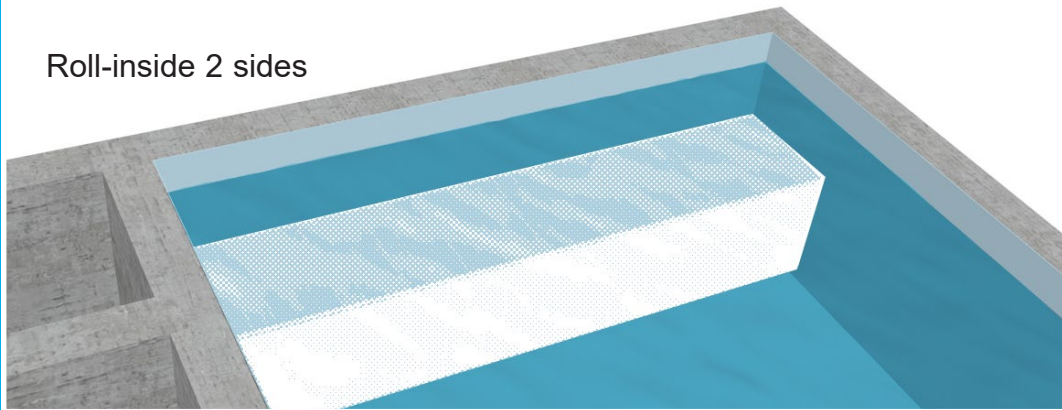

TECHNICAL INSTRUCTIONS

Installation / Use / Cleaning / Maintenance / Safety advice

FIJA Group

DEL

SWIMMING POOL DEVELOPMENT AND INNOVATION



**NOTICE TO BE GIVEN TO THE USER AFTER INSTALLATION IS COMPLETE
PLEASE READ CAREFULLY AND KEEP IN A SAFE PLACE.**

INFORMATION

For concrete, cellular concrete, full or hollow masonry pools with a reinforced membrane or tile waterproofing.

Roll-inside is an automatic immersed cover composed of mechanical parts and an underwater PVC cover pit.

The Roll-inside is available in several versions:

- Box work 1 side or 2 sides.
- Gear motor in a dry or immersed pit.
- Fixture mode: Using inserted parts or surface mounted on the façade.
- The mains supply comes from the electric control panel in the technical room
(Boxes compliant with electricity standards: C 15-100 / NF EN 60335 / NF EN 61000-6-3 / NF EN 55014-1)
- The automatic stops are adjusted in the motor or in the control panel (depending on the model)
- The key switch is located in a dry location with the pool in view.
- The cover is made of watertight floating cover slats.
- The closed pool can be secured with optional safety locking kits located on the width of the pool.
- The total operating gap between the walls and the slats is 70 mm.
- The vertical and horizontal covering consists of several 1 x 0.75m decking elements fixed on beams.

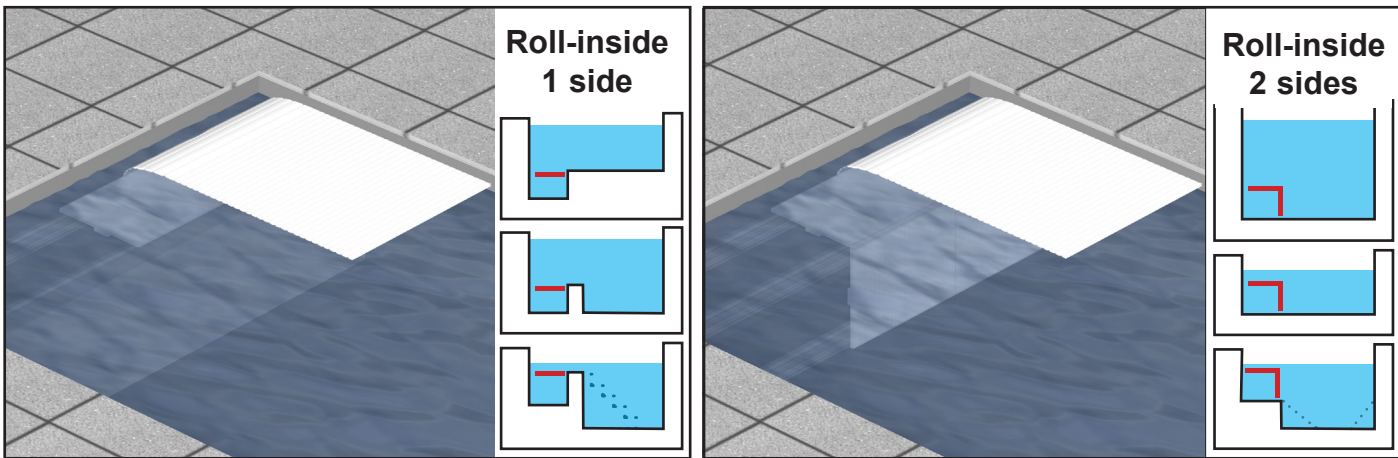

Unless otherwise specified by the manufacturer, immersion alarms are not compatible with DEL automatic covers.

TOOLS REQUIRED FOR ASSEMBLY (INSTALLATION – 2 PERSONS)

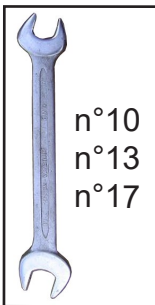

Roll-inside - for insert mounting - motorisation in a dry pit

DELIVERED PARTS

Parts to insert

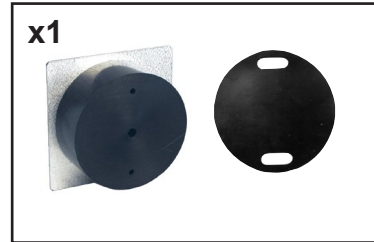
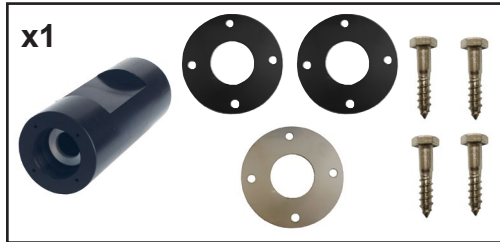
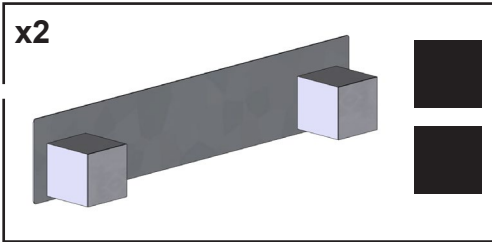

Mechanism

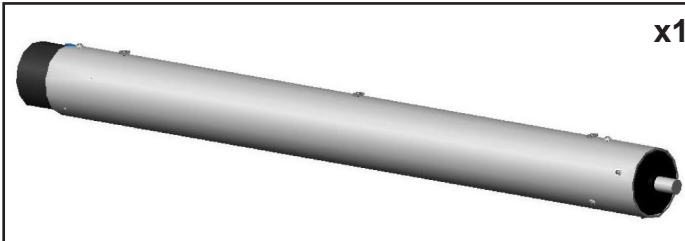

Counter-weight

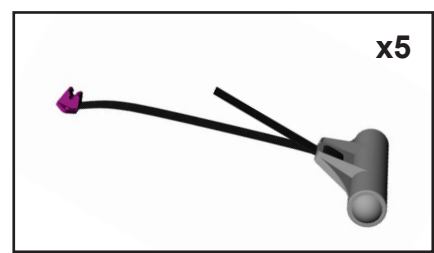

Mechanical fastener bag

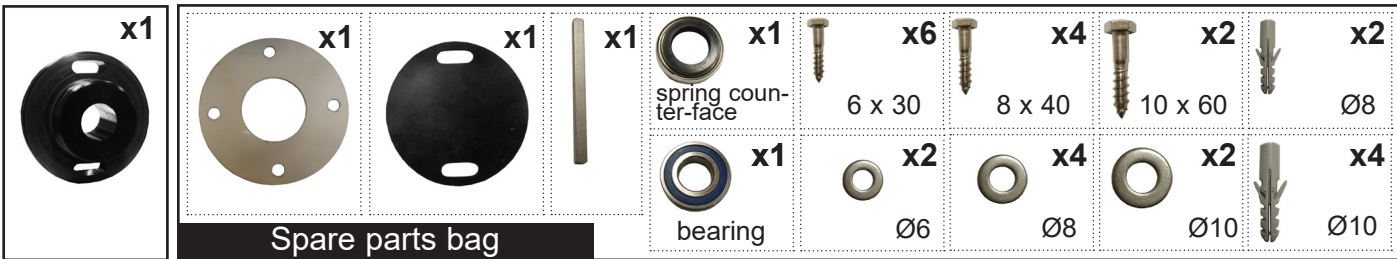

Beam support

For roll-inside 1 side

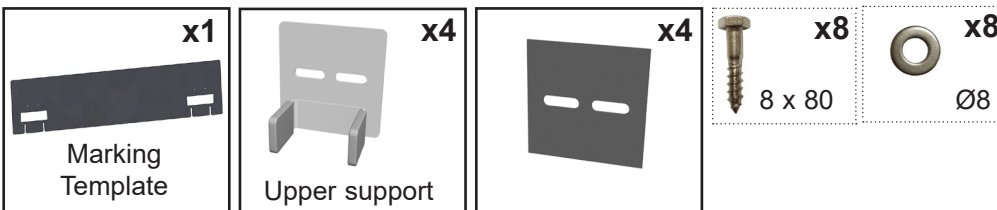

For roll-inside 2 sides

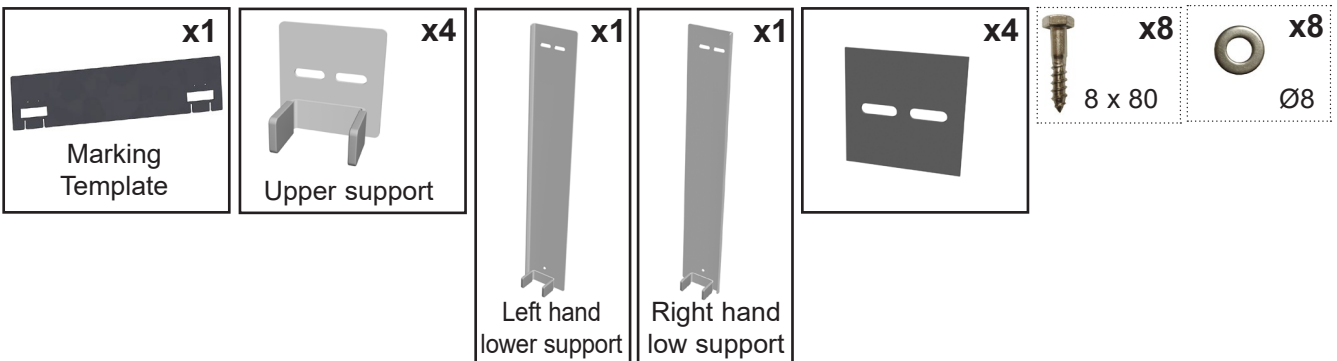

Beam

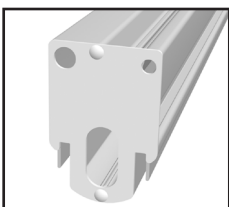

2 beams for roll inside 1 side
3 beams for roll-inside 2 sides

Gear motor with support



or

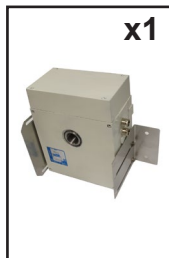

or



Protection cap

Electric box



Key-operator box



Wi-key

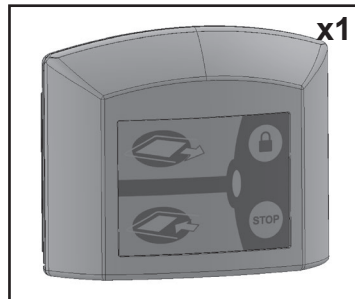

Decking

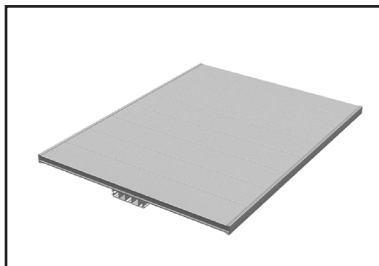

Slats

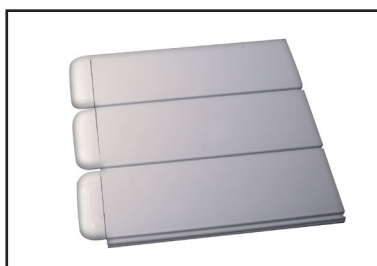

Fastening kits



Push-lock

PACKING LIST

e.g. for a 5 x 10 m pool with Ø3 m roman steps

Wall units:

For beam support: 1 box of 1 x 0.20 x 0.20 m -- 10 kg

For the mechanism (tube): 1 box of 0.30 x 0.20 x 0.20 -- 5kg

Mechanism (tube) :

1 box of 5 x 0.25m -- 40 kg

Installation kit + motor + control panel + weights + optional safety locking kit

1 box of 0.80 x 0.60 x 0.65 -- 45 kg

Beam support:

1 side : 1 box of 0.75 x 0.25 x 0.15 -- 4kg

2 sides : 1 box of 0.75 x 0.25 x 0.15 -- 10kg

The beams:

1 side : 2 box of 5.1 x 0.17 x 0.12 -- 60 kg

2 sides : 3box of 5.1 x 0.17 x 0.12 -- 90kg

Decking :

1 side : 1 pallet of 1.20 x 1 x 0.40 -- 40kg

2 sides : 1 pallet of 1.20 x 1 x 0.40 -- 70 kg

Slats :

5 box of 5.1 x 0.20 x 0.25 -- 250 kg

Total weight :

Roll-inside 1 side: 454 kg

Roll-inside 2 sides: 520 kg



Roll-inside - for insert mounting - tubular immersed motorisation

DELIVERED PARTS

Parts to insert

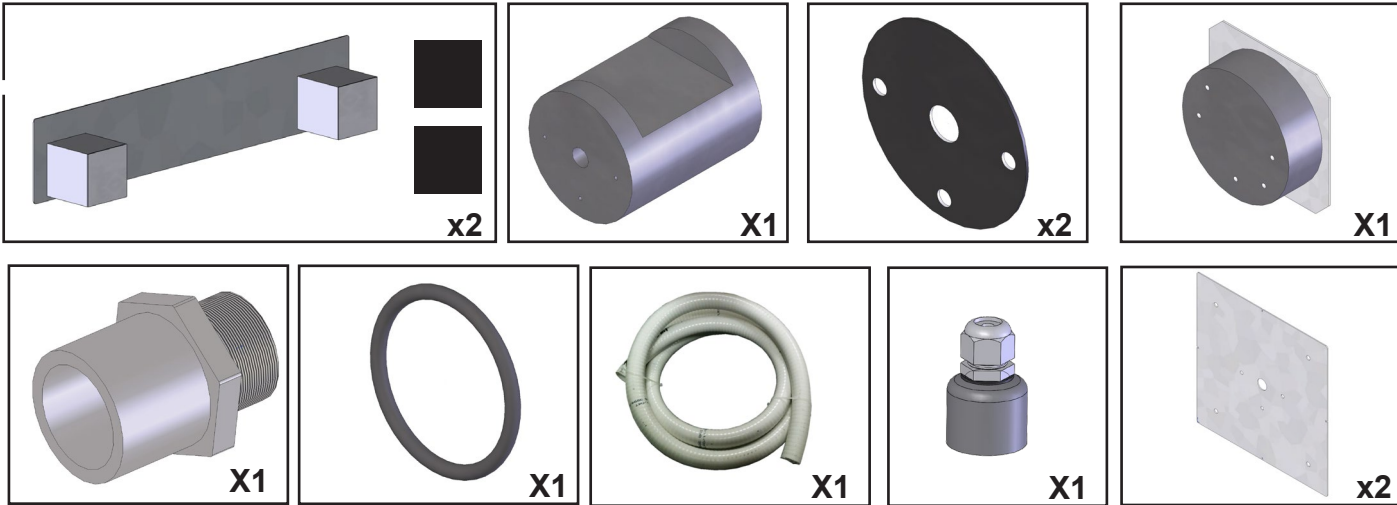

Mechanism

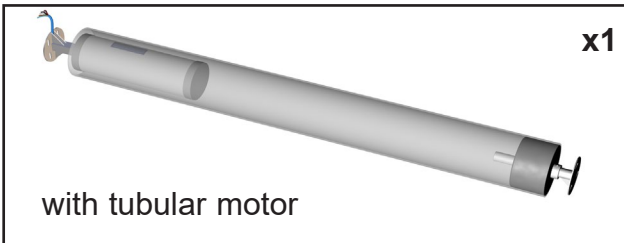

Counter-weight

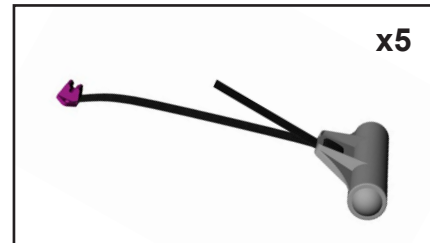

6

Mechanical fastener bag

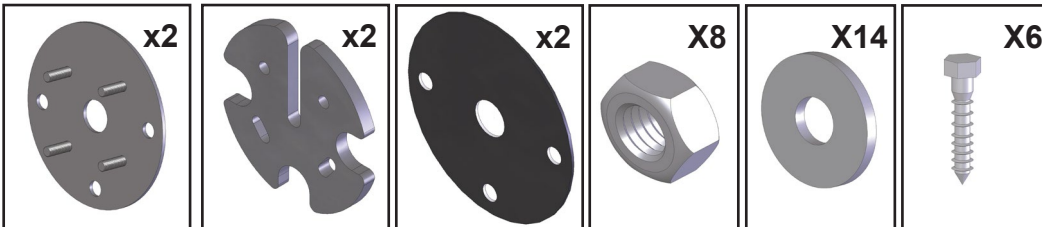

Beam support

For roll-inside 1 side

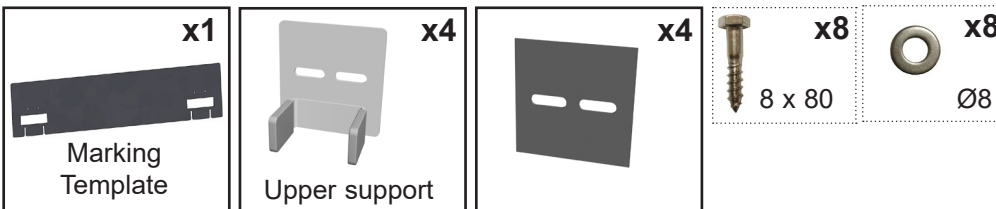

For roll-inside 2 sides

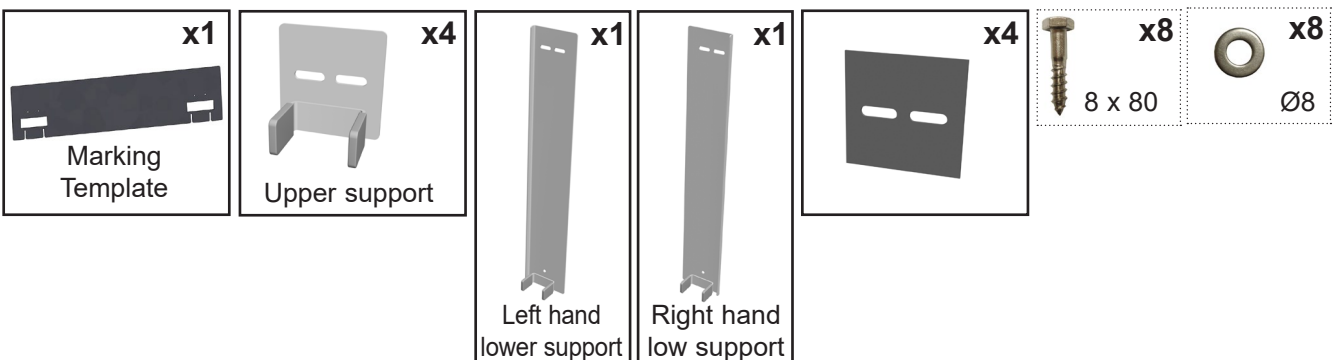

Beam

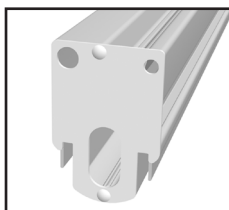

2 beams for roll-inside 1 side
3 beams for roll-inside 2 sides

Electric box



Key switch

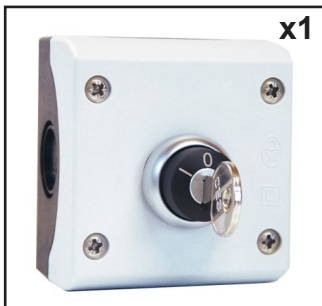

Wi-key

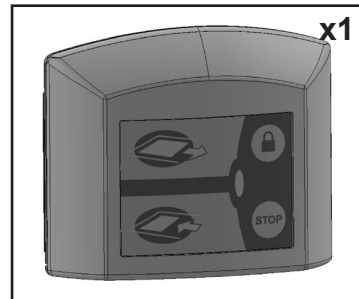

or

Decking

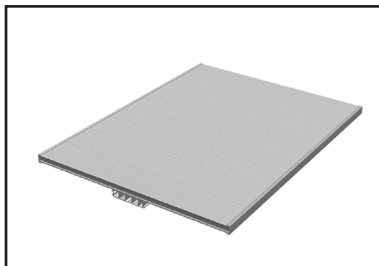

Slats

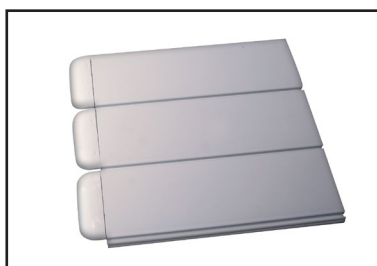

Fastening kits

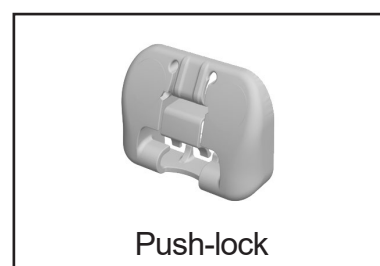

PACKING LIST

e.g. for a 5 x 10 m pool with Ø3 m roman steps

Wall units:

For beam support: 1 box of 1 x 0.20 x 0.20 m -- 10 kg

For tube: 1 box of 0.30 x 0.20 x 0.20 -- 5kg

The mechanism (tube) with the gear motor:

1 pack containing 5 x Ø0.25 m -- 50 Kg

The installation kit + control box + counter-weights + fastener kits:

1 pack containing 0.80 x 0.60 x 0.65 -- 45 kg

Beam support:

1 side : 1 box of 0.75 x 0.25 x 0.15 -- 4kg

2 sides : 1 box of 0.75 x 0.25 x 0.15 -- 10kg

The beams:

1 side : 2 box of 5.1 x 0.17 x 0.12 -- 60 kg

2 sides : 3box of 5.1 x 0.17 x 0.12 -- 90kg

Decking :

1 side : 1 pallet of 1.20 x 1 x 0.40 -- 40kg

2 sides : 1 pallet of 1.20 x 1 x 0.40 -- 70 kg

Slats :

5 box of 5.1 x 0.20 x 0.25 -- 250 kg

Total weight :

Roll-inside 1 side: 454 kg

Roll-inside 2 sides: 520 kg



Roll-inside - surface mounted - tubular immersed motorisation

DELIVERED PARTS

Parts to insert (inserting kit)

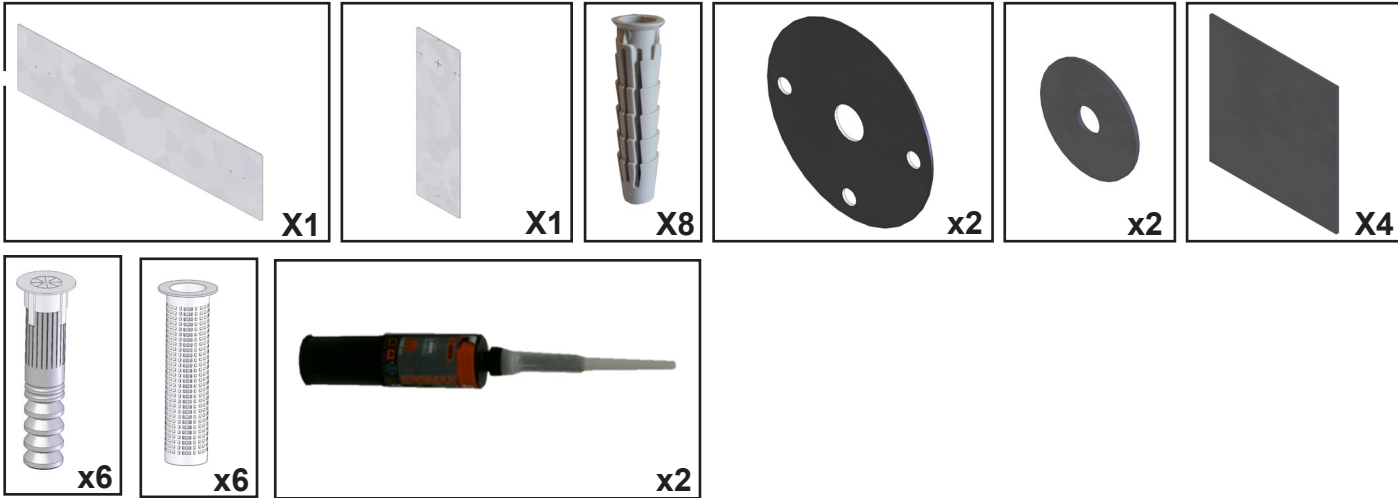

Mechanism

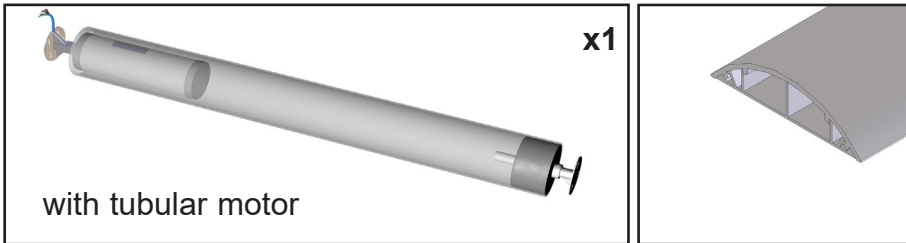

Counter-weight

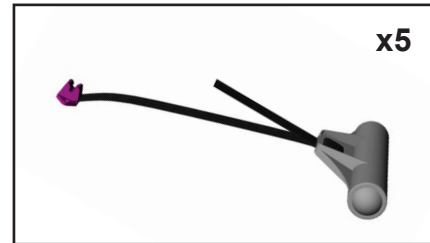

Mechanical fastener bag

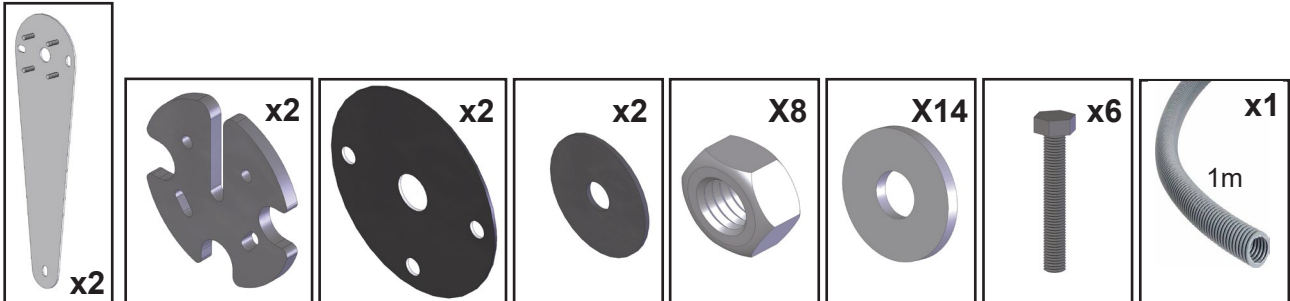

Beam support

For roll-inside 1 side

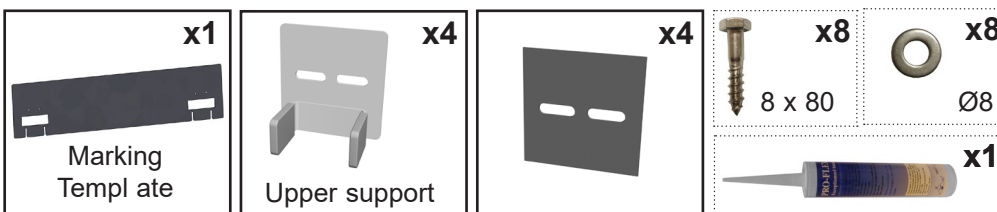

For roll-inside 2 sides

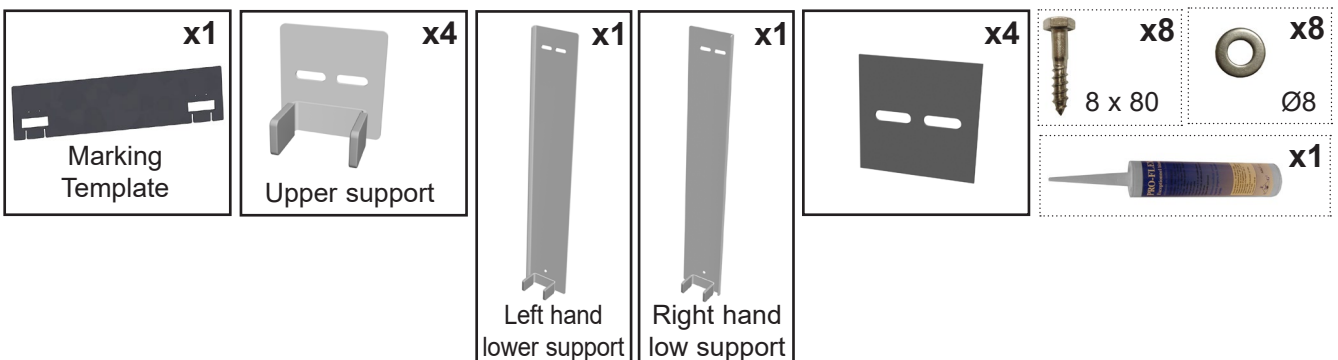

Beam

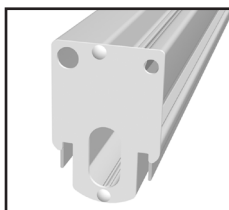

2 beams for roll-inside 1 side
3 beams for roll-inside 2 sides

Electric box



x1

Key switch



x1

Wi-key

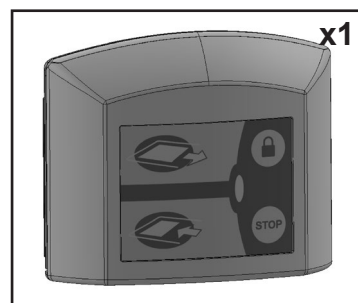

x1

or

Decking

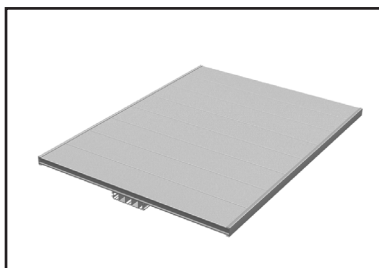

Slats

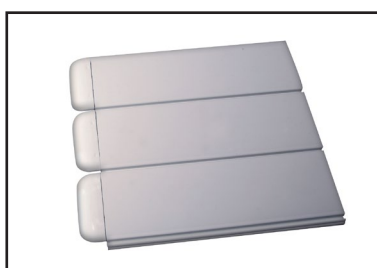

Fastening kits

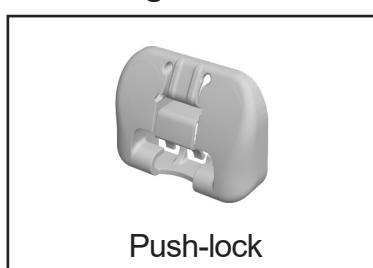

Push-lock

PACKING LIST

e.g. for a 5 x 10 m pool with Ø3 m roman steps

Wall units:

For beam support: 1 box of 1 x 0.20 x 0.20 m -- 10 kg

For the mechanism (tube): 1 box of 0.30 x 0.20 x 0.20 -- 5kg

The mechanism (tube) with the gear motor:

1 pack containing 5 x Ø0.25 m -- 50 Kg

The installation kit + control box + counter-weights + fastener kits:

1 pack containing 0.80 x 0.60 x 0.65 -- 45 kg

Beam support:

1 side : 1 box of 0.75 x 0.25 x 0.15 -- 4kg

2 sides : 1 box of 0.75 x 0.25 x 0.15 -- 10kg

The beams:

Roll-inside 1 side: 2 box of 5.1 x 0.17 x 0.12 -- 60 kg

Roll-inside 2 sides: 3 box of 5.1 x 0.17 x 0.12 -- 90kg

Decking :

Roll-inside 1 side: 1 pallet of 1.20 x 1 x 0.40 -- 40kg

Roll-inside 2 sides: 1 pallet of 1.20 x 1 x 0.40 -- 70 kg

Slats :

5 box of 5.1 x 0.20 x 0.25 -- 250 kg

Total weight :

Roll-inside 1 side: 454 kg

Roll-inside 2 sides: 520 kg



Roll-inside - insert mounting - motorisation in a dry pit

INSTALLATION OF THE INSERTED PARTS

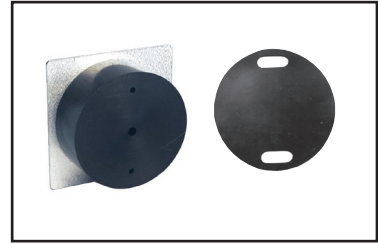
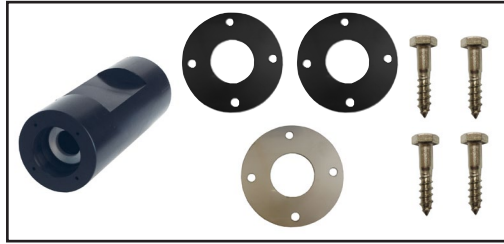
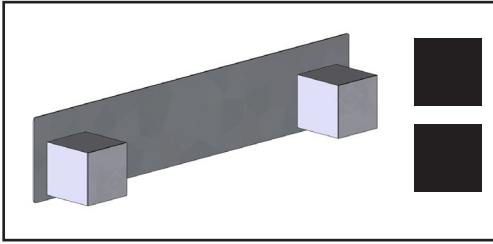

positioning



L (m)	11	12	13	14	15	16	17	18	19	20
*B (cm)	45	46	47	48	48.5	49	50	51	52	53
*C (cm) mini	76	78	80	81	83	85	87	88	90	91

1 side

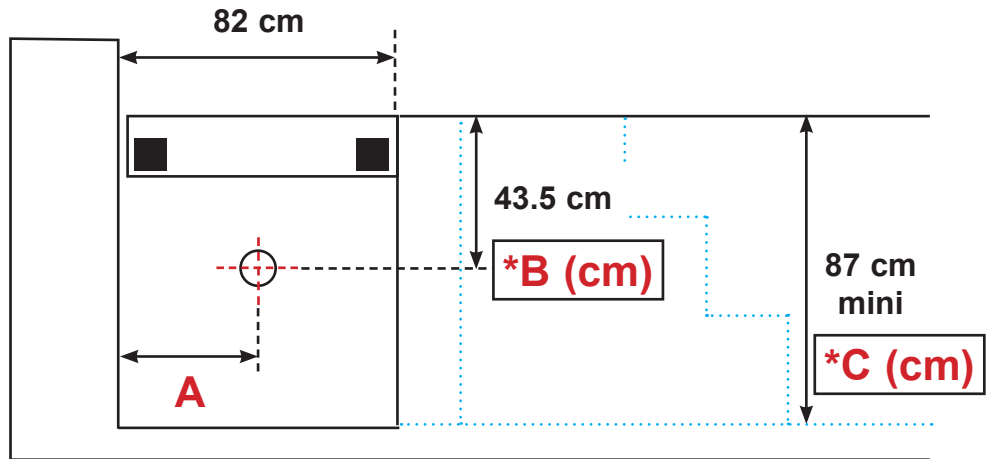
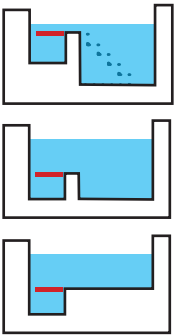

2 sides

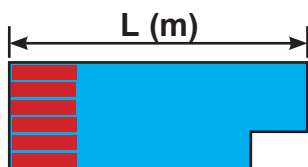
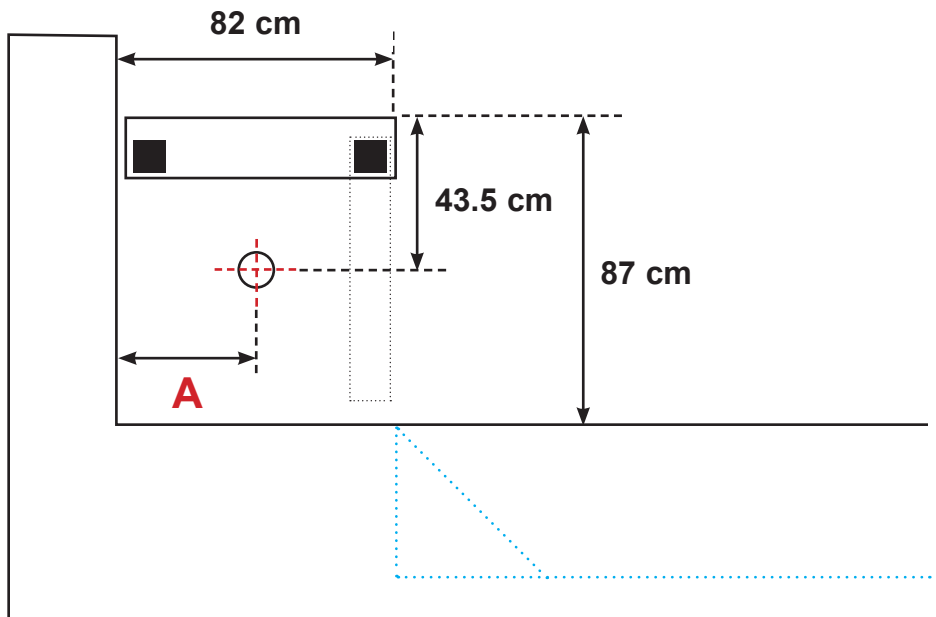
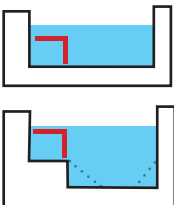

L	6	7	8	9	10	11	12	13	14	15	16	17	18	19	20
A (cm)	26	27	28	29	31	32	33	34	35	35	36	37	38	39	40

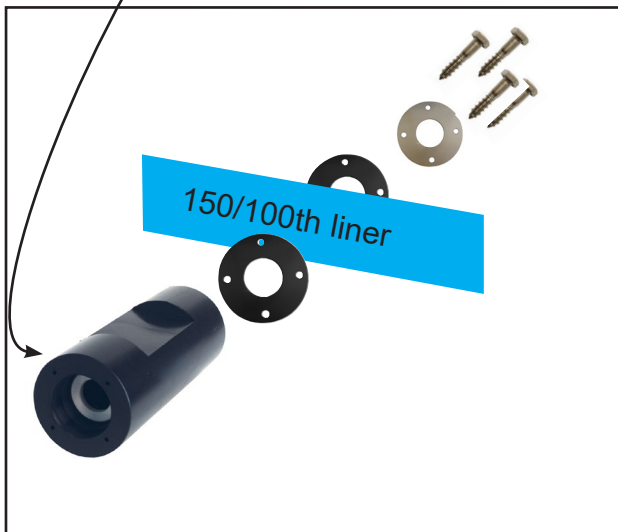
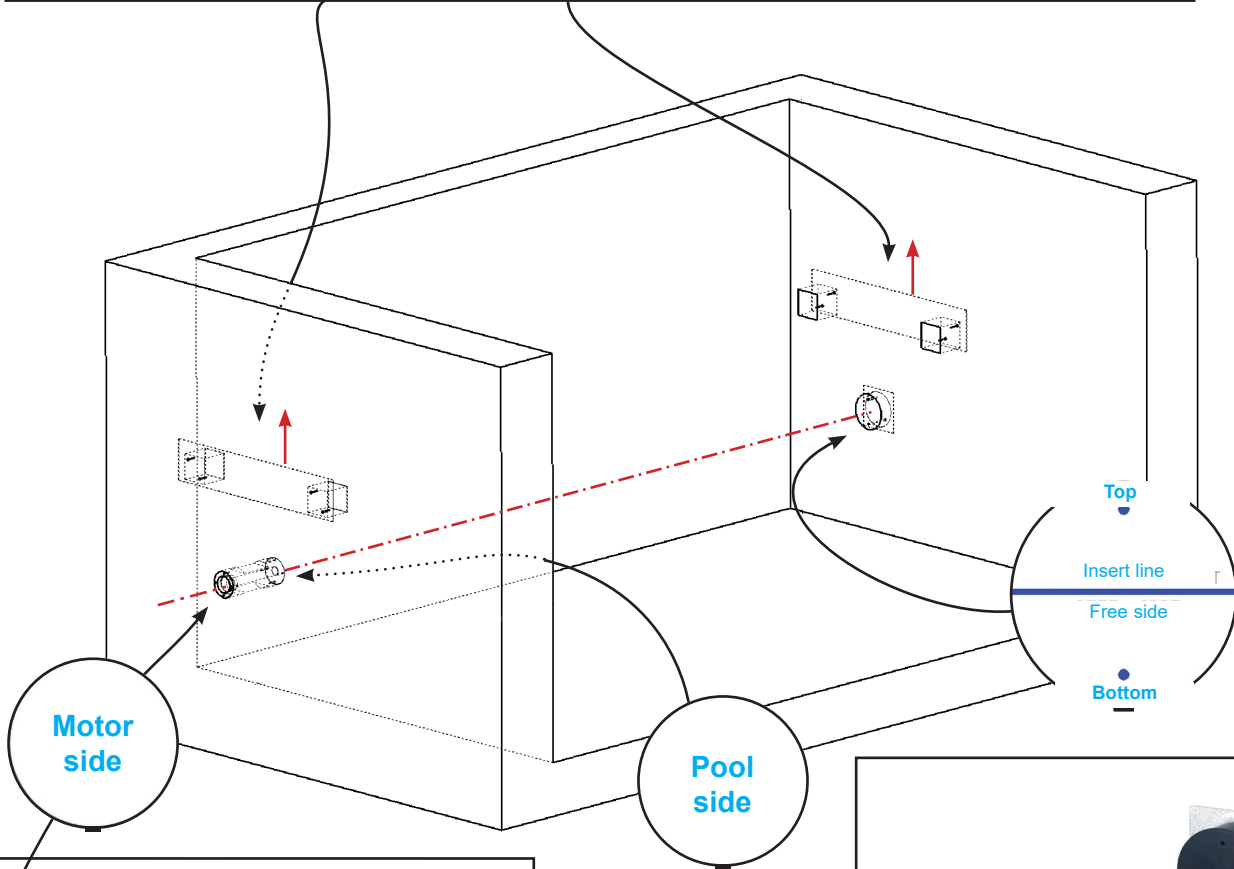
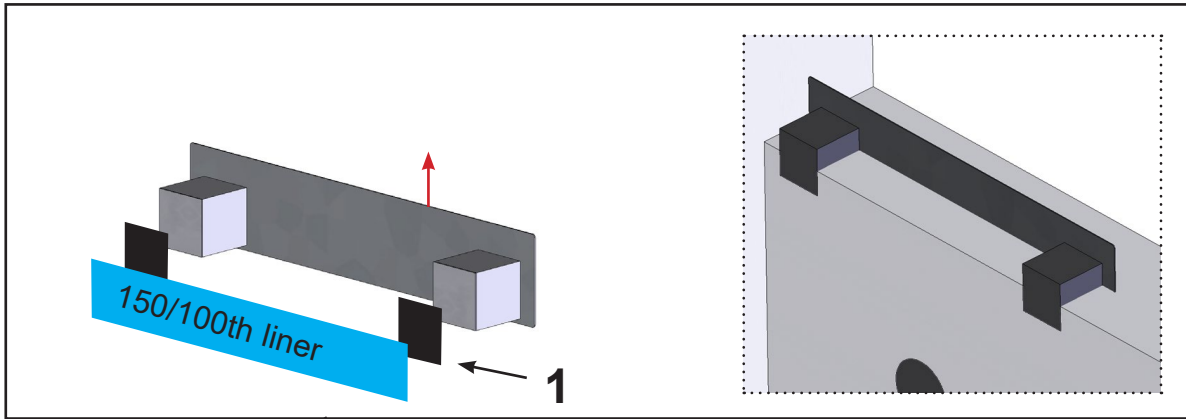

Roll-inside - insert mounting - motorisation in a dry pit

INSTALLATION OF THE INSERTED PARTS

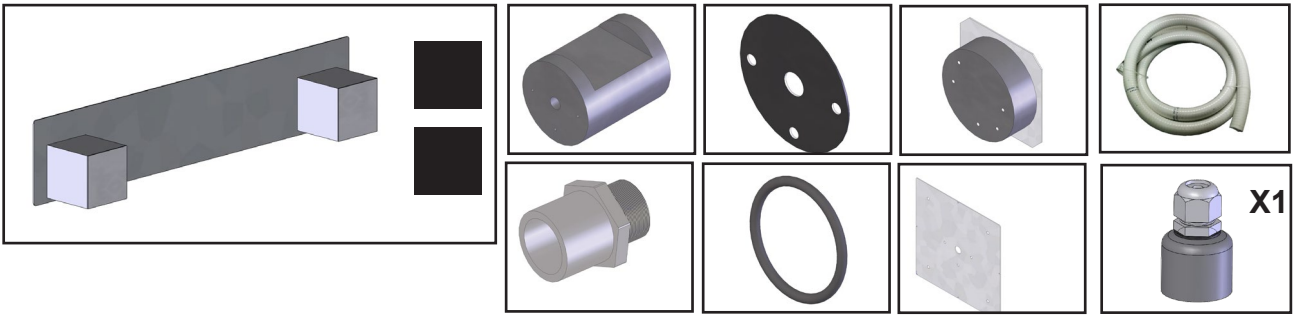

positioning

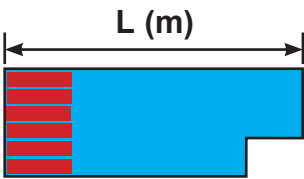

for pools of more than 7 m wide

L (m)	11	12	13	14	15	16	17	18	19	20
*B (cm)	45	46	47	48	48.5	49	50	51	52	53
*C (cm) mini	76	78	80	81	83	85	87	88	90	91

1 side

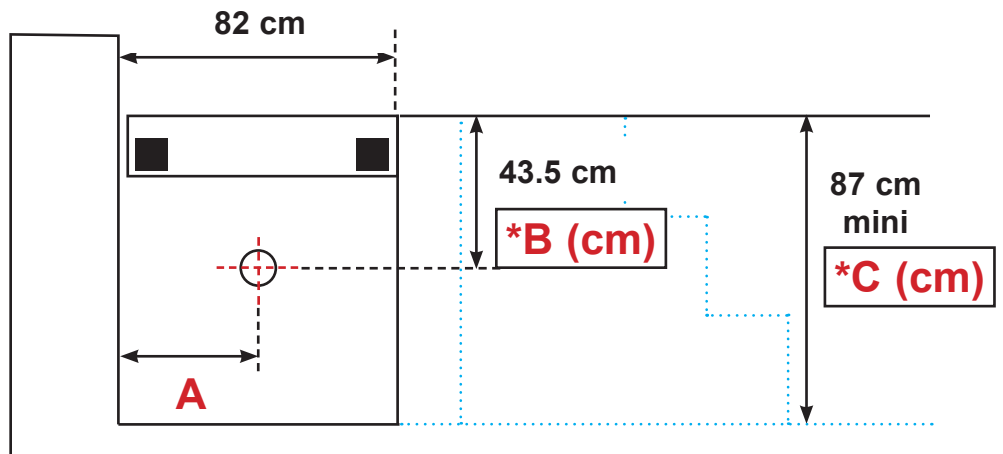
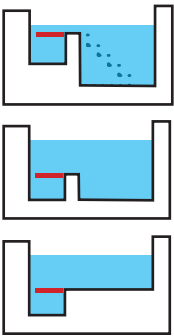

2 sides

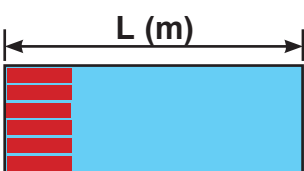
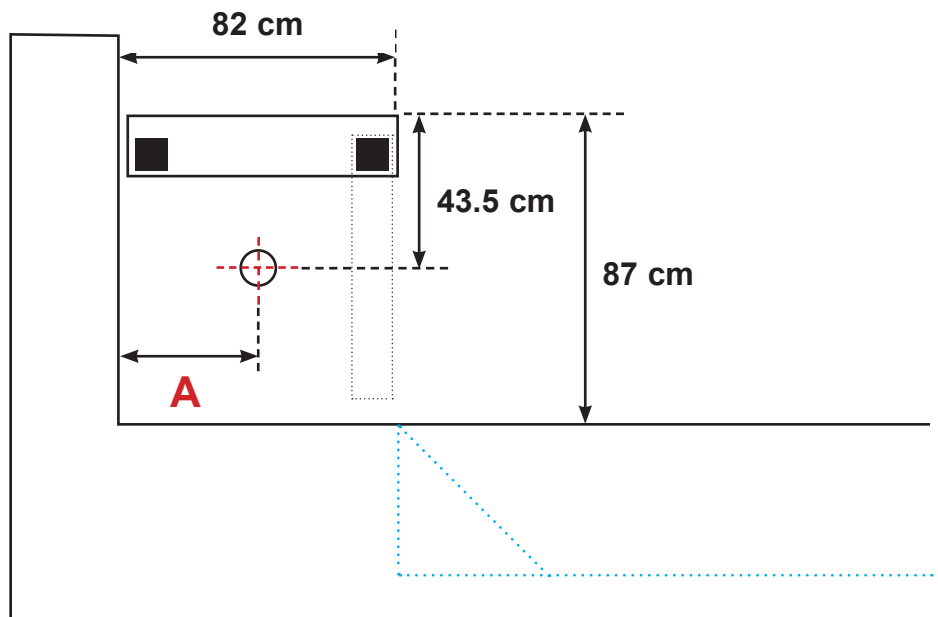
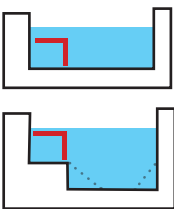

L	6	7	8	9	10	11	12	13	14	15	16	17	18	19	20
	26	27	28	29	31	32	33	34	35	35	36	37	38	39	40

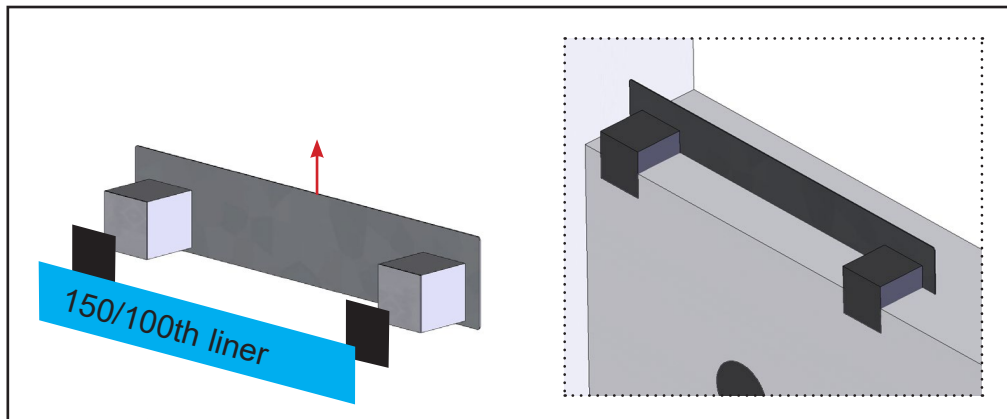

Connection box "Option"

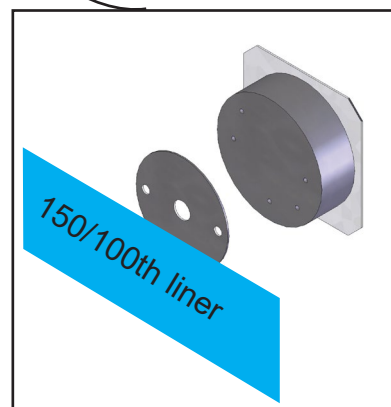
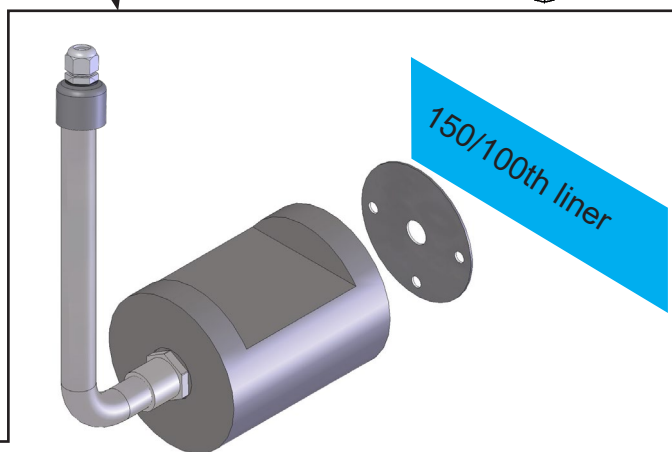
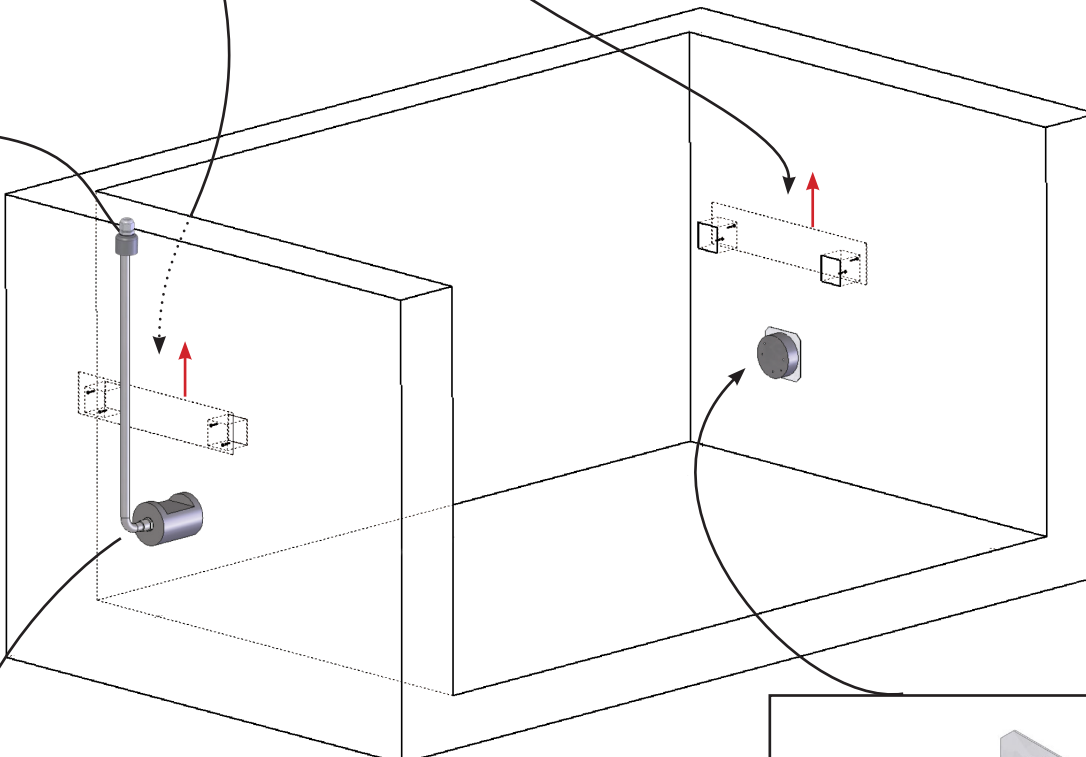

Box template

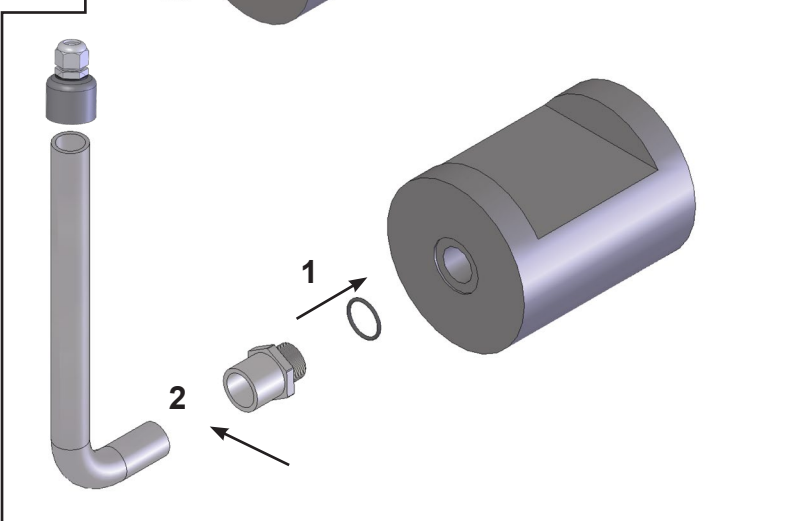
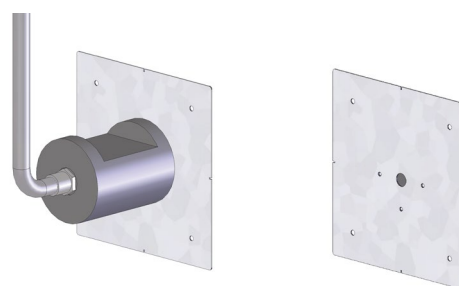

Roll-inside - surface mounted - tubular immersed motorisation

INSTALLATION OF THE INSERTED PARTS

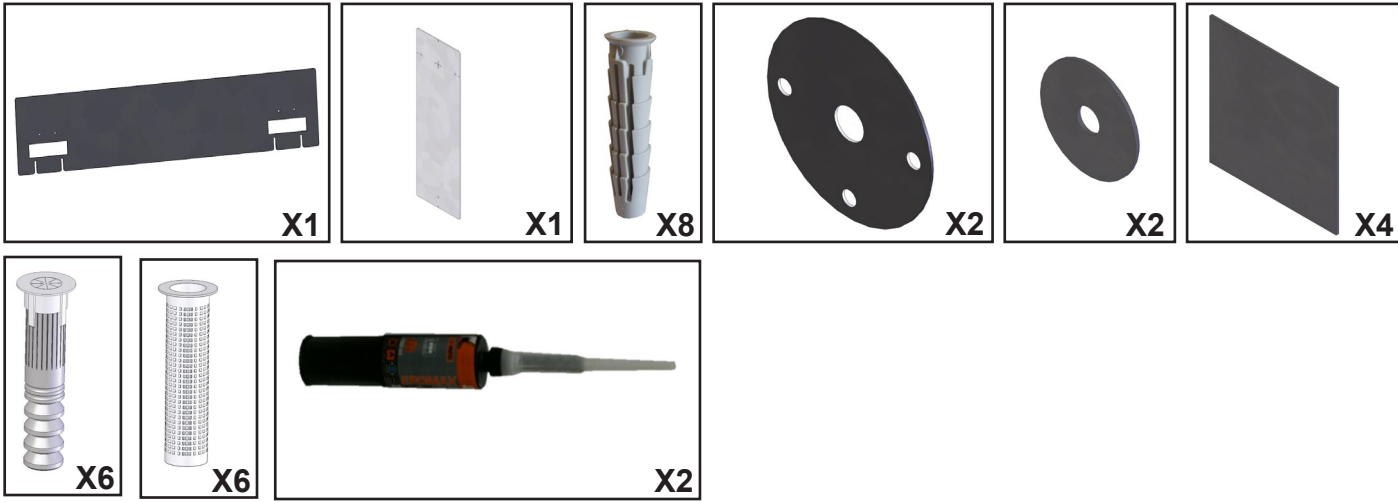

Positioning

1 side

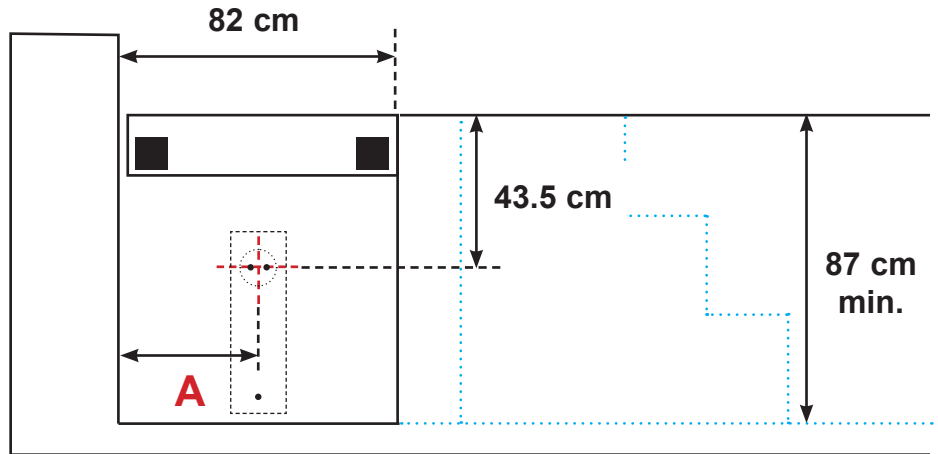
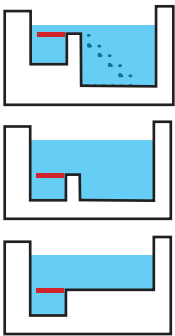

2 sides

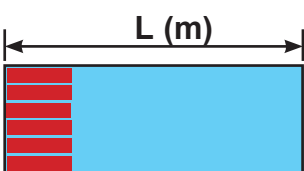
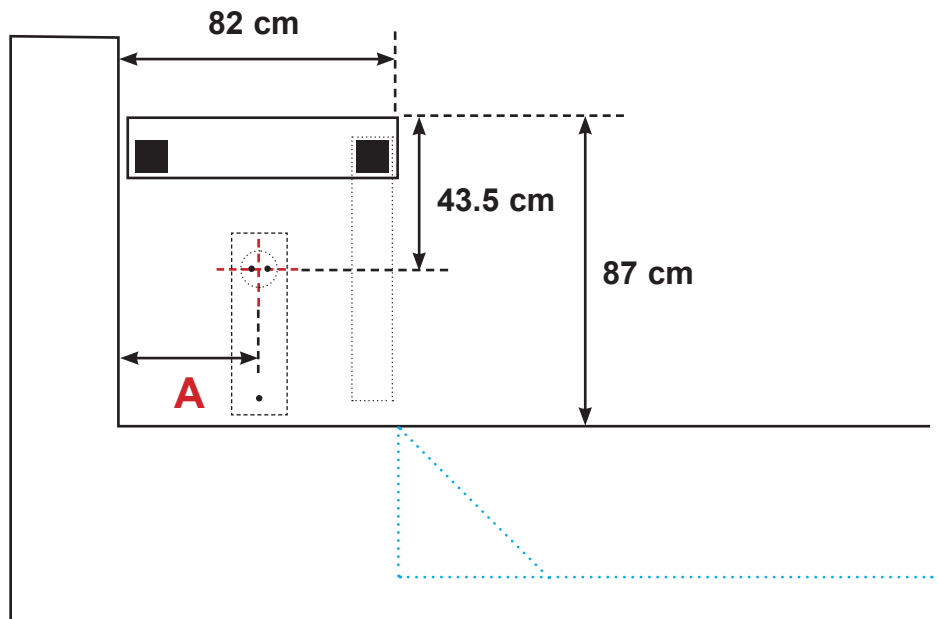
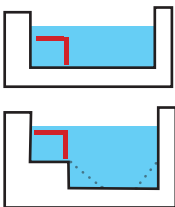

L	6	7	8	9	10	11	12	13	14	15	16	17	18	19	20
A (cm)	26	27	28	29	31	32	33	34	35	35	36	37	38	39	40

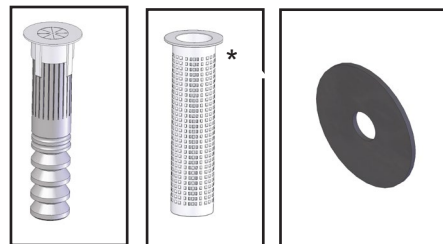
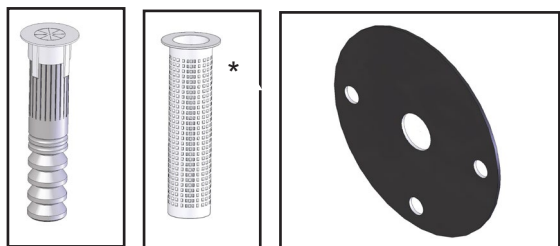
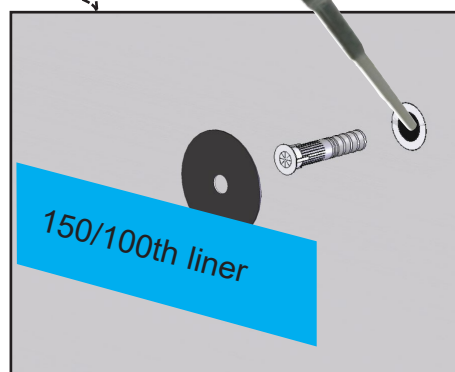
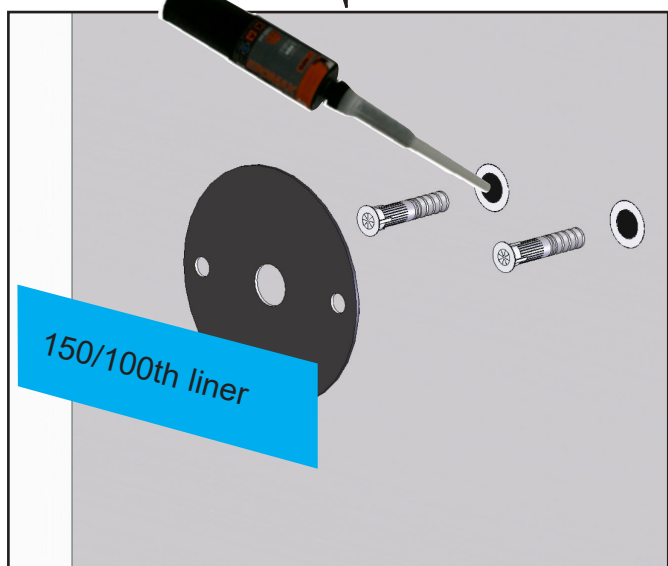
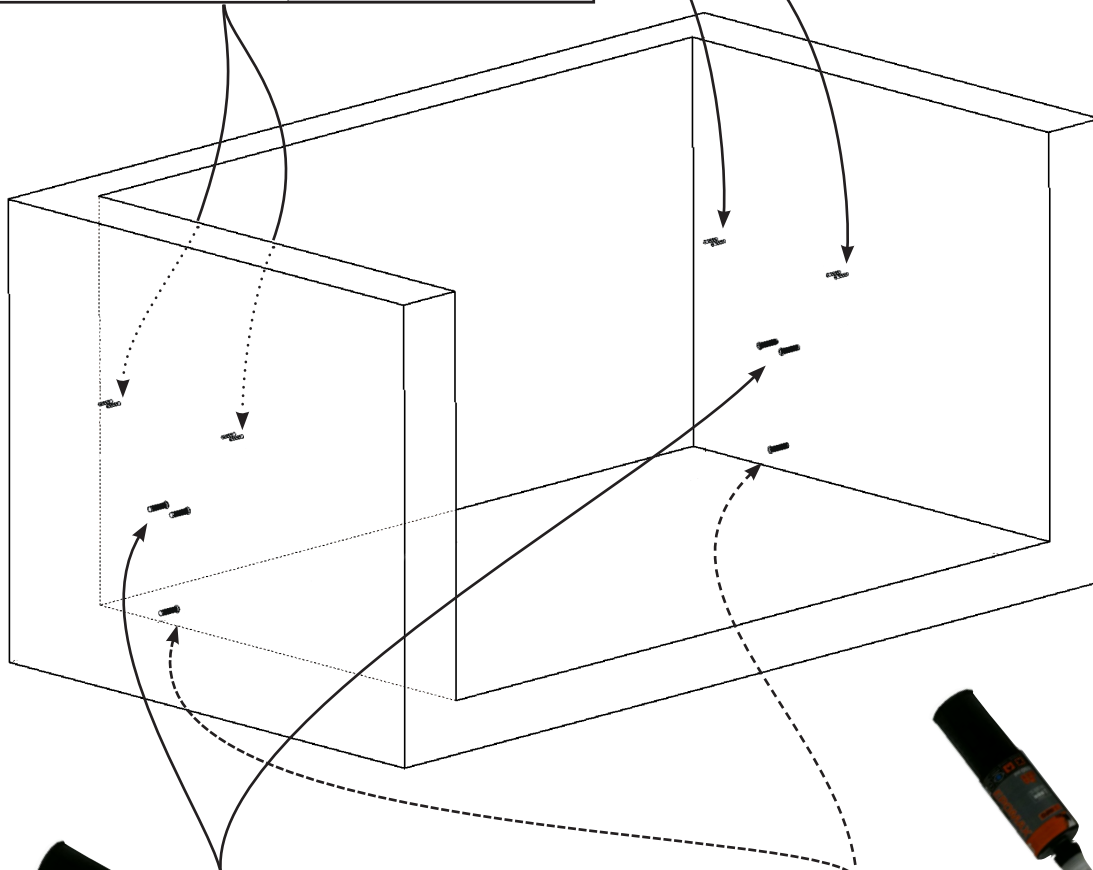
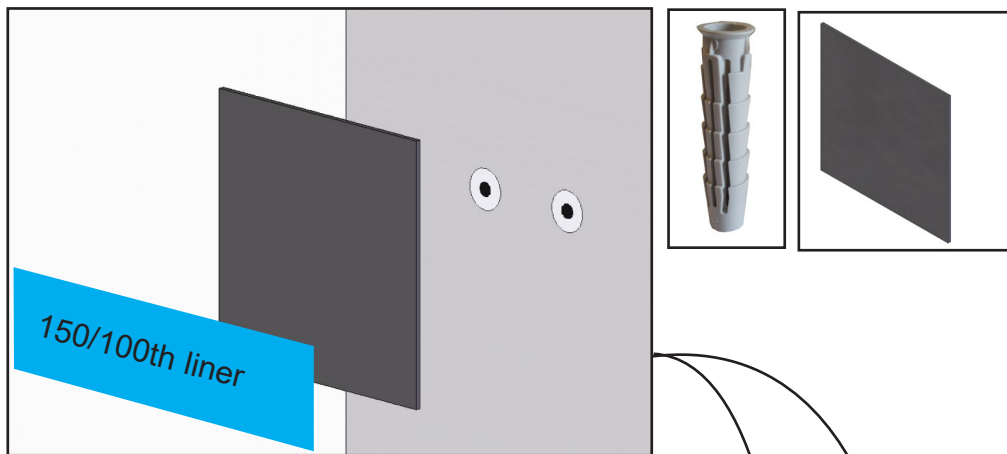

* Only for hollow sides

Roll-inside - for insert mounting - motorisation in a dry pit

INSTALLATION OF THE FLANGE MOTOR SIDE

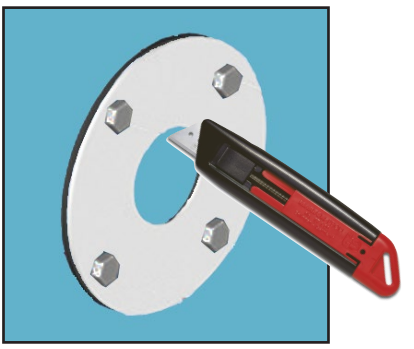
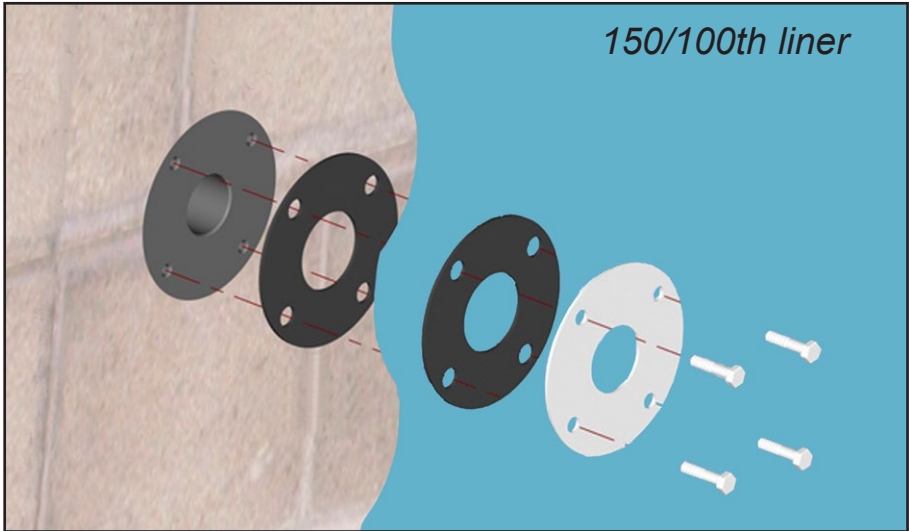
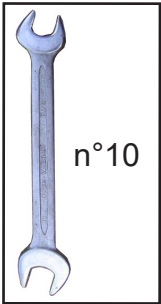
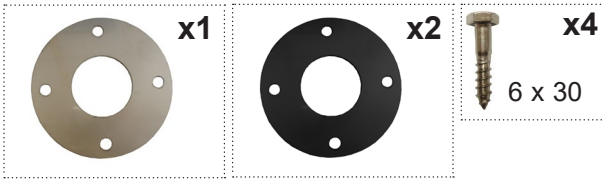

- Fill with water (approximately 20cm) before fixing the flange
- Cut the liner in the middle of the flange with a punch

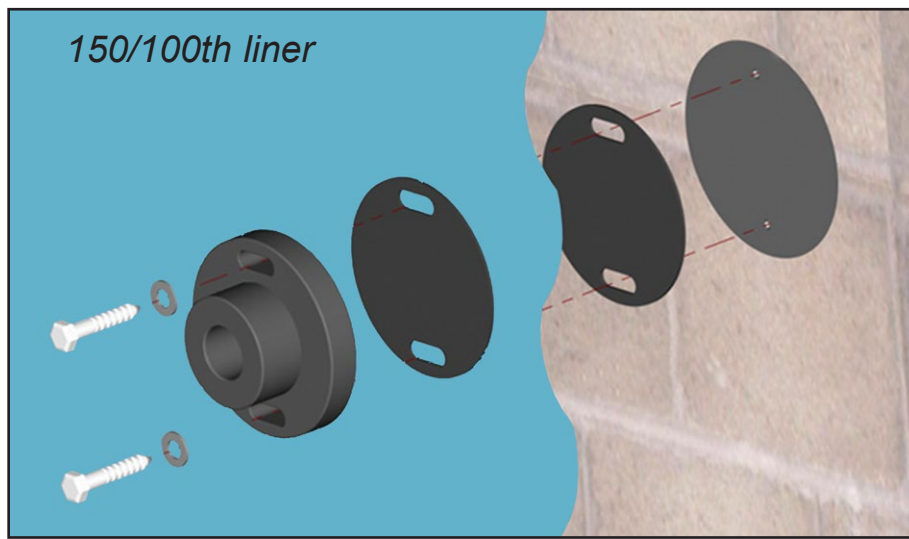
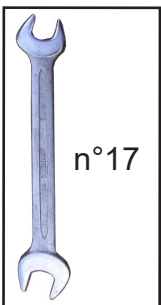
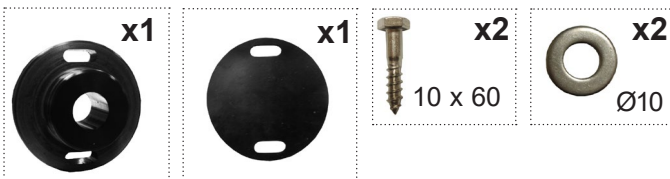

INSTALLATION OF THE BEARING ON THE FREE SIDE



- Fill with water (approximately 20cm) before fixing the bearing
- Cut the liner in the middle of the flange with a punch

INSTALLING THE MECHANISM

Reverse the tube on the motor side

 x1 6 sides male n°4	 x5 6x30	 x5 PVC Ø6
--	--	--

Bag

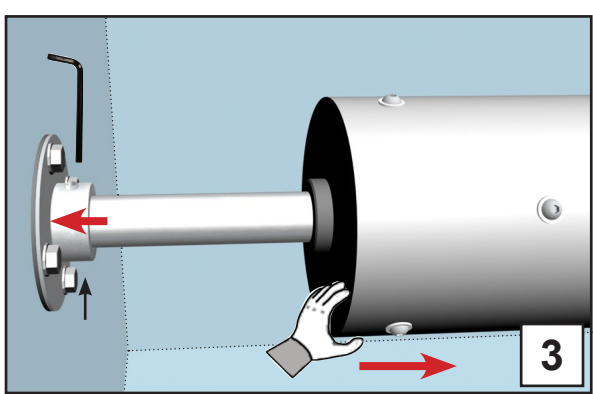
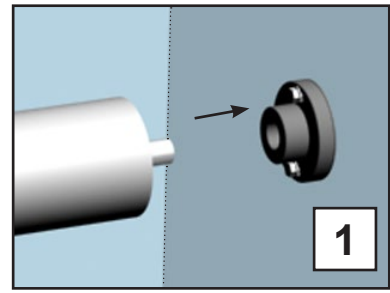
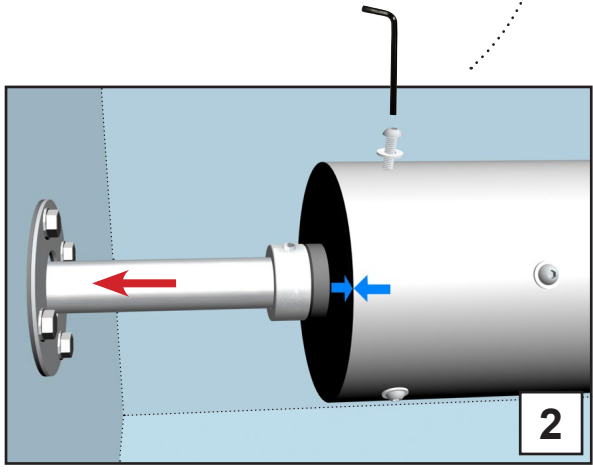
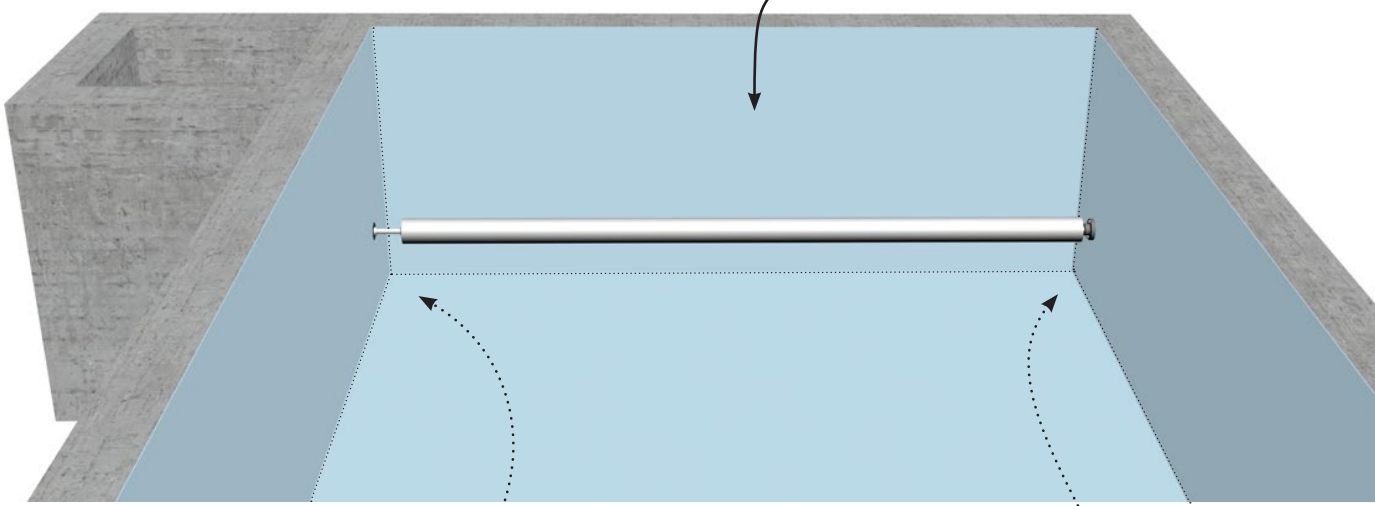
 x1

MAKING THE BOX WATERTIGHT ON THE MOTOR SIDE



GEAR MOTOR INSTALLATION

Turn the supports

MCA 120

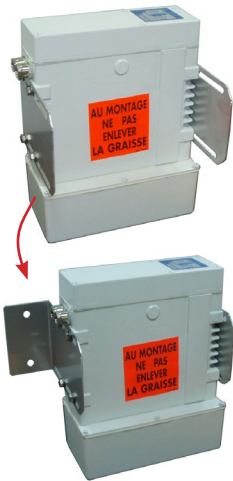

MCA 250

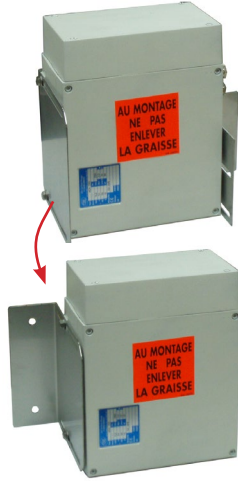

DL6010/7710



Install the gear motor on the tube

MCA 120

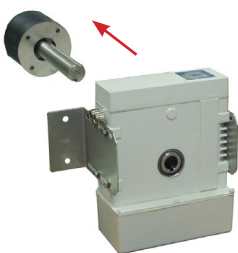

MCA 250



DL6010/7710

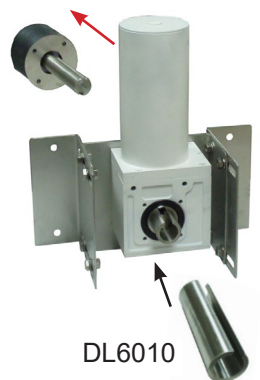

Fixture



MCA 120

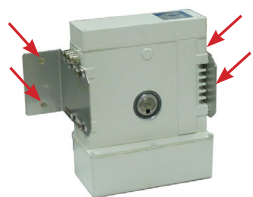

MCA 250

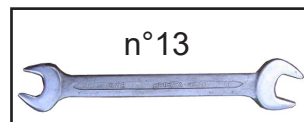

DL6010/7710

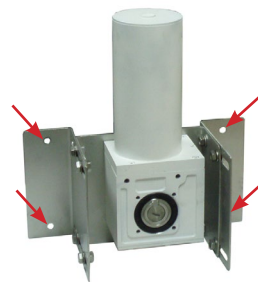

Fit the key

MCA 120



MCA 250



DL6010/*7710



Install the motor protection cap

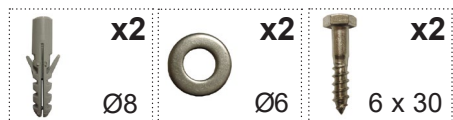

MCA 120



MCA 250

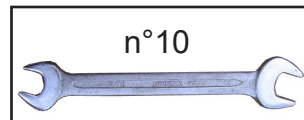

DL6010/7710

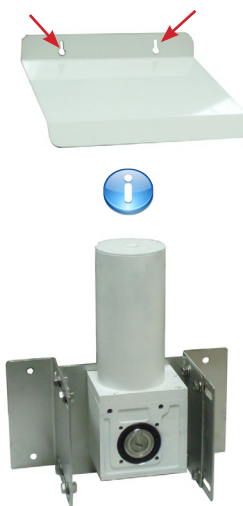

Option: 6 pin electric plug

Roll-inside - for insert mounting - tubular immersed motorisation

INSTALLING THE MECHANICAL FIXTURE

Motor side

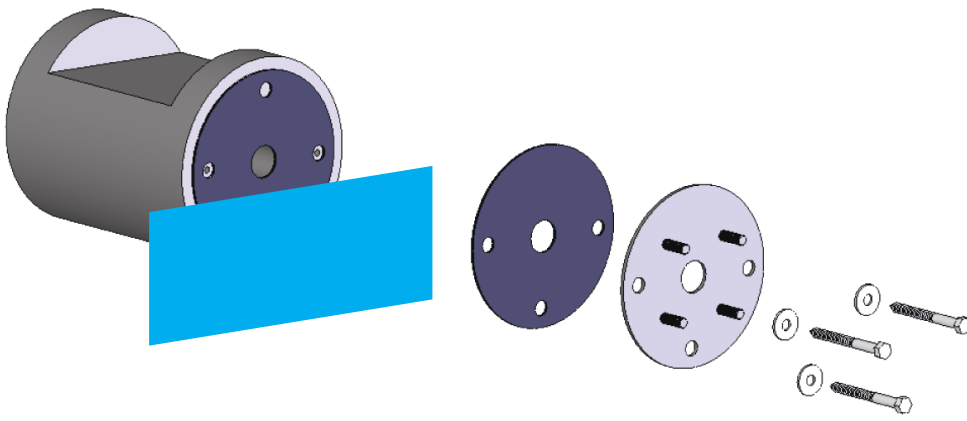
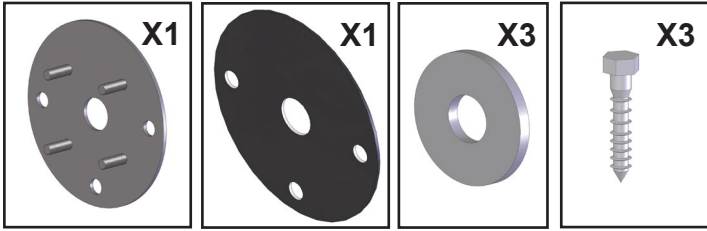

Free side

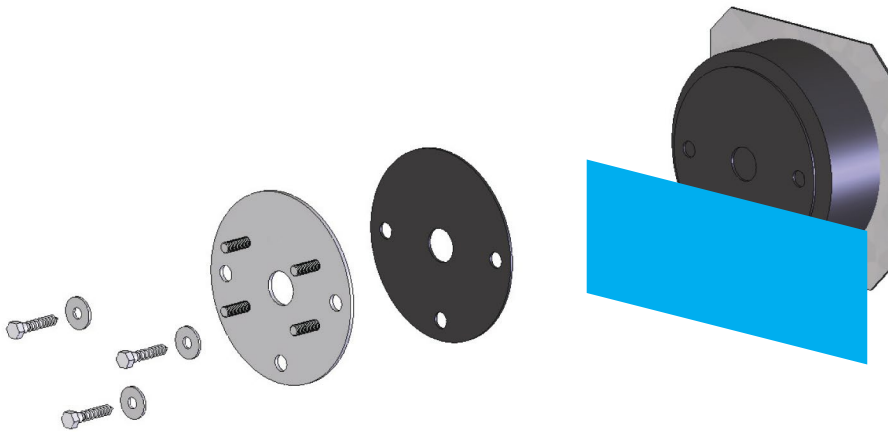
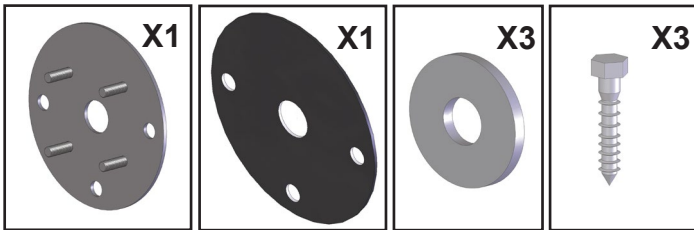

INSTALLING THE MECHANISM

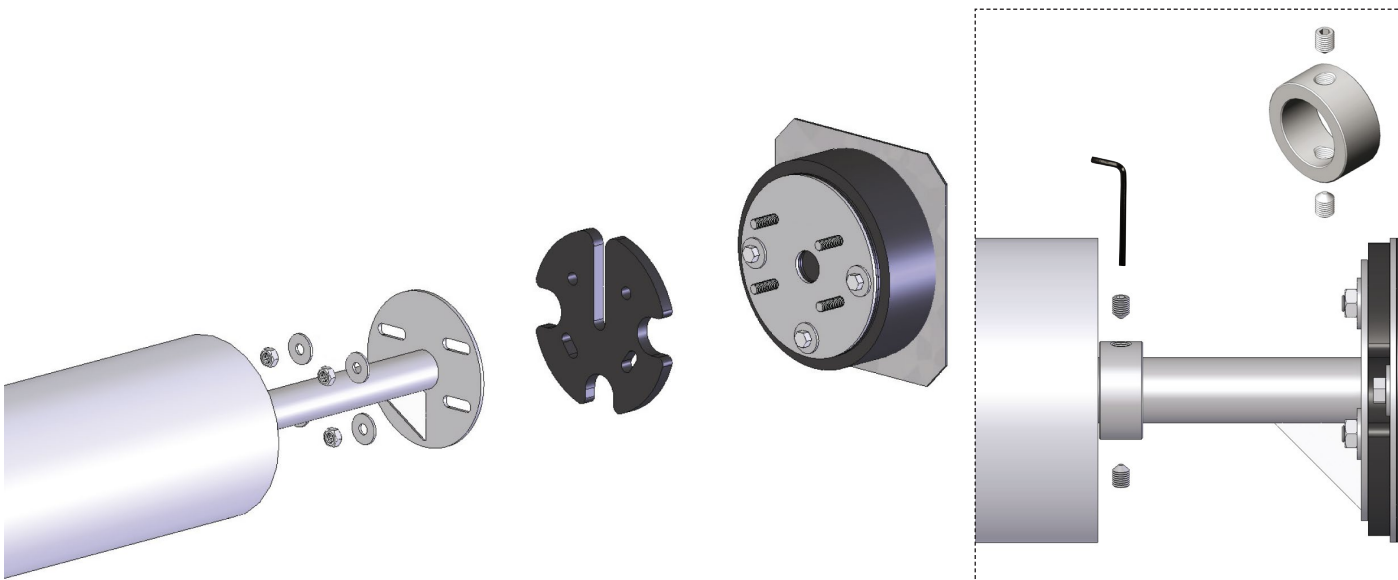
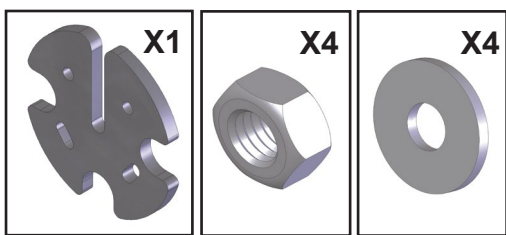
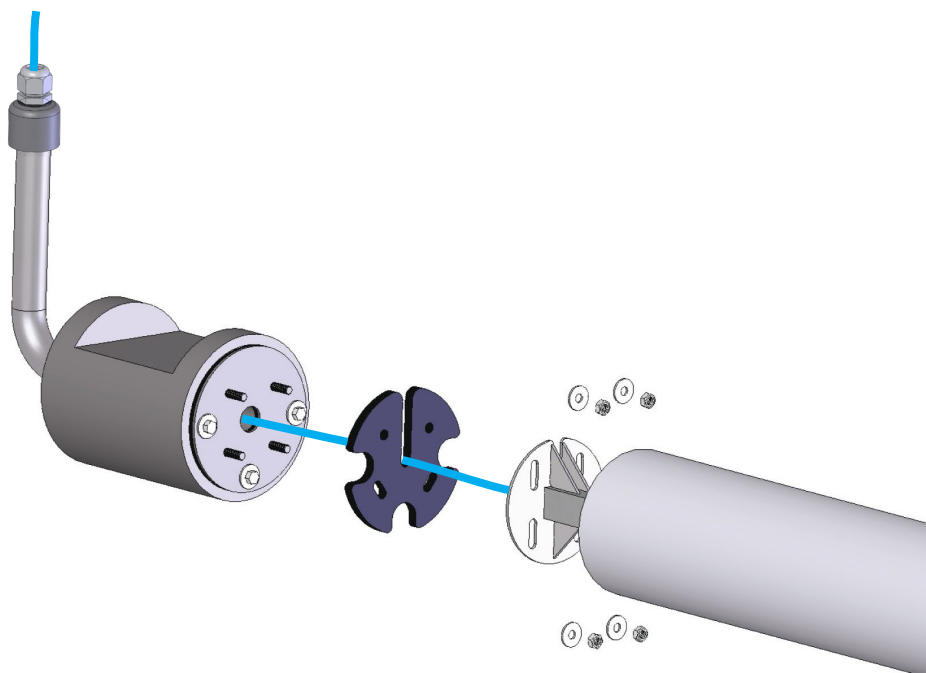
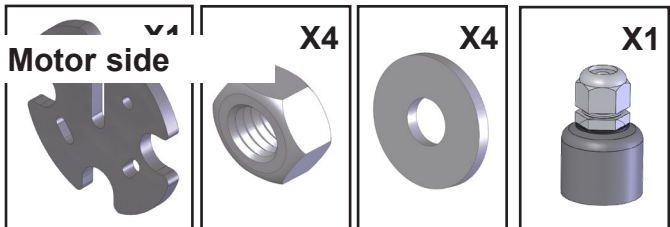
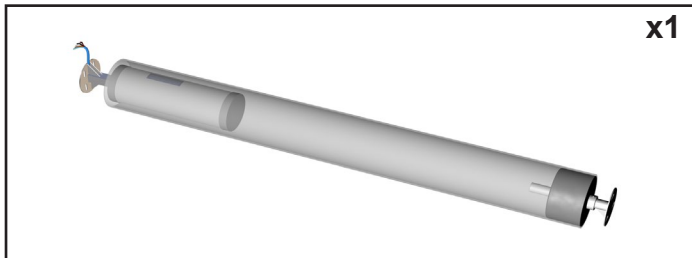

Roll-inside - surface mounted - tubular immersed motorisation

INSTALLING THE MECHANICAL FIXTURE

Motor side

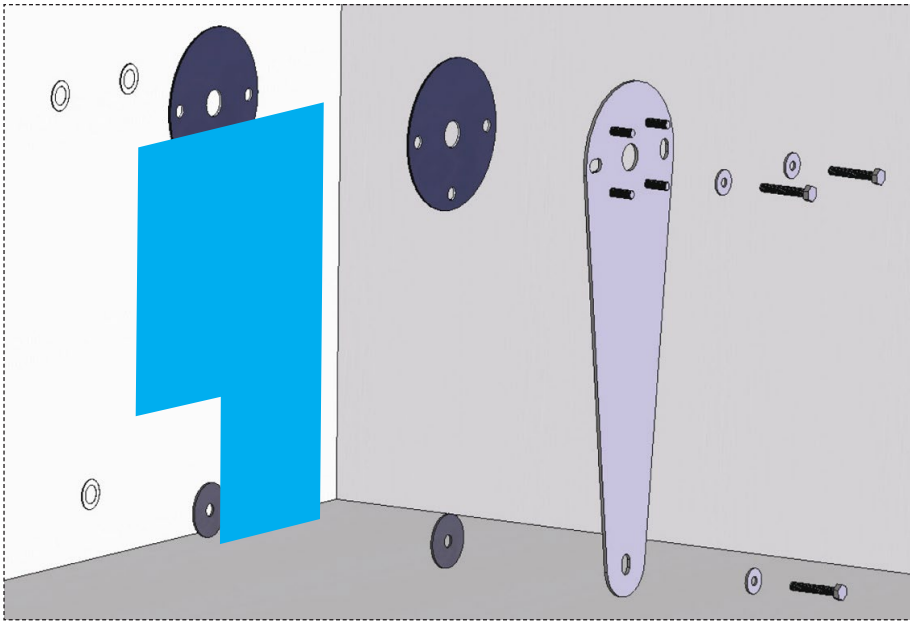
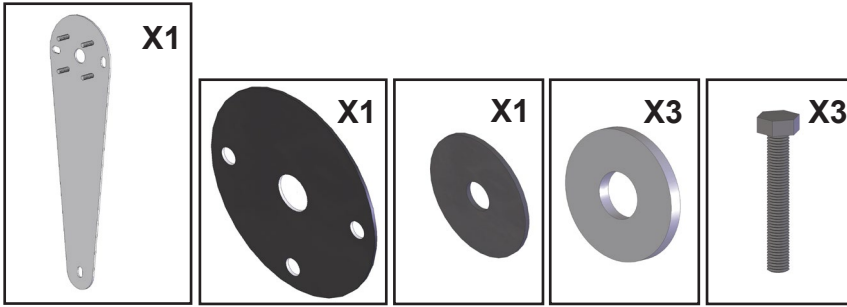

Free side

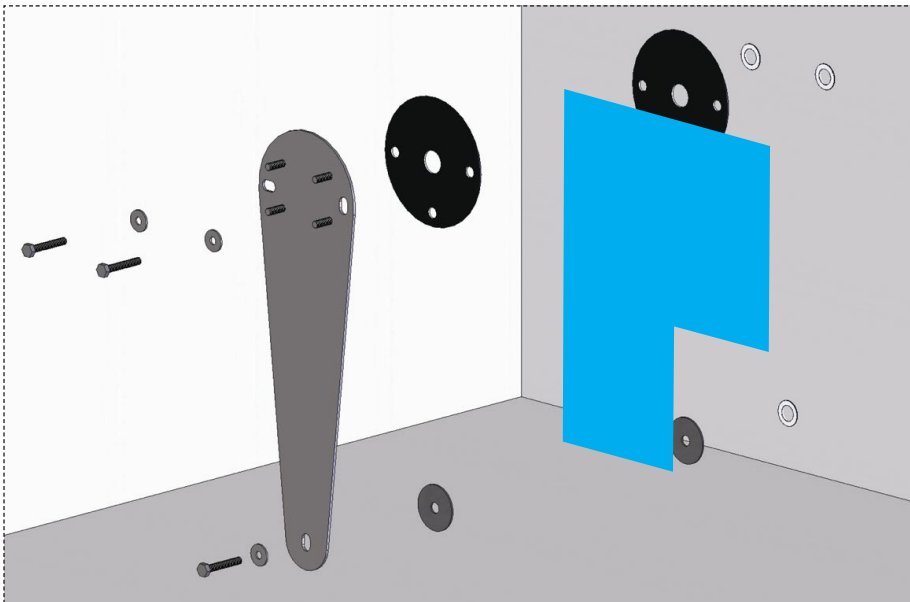
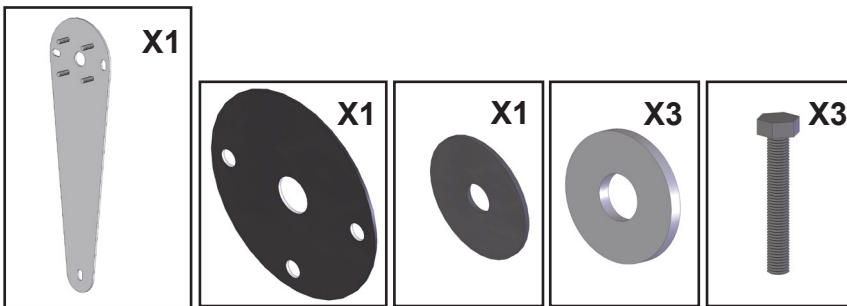

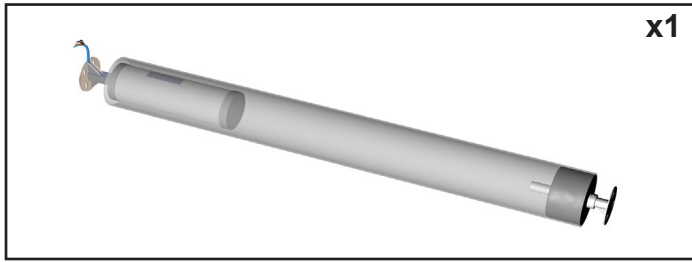

Motor side

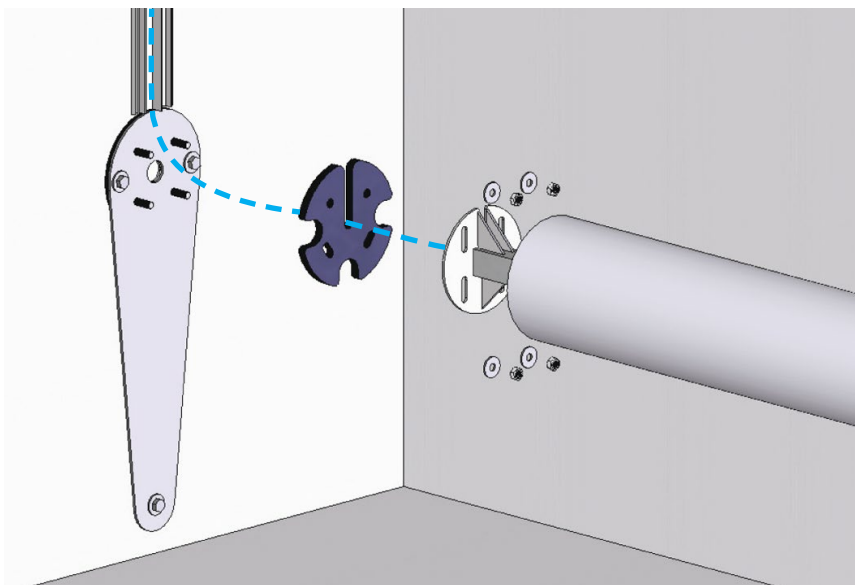
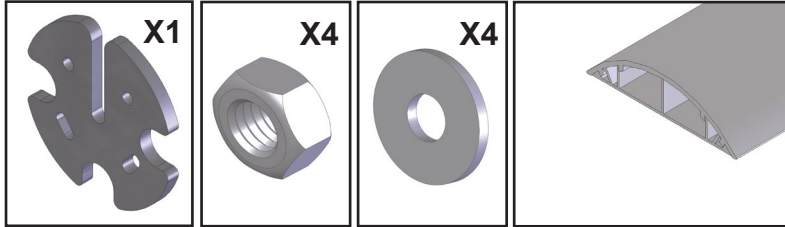

Free side

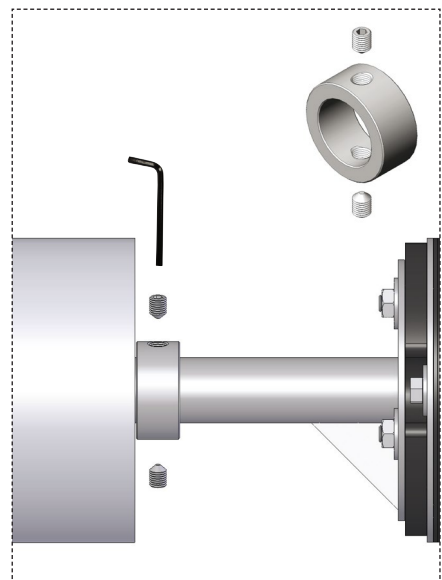
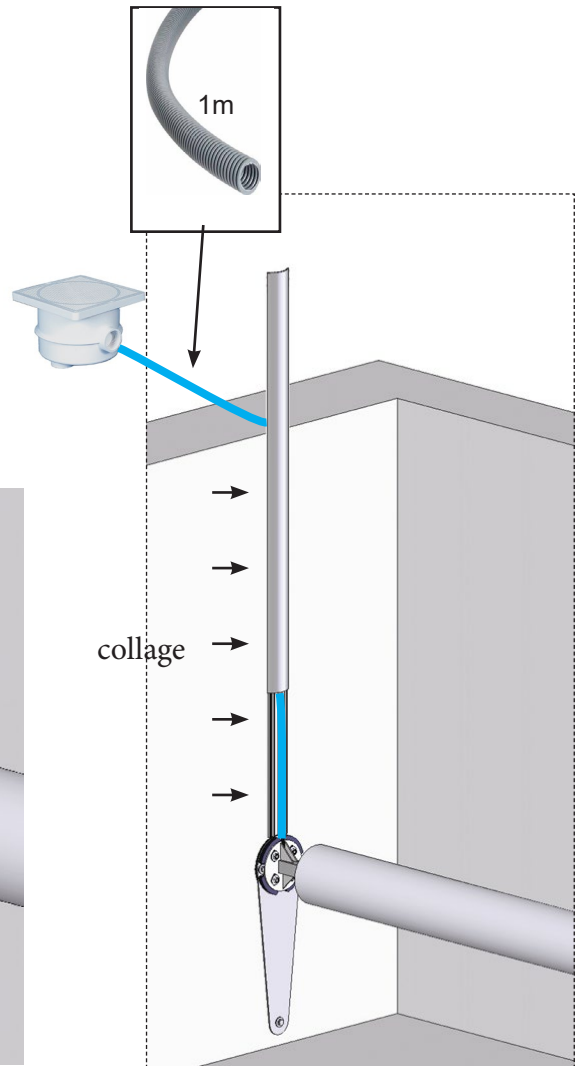
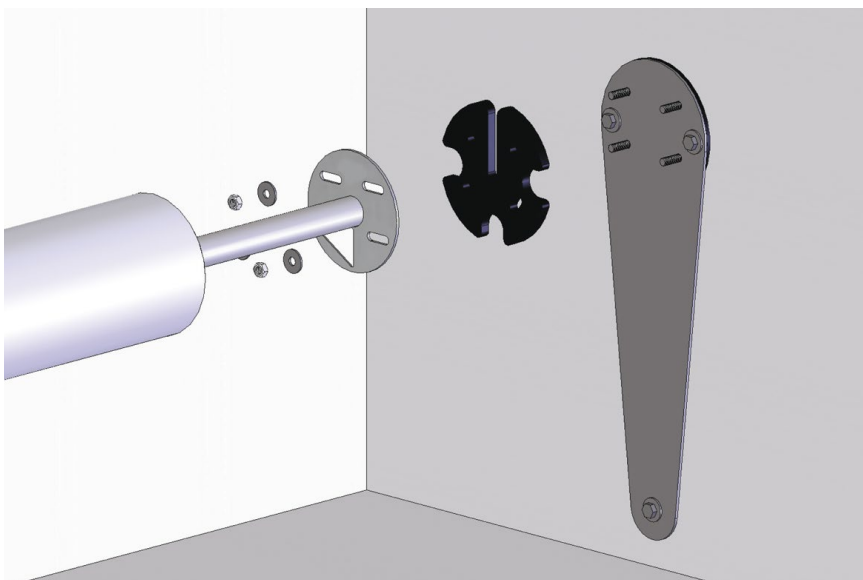
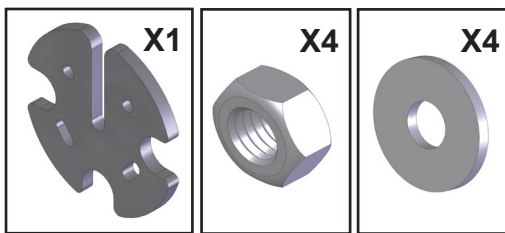

INSTALLING THE BEAM SUPPORTS

Tracing

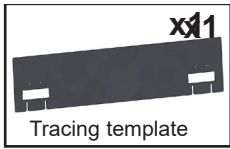

For the surface mounted version, the template can help to find the position of the previously installed anchor plugs.

Roll-inside 1 side

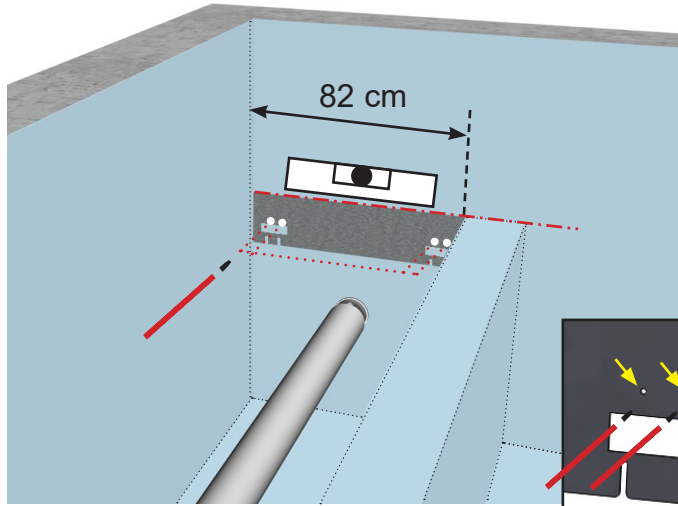

Roll-inside 2 sides

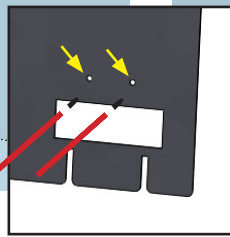
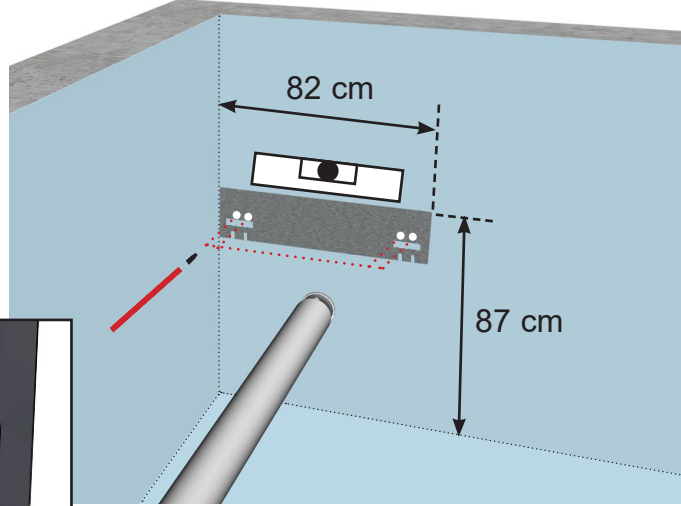

Fixture

Roll-inside 1 side

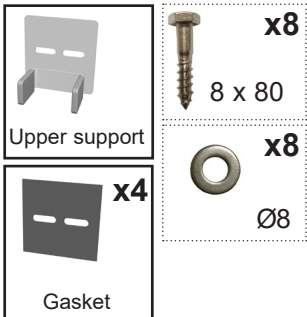

Roll-inside 2 sides

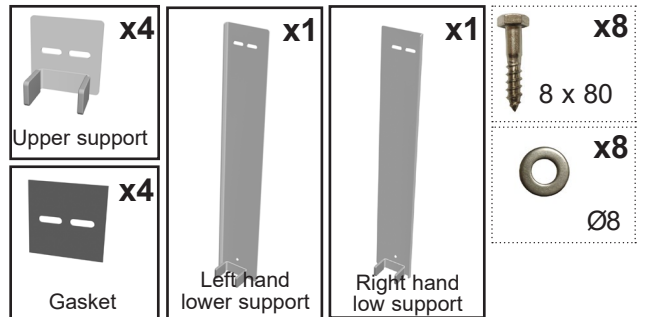

Fill the anchor plug with

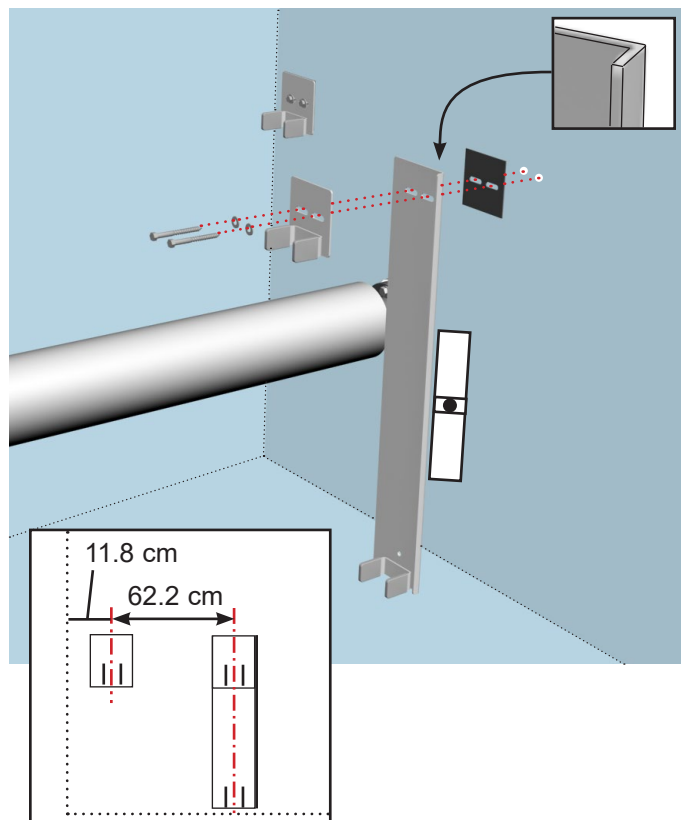
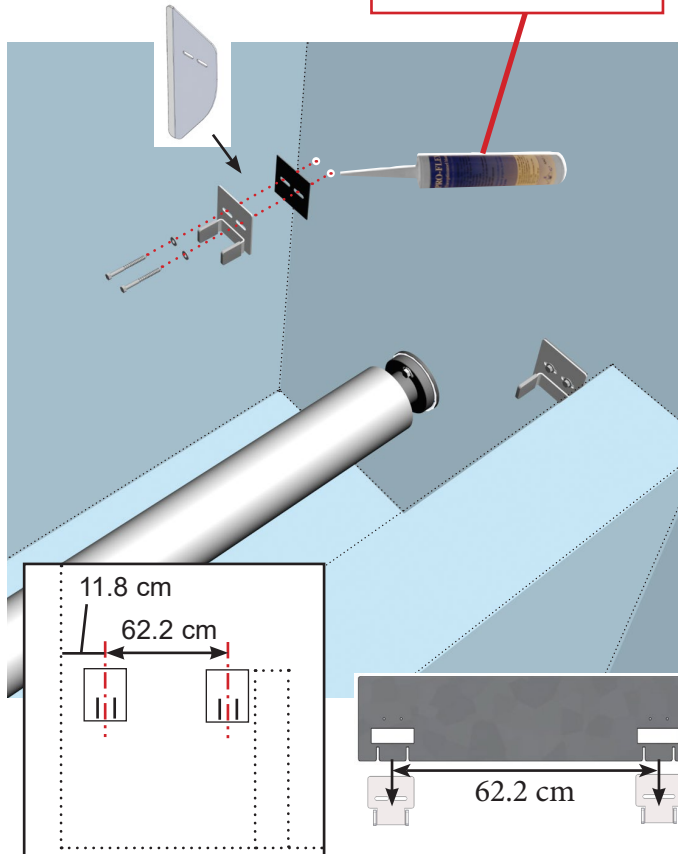

BEAM INSTALLATION

Roll-inside 1 side

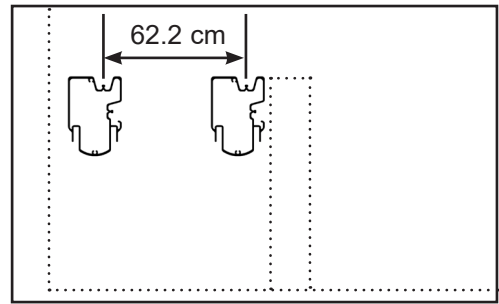
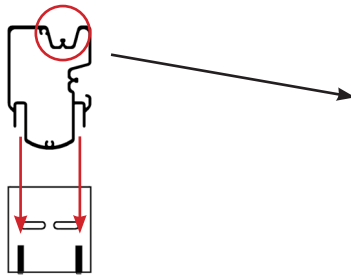
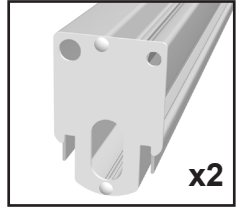

Roll-inside 2 sides

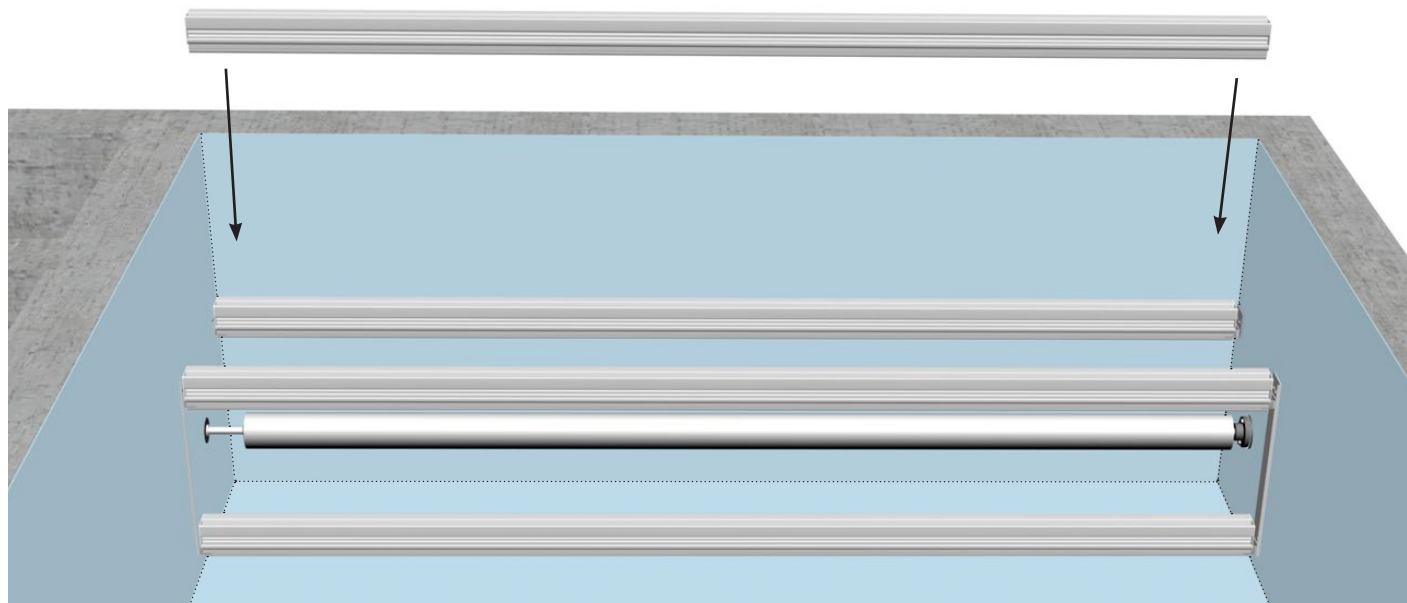
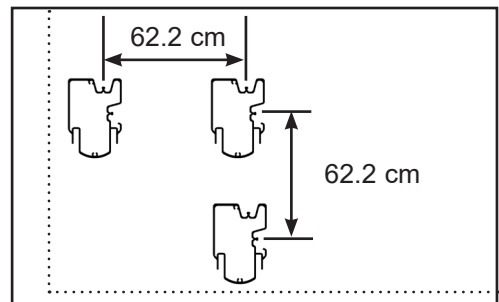
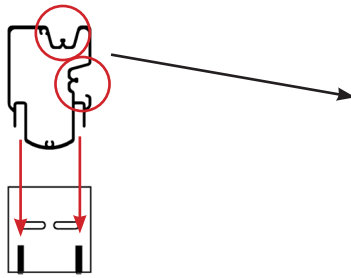
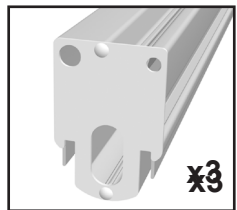

INSTALLING THE COUNTER WEIGHTS



Installation

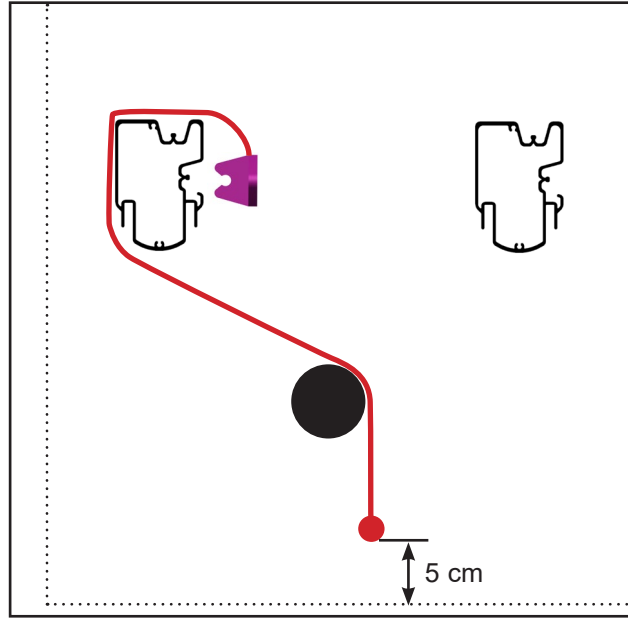
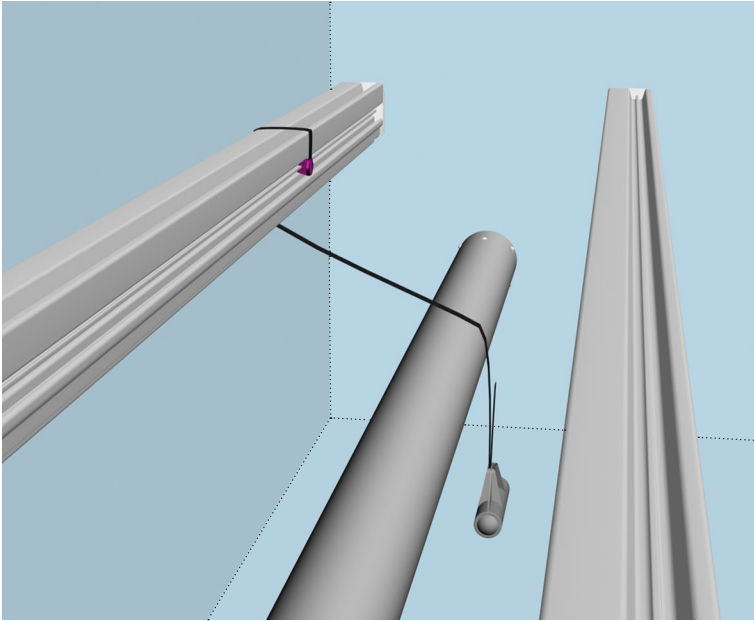

Strap adjustment

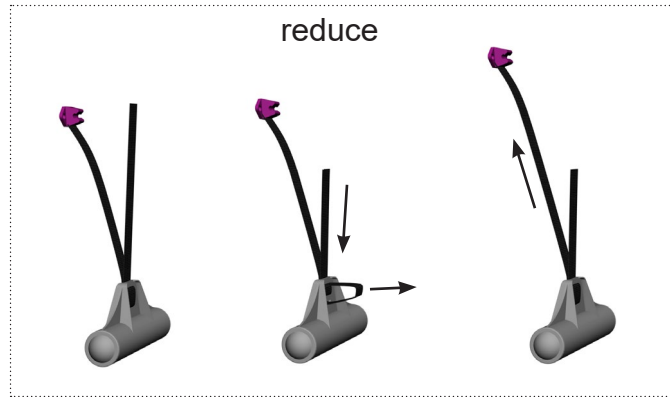
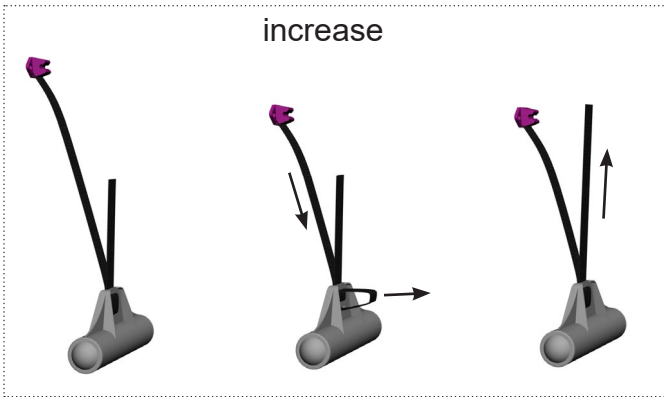

Counter-weight distribution

Pools without steps

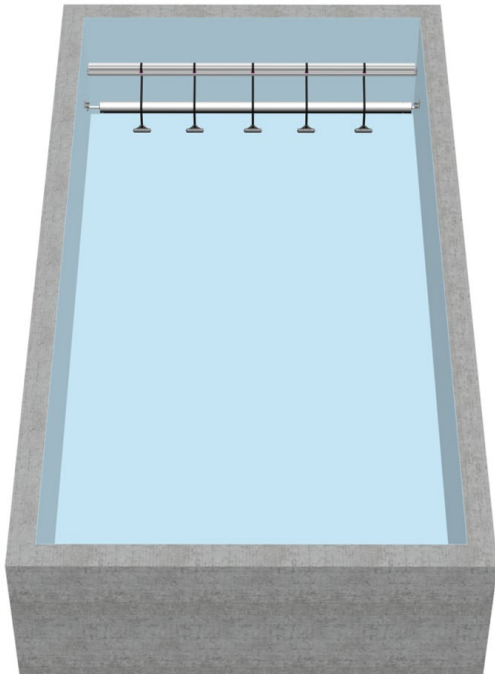

Pools with steps

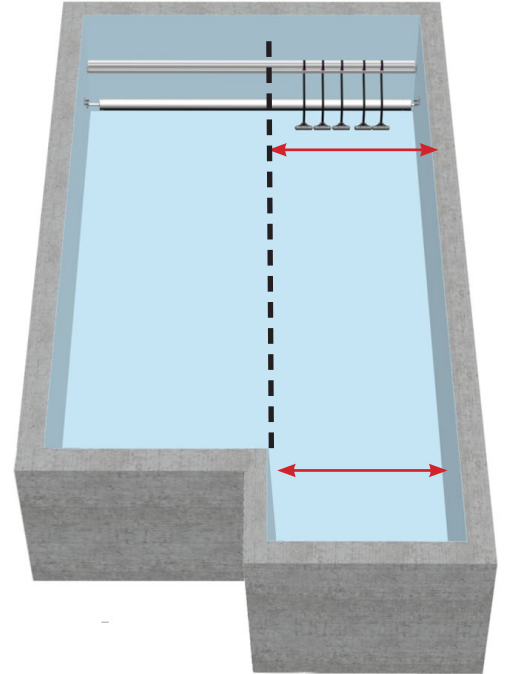

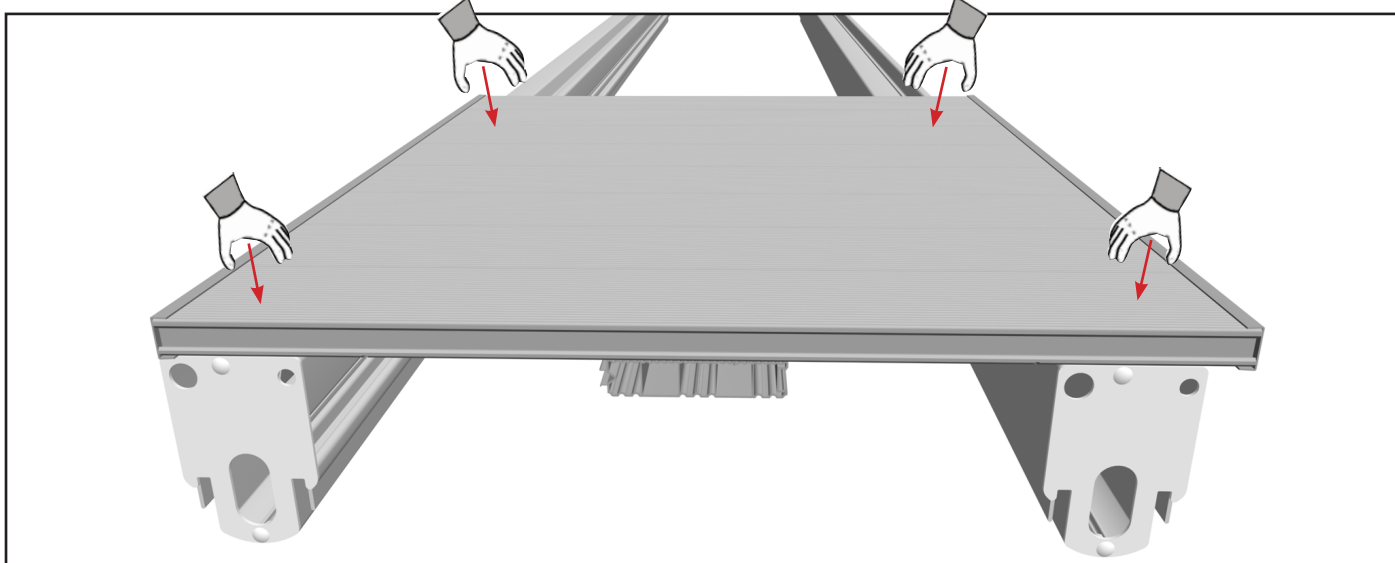
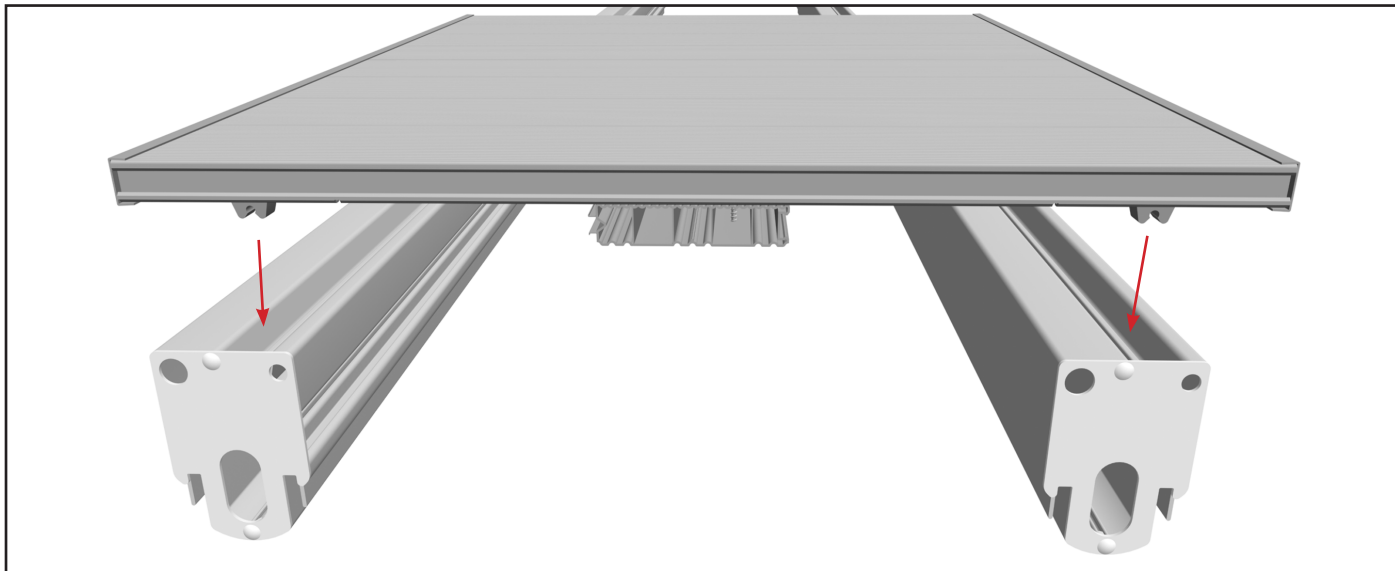

Roll-inside 1 side

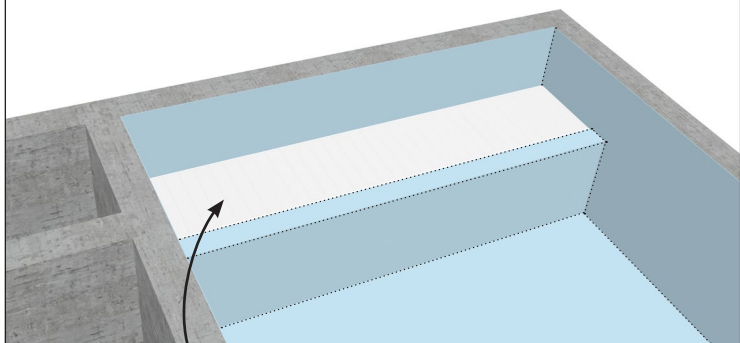

Install horizontal decking after adjusting the automatic stops on the cover

Roll-inside 2 sides

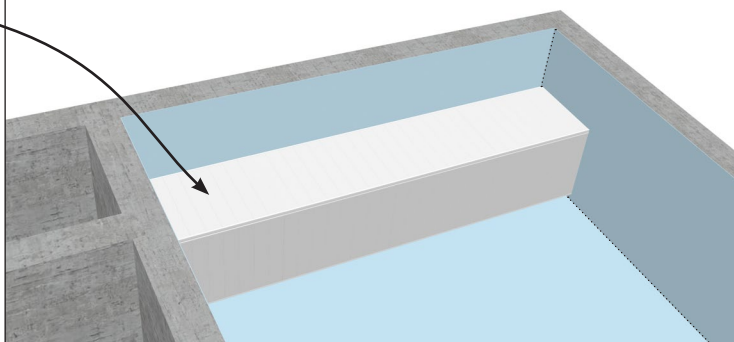

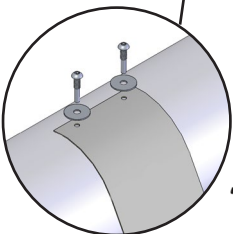
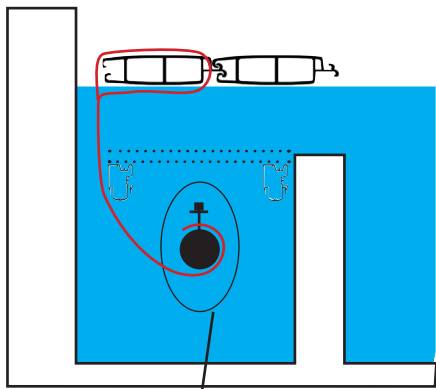

Allen Key mâle n°4

Box stickered «Début de volet»

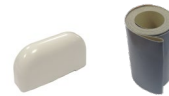

Install the slats on the water and clip them together. Take care with the direction of the cover over the pool

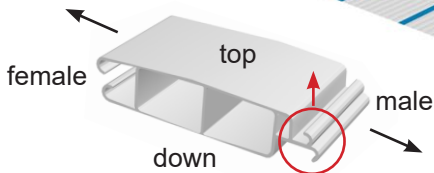
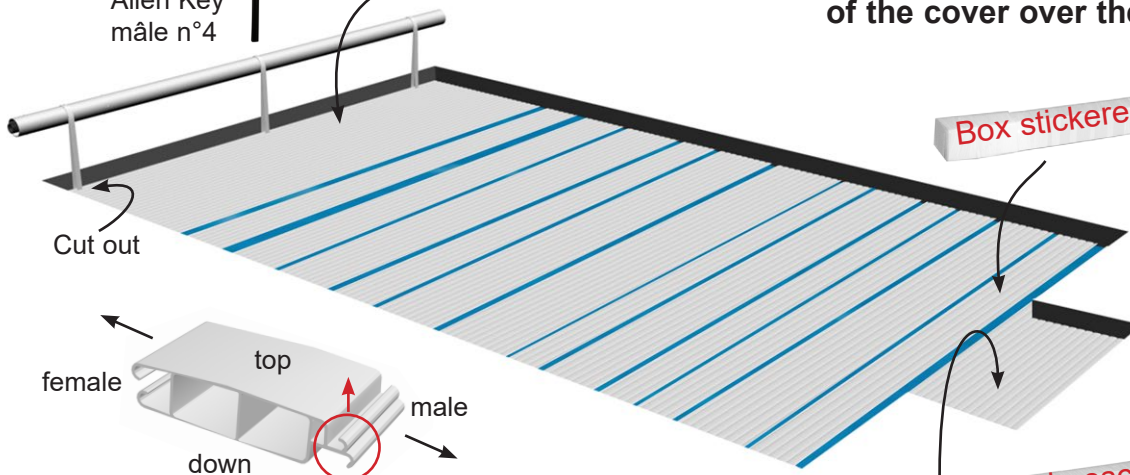

Box stickered «escalier»



Fit the slats along the whole length

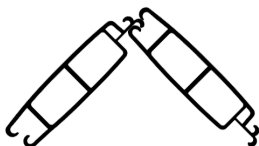
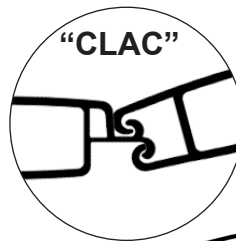

Repeated wiggling/handling of the slats may be needed..

HOW TO TAKE OFF A SLAT AND END CAPS ?

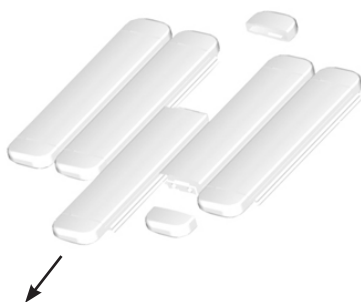
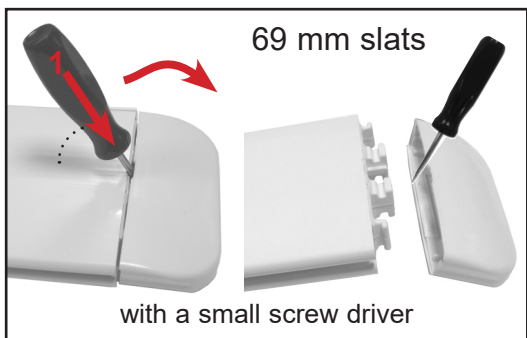

INTRODUCTION OF THE ROD

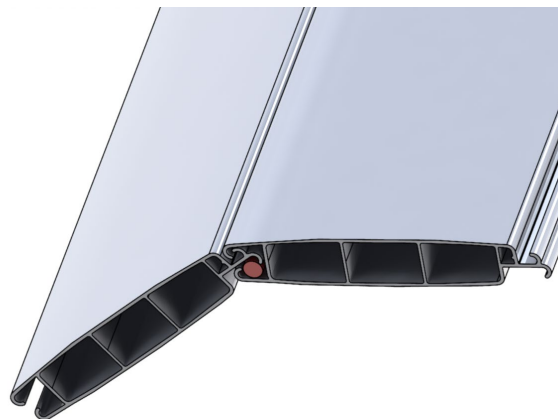
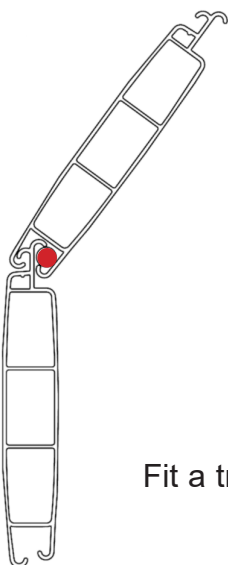
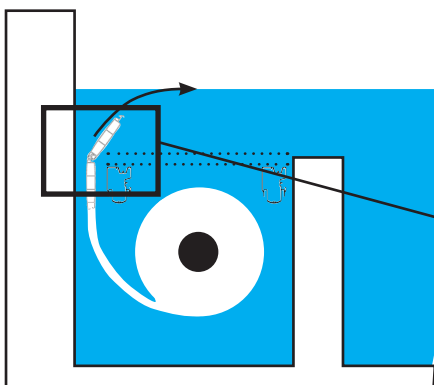

Fit a trim on each side of the first slat

The electric control box must be fitted in a dry room.
 The installation must comply with the NF C15-100 standard, et CEI 60364 (Last applicable version) ask your electrician for advice or contact your electricity provider.
 All our control boxes use a 230 Volt single phase (50Hz) power supply.
 The required power at the input terminals is 0.15 Kw.
 Upstream from the control box a suitably sized circuit breaker with a 30 mA ground fault device must be provided.
 For additional information, see the instructions supplied with the electrical box.

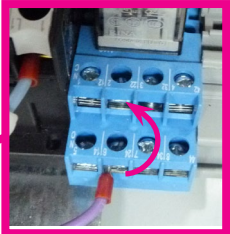

For salt electrolysis system:
 Inversion of the NO / NC control logic

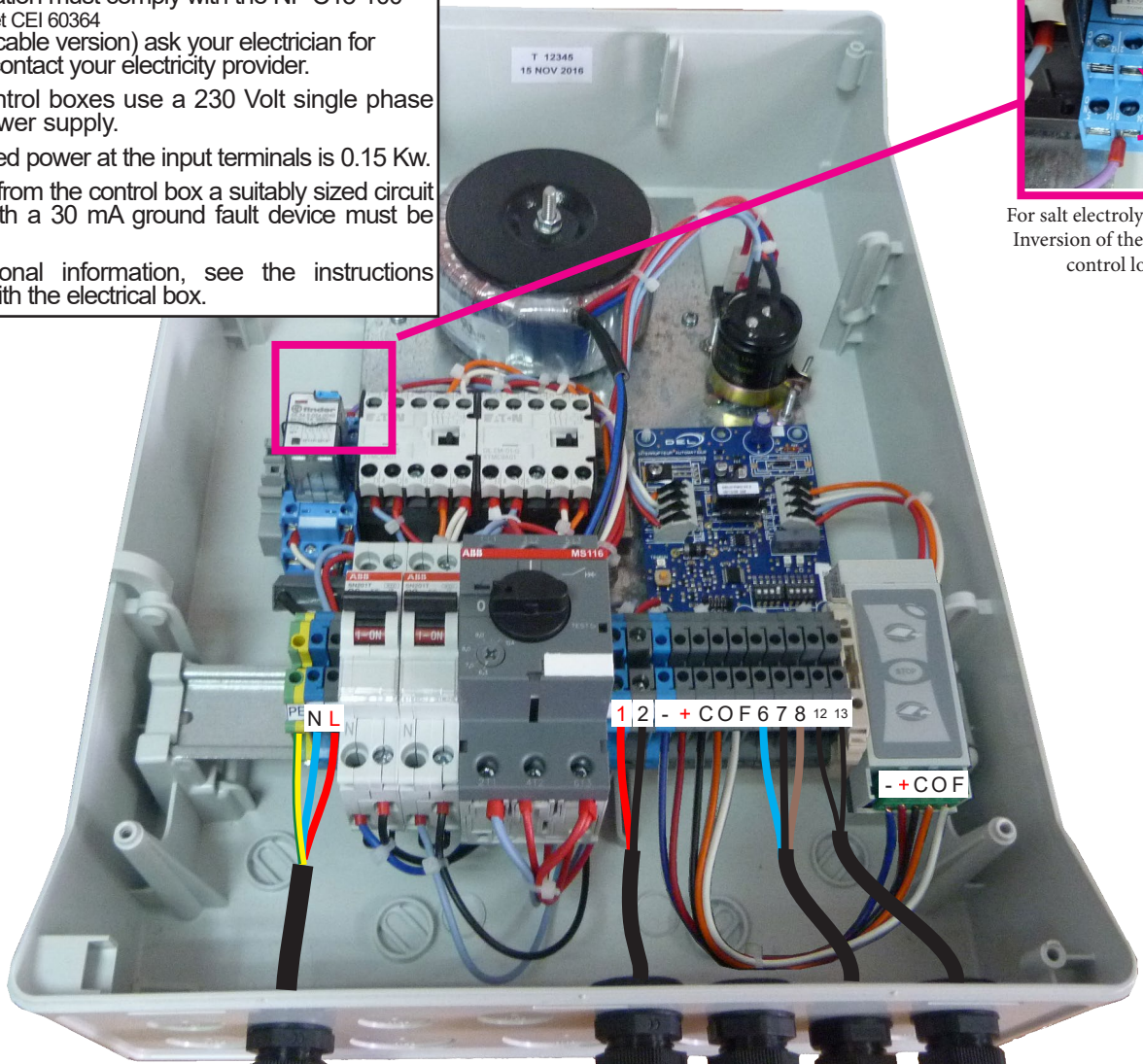

Circuit breaker with a 30 mA protection.

Salt electrolysis system



Connection
 Plug **N** and **L**
 230 VDC
 monophased 50 Hz

OPTION
 Connector
 see page 36

3 x 1,5 mm²

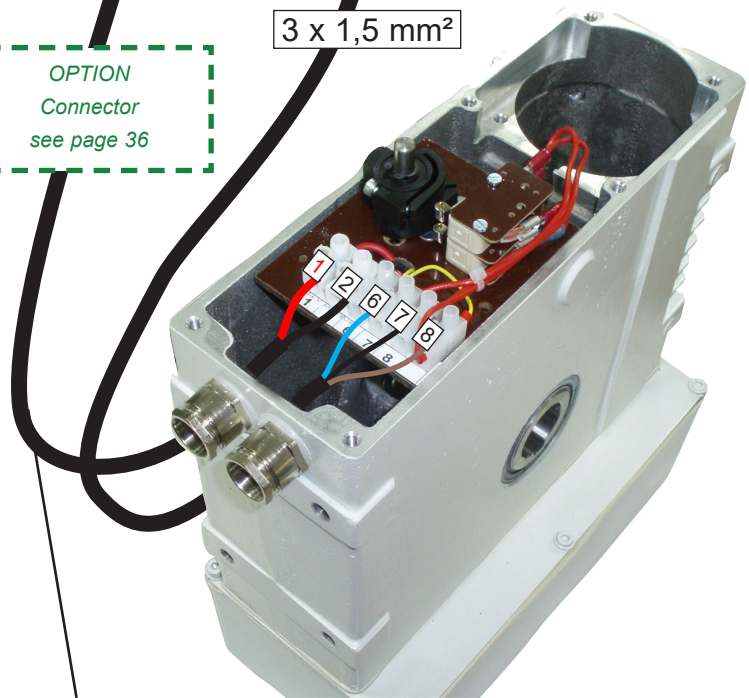

(U1000RO2V in a sheath)

2 x 4 mm² - up to 16 m in length.
 2 x 6 mm² - from 16 to 25 m in length.

The electric control box must be fitted in a dry room.
 The installation must comply with the NF C15-100 standard, et CEI 60364 (Last applicable version) ask your electrician for advice or contact your electricity provider.
 All our control boxes use a 230 Volt single phase (50Hz) power supply.
 The required power at the input terminals is 0.15 Kw.
 Upstream from the control box a suitably sized circuit breaker with a 30 mA ground fault device must be provided.
 For additional information, see the instructions supplied with the electrical box.

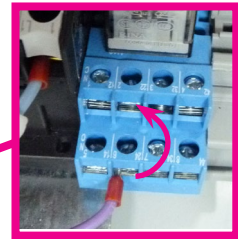

For salt electrolysis system:
Inversion of the NO / NC control logic

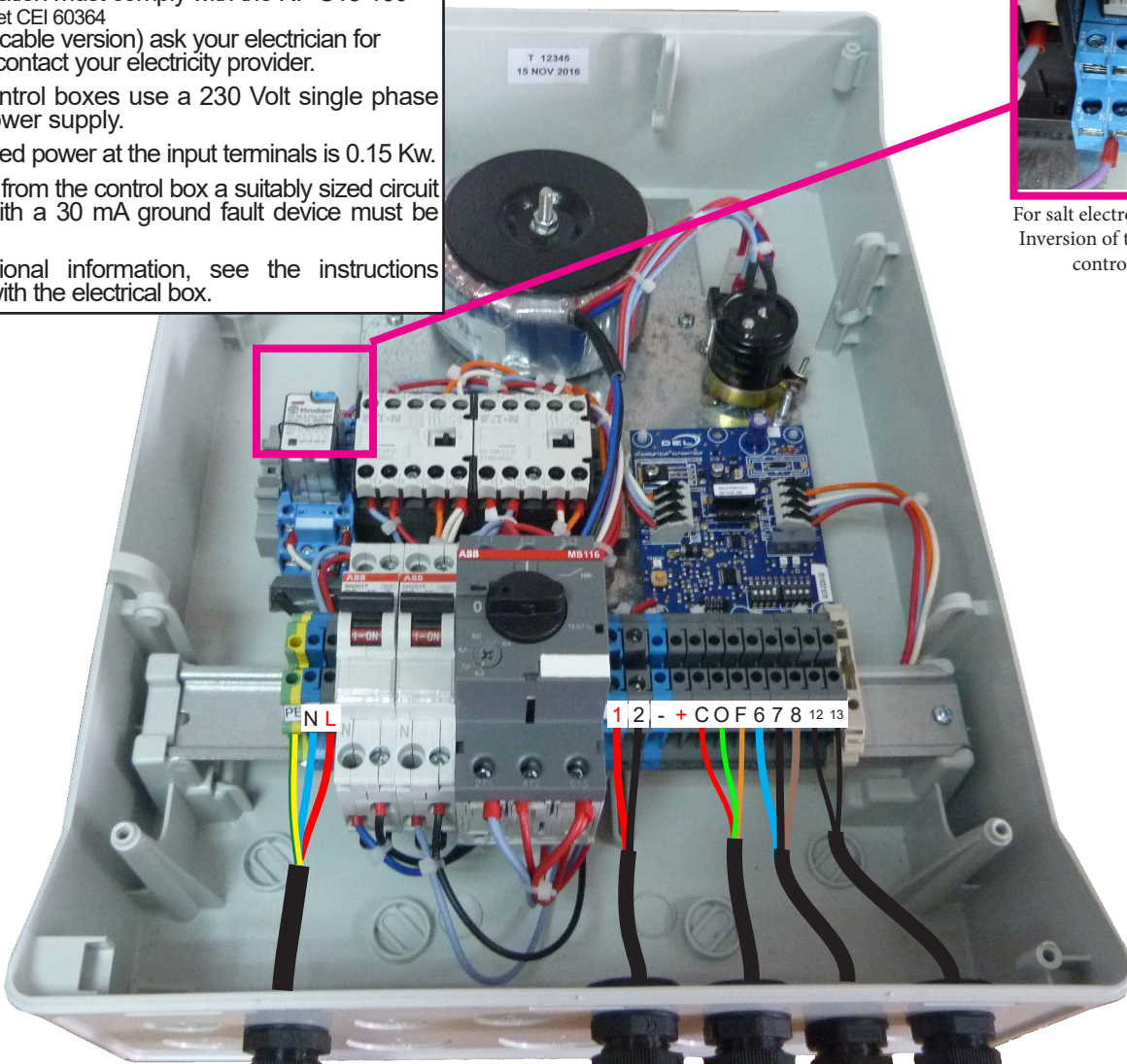

Circuit breaker with a 30 mA protection.



Connection Plug **N** and **L**
230 VDC
monophased 50 Hz

key switch



Salt electrolysis system

3 x 1,5 mm²

OPTION Connector see page 36

3 x 1,5 mm²

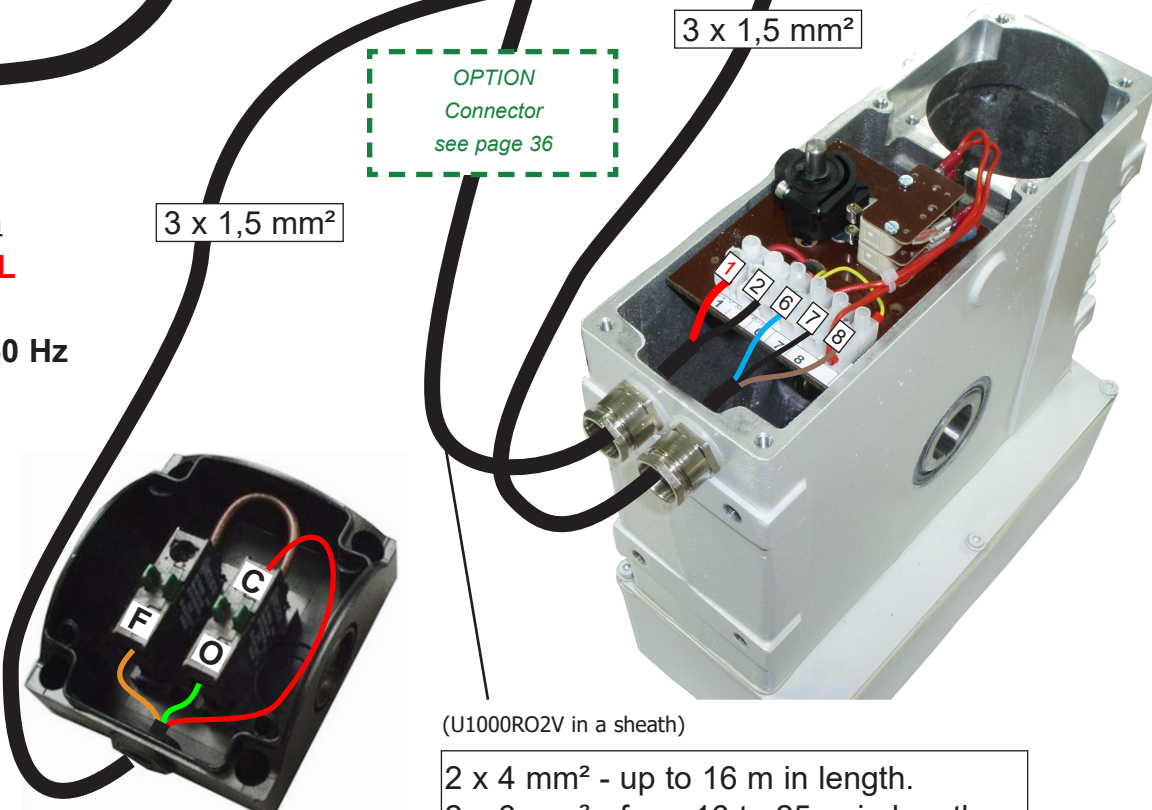

(U1000RO2V in a sheath)

2 x 4 mm² - up to 16 m in length.
 2 x 6 mm² - from 16 to 25 m in length.

The electric control box must be fitted in a dry room.
The installation must comply with the NF C15-100 standard, et CEI 60364 (Last applicable version) ask your electrician for advice or contact your electricity provider.
All our control boxes use a 230 Volt single phase (50Hz) power supply.
The required power at the input terminals is 0.15 Kw.
Upstream from the control box a suitably sized circuit breaker with a 30 mA ground fault device must be provided.
For additional information, see the instructions supplied with the electrical box.

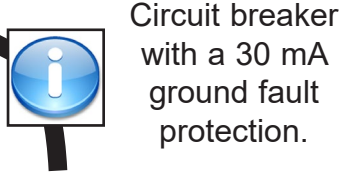
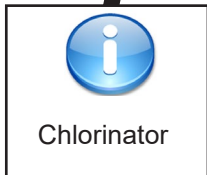
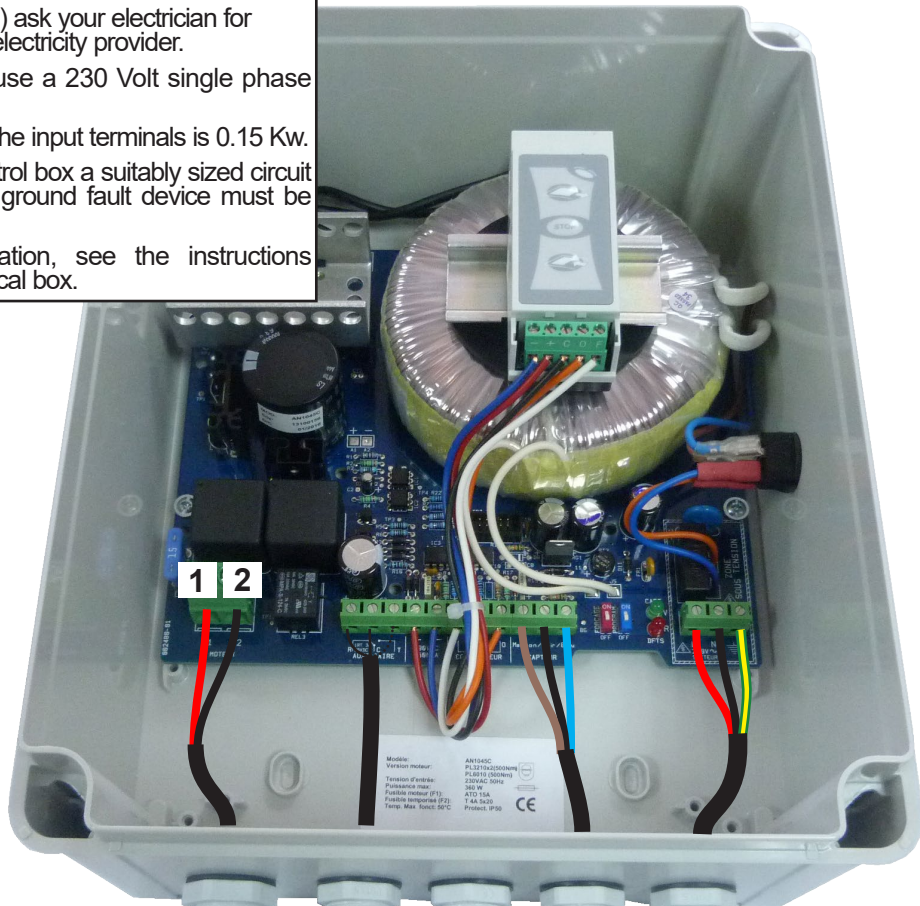

Connection
N and L plug
230 Volts
single
phased 50 Hz

3 x 1,5 mm²

OPTION
Connector
see page 36



(U1000RO2V in a sheath)

2 x 4 mm² - up to 16 m in length.
2 x 6 mm² - from 16 to 25 m in length.

The electric control box must be fitted in a dry room.
 The installation must comply with the NF C15-100 standard. et CEI 60364 (Last applicable version) ask your electrician for advice or contact your electricity provider.
 All our control boxes use a 230 Volt single phase (50Hz) power supply.
 The required power at the input terminals is 0.15 Kw.
 Upstream from the control box a suitably sized circuit breaker with a 30 mA ground fault device must be provided.
 For additional information, see the instructions supplied with the electrical box.

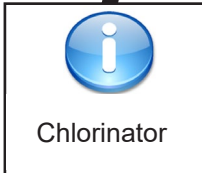
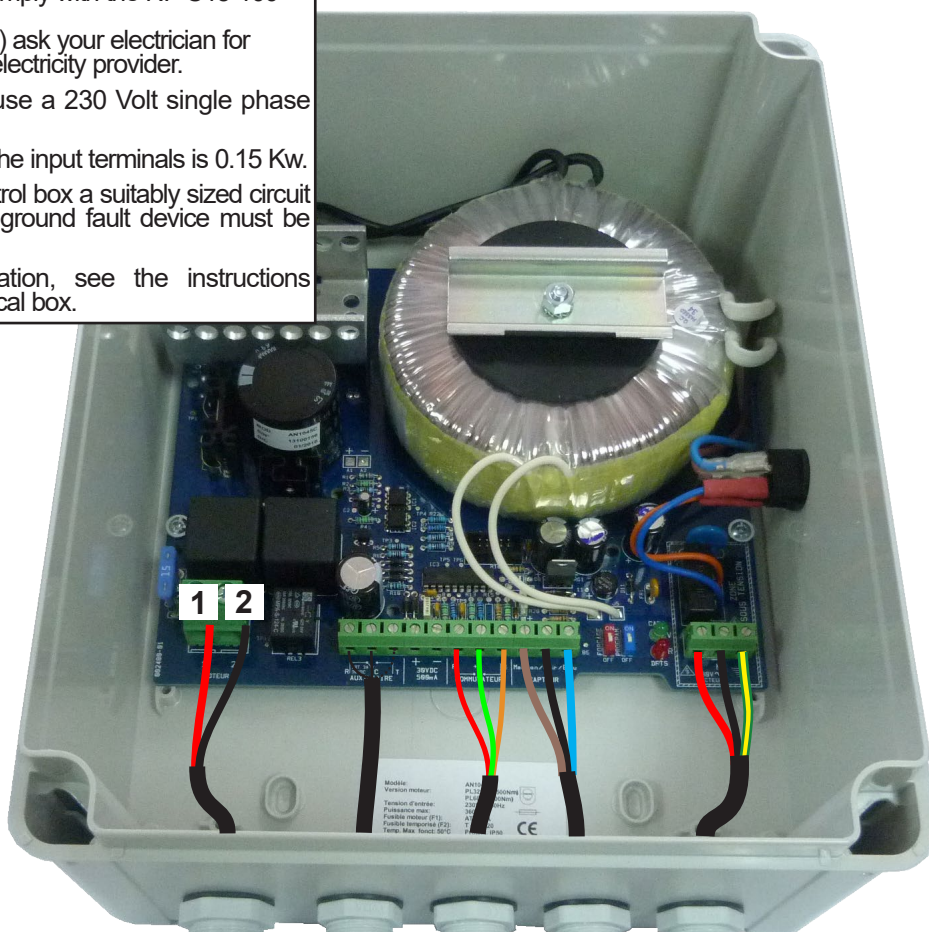

Circuit breaker with a 30 mA ground fault protection.

Connection
N and L plug
230 Volts
single
phased 50 Hz

3 x 1,5 mm²

Key Switch



Its location must be in a place from which it is possible to check that no one enters the manoeuvre.

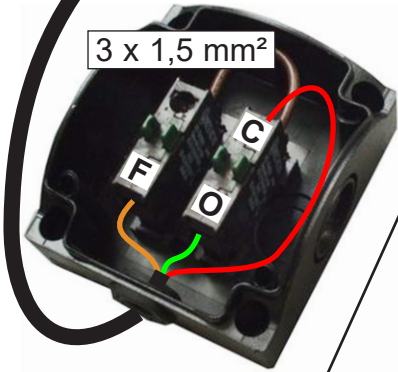

OPTION
Connector
see page 36



(U1000R02V in a sheath)

2 x 4 mm² - up to 16 m in length.
 2 x 6 mm² - from 16 to 25 m in length.

The electric control box must be fitted in a dry room.
 The installation must comply with the NF C15-100 standard. et CEI 60364 (Last applicable version) ask your electrician for advice or contact your electricity provider.
 All our control boxes use a 230 Volt single phase (50Hz) power supply.
 The required power at the input terminals is 0.15 Kw.
 Upstream from the control box a suitably sized circuit breaker with a 30 mA ground fault device must be provided.
 For additional information, see the instructions supplied with the electrical box.

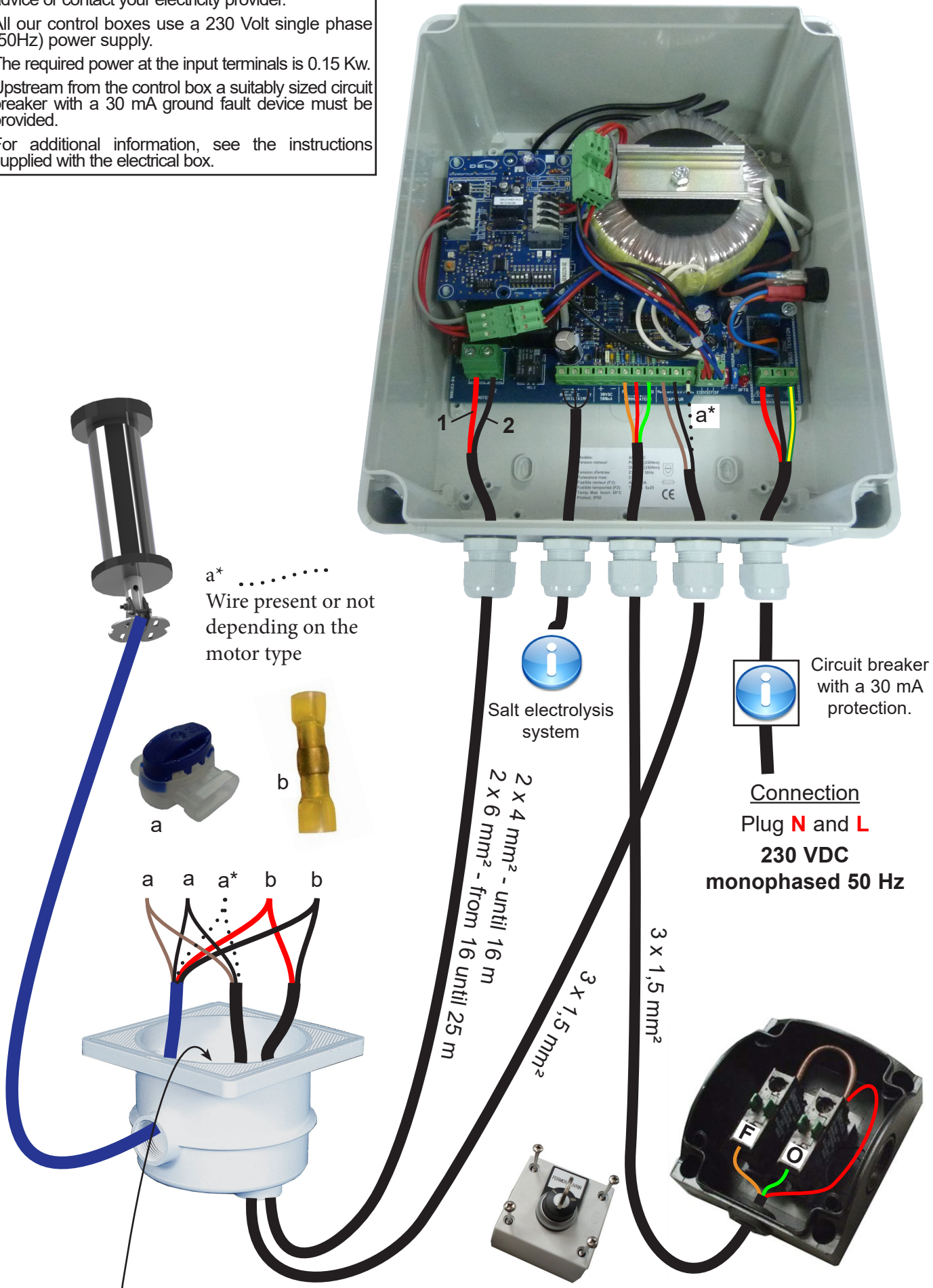

We recommend applying sealing gel in the connection box after having completed the wiring.

The electric control box must be fitted in a dry room.
 The installation must comply with the NF C15-100 standard, et CEI 60364 (Last applicable version) ask your electrician for advice or contact your electricity provider.
 All our control boxes use a 230 Volt single phase (50Hz) power supply.
 The required power at the input terminals is 0.15 Kw.
 Upstream from the control box a suitably sized circuit breaker with a 30 mA ground fault device must be provided.
 For additional information, see the instructions supplied with the electrical box.

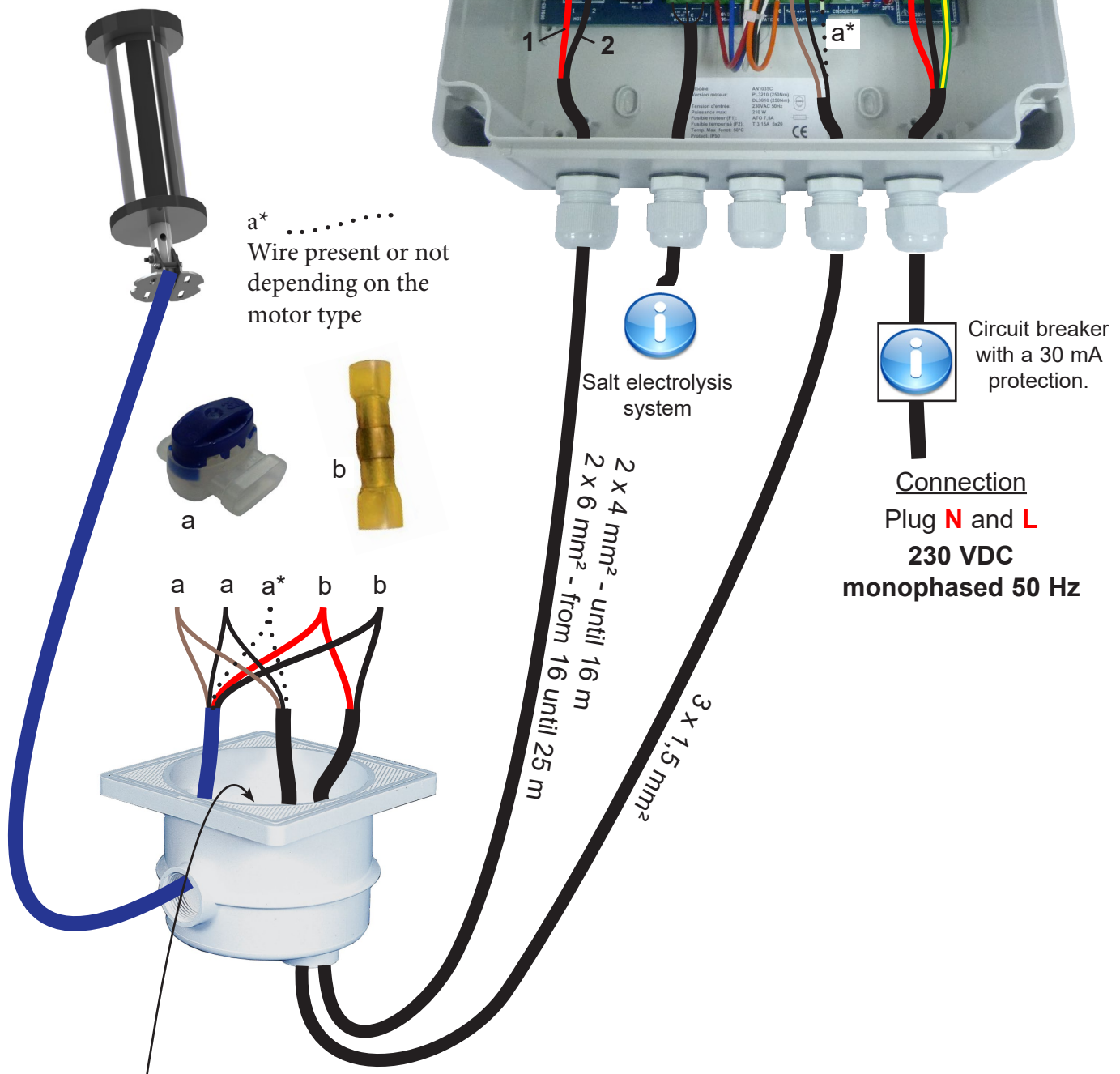
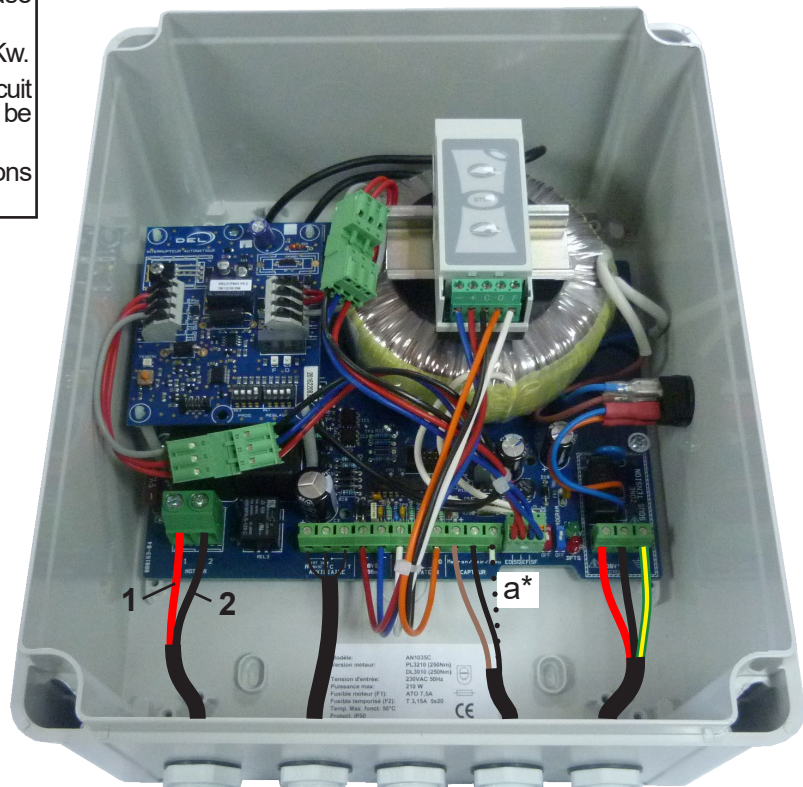

We recommend applying sealing gel in the connection box after having completed the wiring.

ELECTRICAL DRAWING ELECTRICA PLUG - OPTION



Located between the motor and the control panel, allows to unplug the motor without dismantling it
For winterizing, replace the motor by the winterizing handle

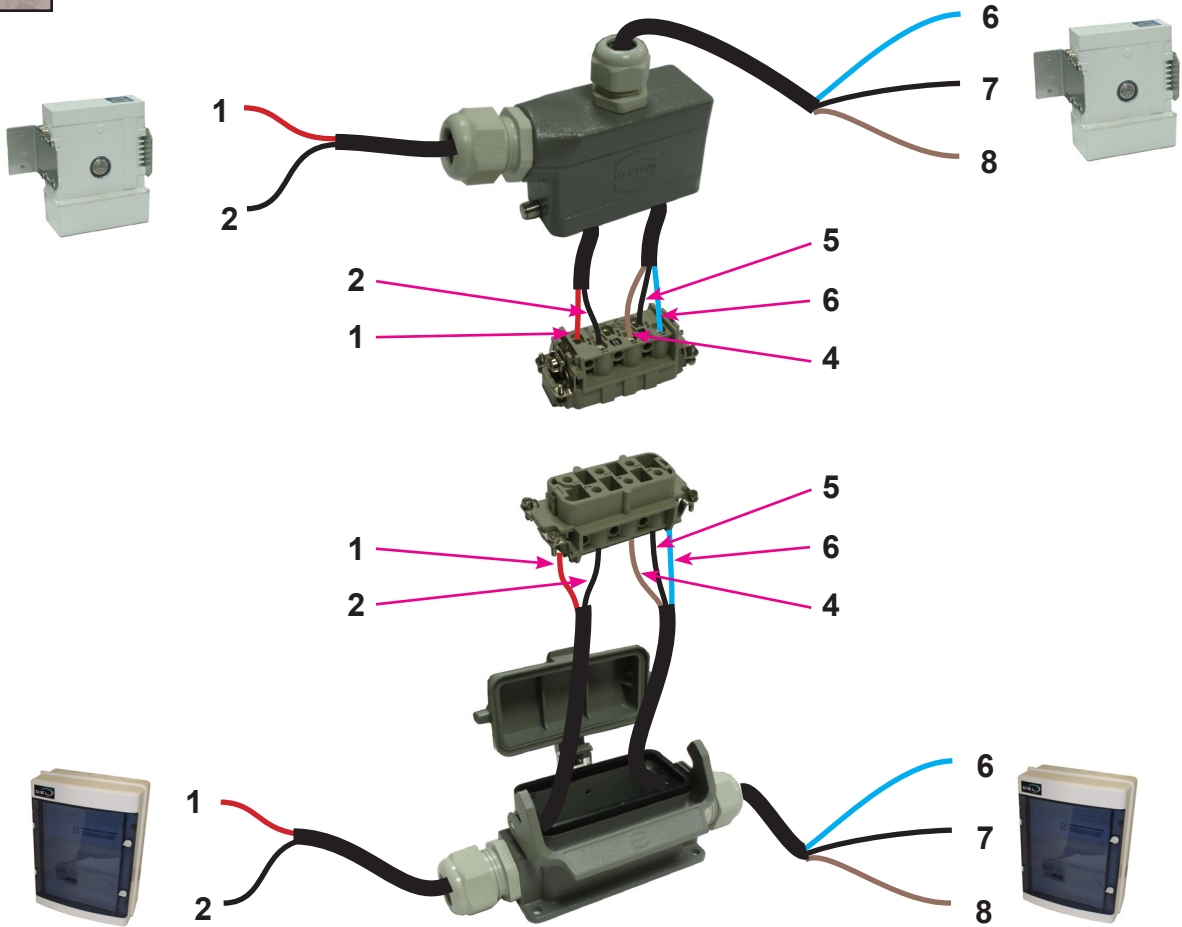

WI-KEY INSTALLING THE CONTROL BOX

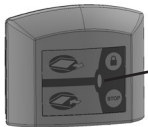

red / green flashing = emitter locked
Emitter unlocking procedure see «page 48»

The emitter must be located outside volume 0.

The distance between the emitter and the receiver must not exceed:

- 50 m in an obstacle-free zone.
- 25 m behind a basic wall.
- 15 m behind several walls or an especially thick wall.

we recommend checking emitter/receiver communication before fixing permanently.

- It must be located in a place from which it is possible to check that no one enters the pool during the manoeuvre.
- It is mandatory to install the locking «strip».
- Before fixing the control box, check that the emitter is communicating with the receiver.

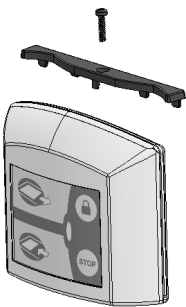

The support must be attached to a fixed support

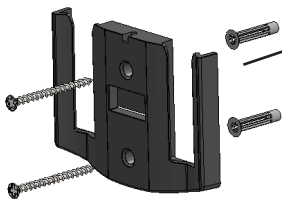

Closing



Keyboard lock

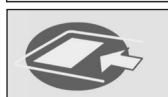

Opening



Stops the current action

Checking of the automatic stop position

1

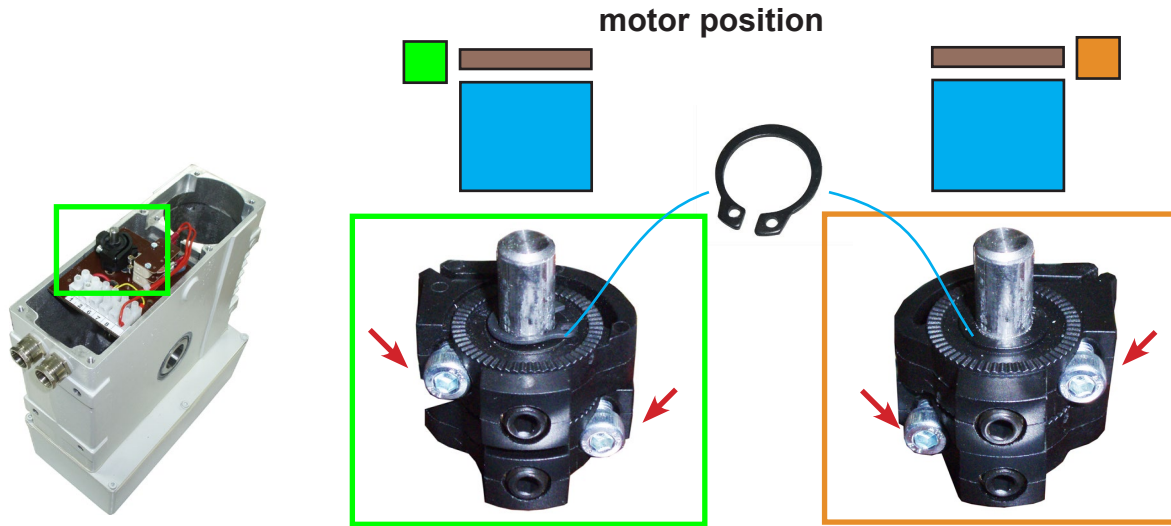

Untighten the cam screws

2

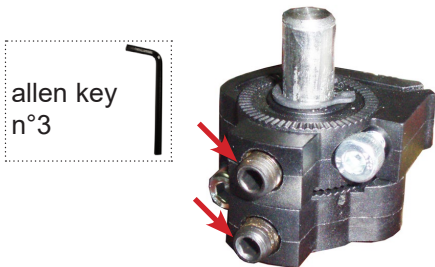

Close the electronic card

3

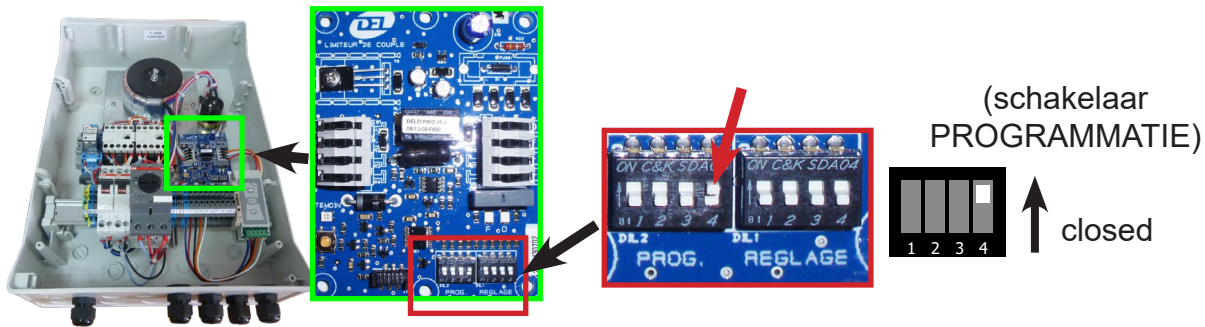

Checking of the roll in roll out direction

4

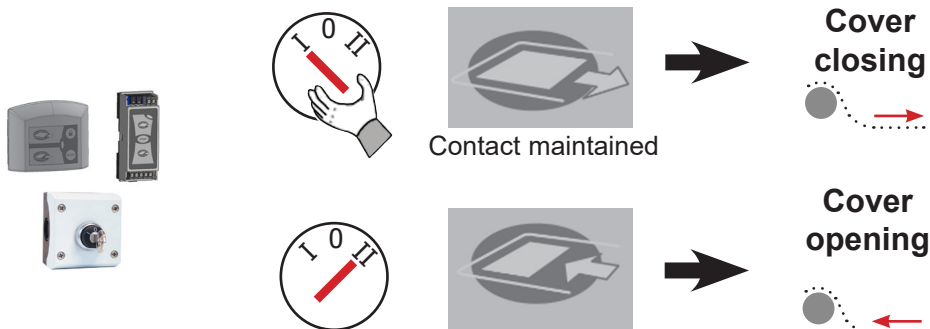

if the control logic is incorrect, Check the wiring installation

5

Cover installation «open pool»



Adjust the position of the cover using the programme «open and closed»



Be careful to choose the right position, it will be the starting reference.

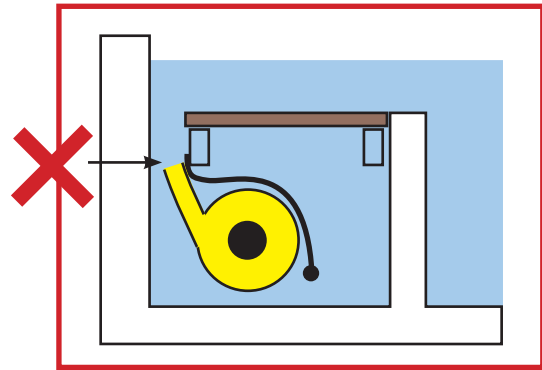
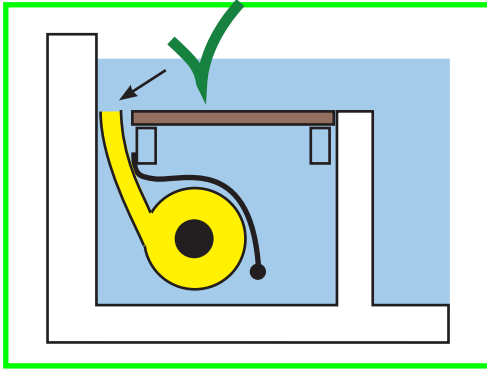

38

6

Recording position «open pool»



Allen key
n°3

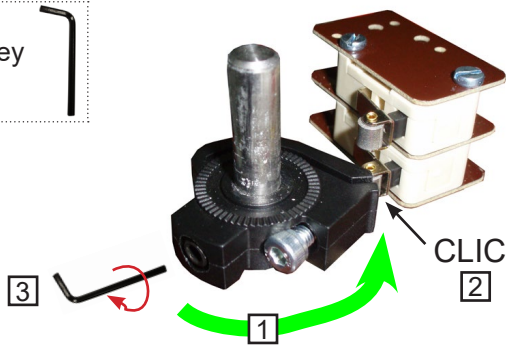

or

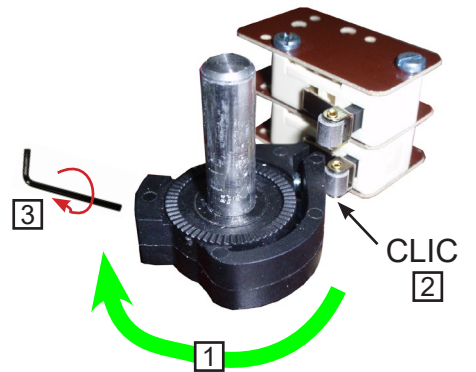

Cover installation «closed pool»



Adjust the position of the cover using the programme «open and closed»

7

Be careful : the last operation used must be a closing.

«if you cannot close the cover, chek the electric control is correct and start the automatic stop ajustement procedure from the deginning. »

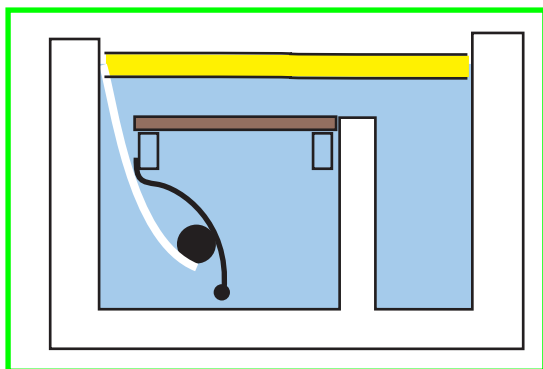

39

Recording position «closed pool»

Allen key n°3

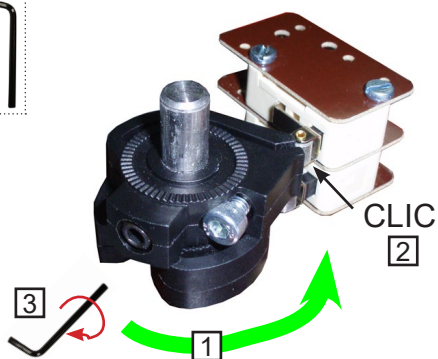

or

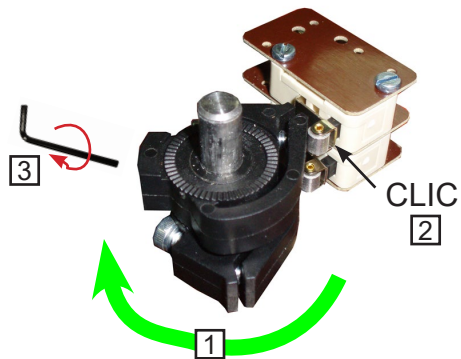

8

Automatic stop adjustment

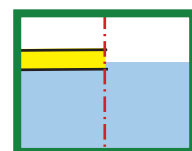
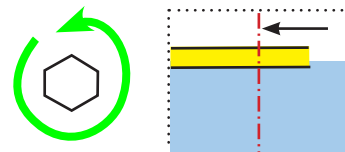
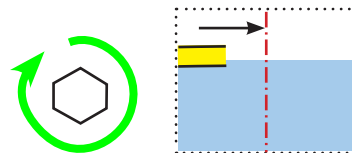
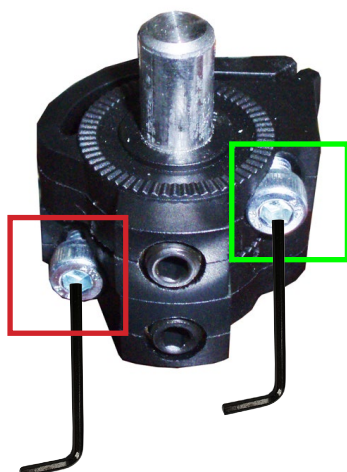
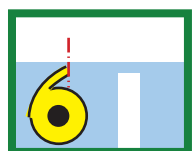
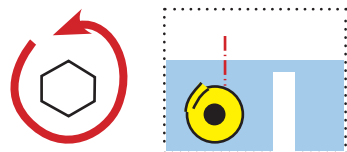
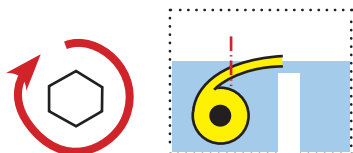

1 - Programme starting :

1

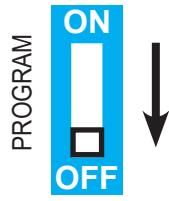
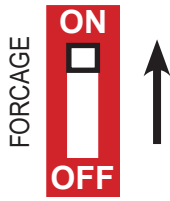

2 check up

2



Cover closing



Cover opening

if the control logic is incorrect, Check the wiring installation

40

Cover installation «open pool»



Adjust the position of the cover using the programme «open and closed»

Be careful to choose the right position, it will be the starting reference.

3

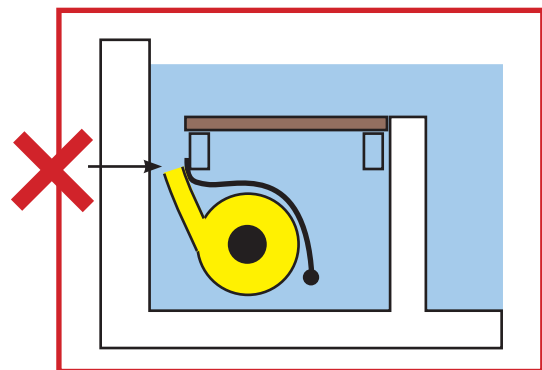
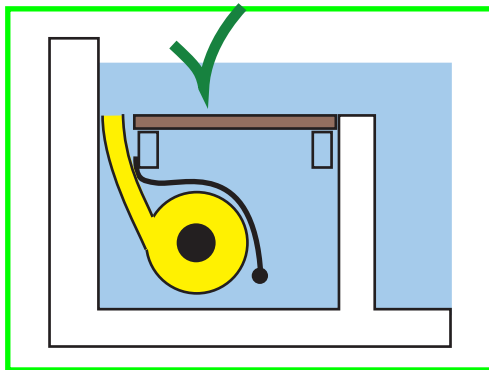

4 Recording position «open pool»

4

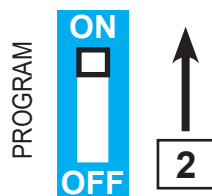
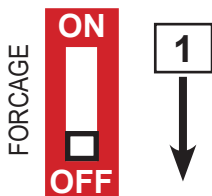

5

Cover installation «closed pool»



Adjust the position of the cover using the programme «open and closed»

Be careful : the last operation used must be a closing.

«if you cannot close the cover, chek the electric control is correct and start the automatic stop adjustment procedure from the deginning. »

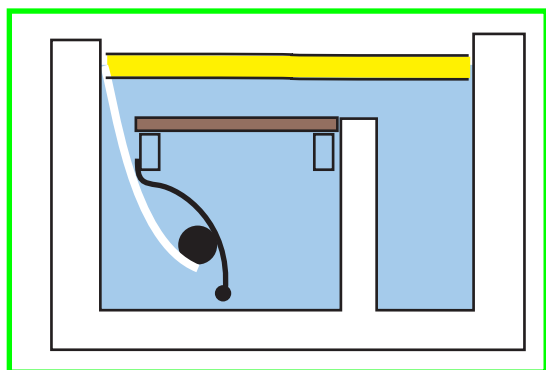

6

Recording position «closed pool»



7

Automatic stop adjustment is over.

INFORMATION

The automatic switch protects the system in case locking kits are unreleased when opening the pool.

If the cover jams, the motor is shut down automatically.

Different cases of jamming:

- Unreleased safety locking kit.
- cover rubbing (on the beam, coping stone...)
- Object in the pool jamming the cover (cleaner, counter-weight ...).

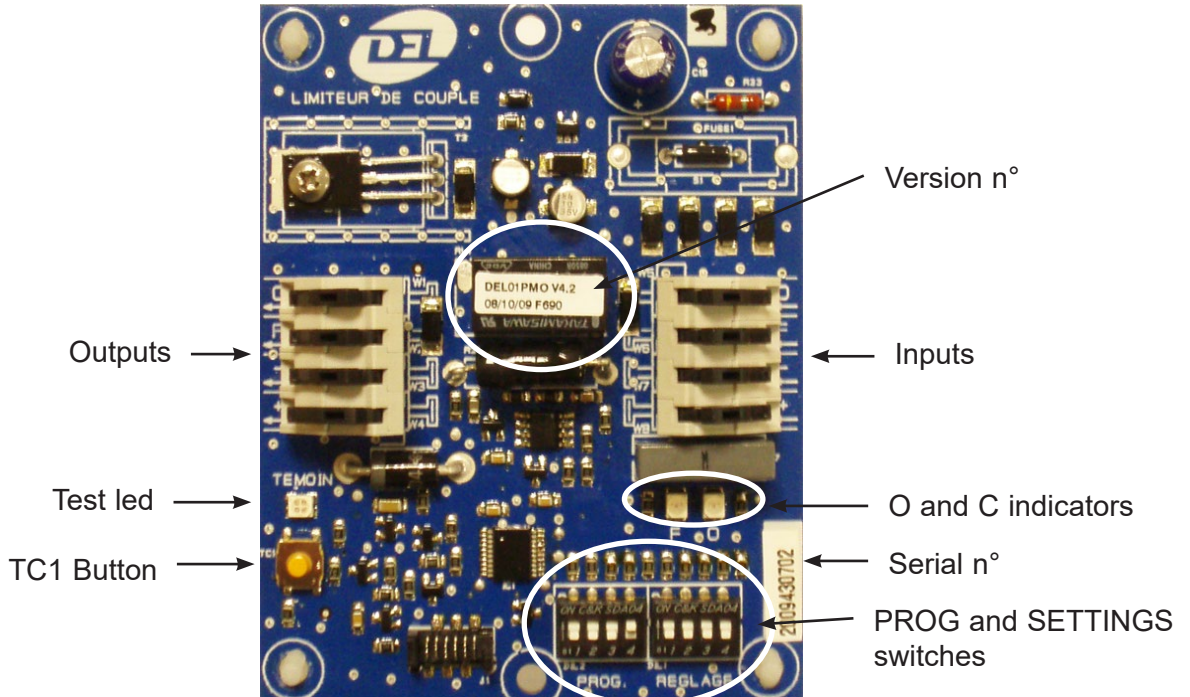

CHECKING THE COMMAND LOGIC ON THE AUTOMATIC SWITCH

- Deactivate the automatic switch

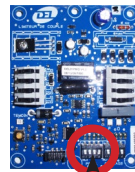

(Switch PROG)



- Check :

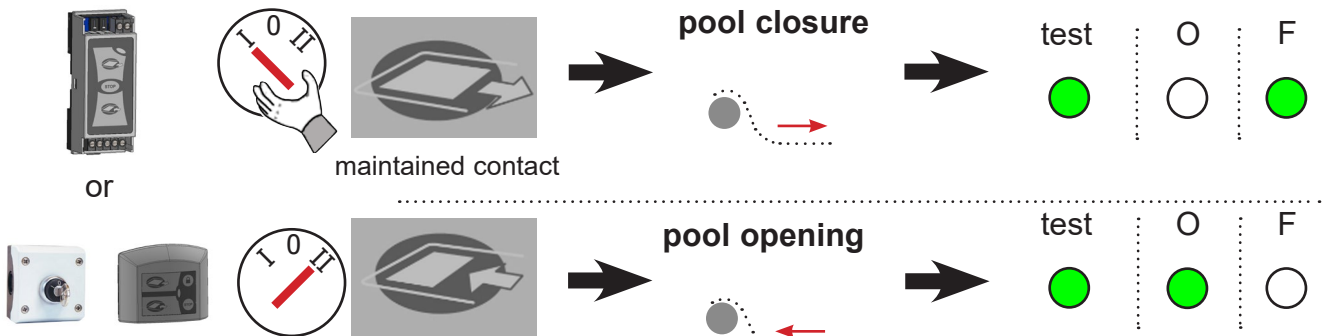

if the key switch is incorrectly wired

SETTING THE ROLLER MODEL (SETTINGS SWITCH)

Immersed motorisation



Dry pit motorisation



CONTROL TIME SETTING (SETTINGS SWITCH)

L = pool length steps included

$L \leq 12$ m



30 seconds

$L > 12$ m



60 seconds



ADJUSTING THE TRIGGER SENSITIVITY (PROG SWITCH)

l = pool width

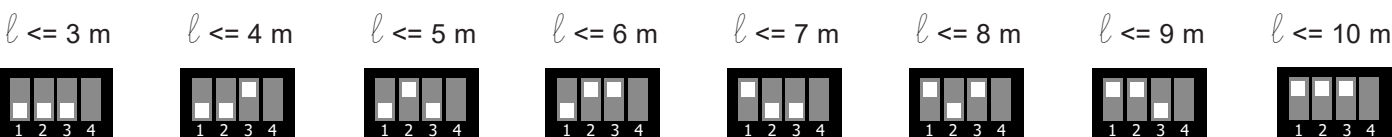

← Maximum sensitivity ----- Minimum sensitivity →



ACTIVATION (PROG SWITCH)

activated



Failure to activate the automatic switch can cause serious damage to the motor, the control box, the slats and void the warranty.



IMPORTANT

Contact maintained more than 3 secs
= The next opening will be protected



+ 3 seconds



Contact maintained less than 3 seconds
= The next opening will not be protected



- 3 seconds



TEST

A - Block the cover by hand or with fixture kits and open the cover

⇒ The motor is automatically stopped.
(if necessary adjust the sensitivity of the switch activation)

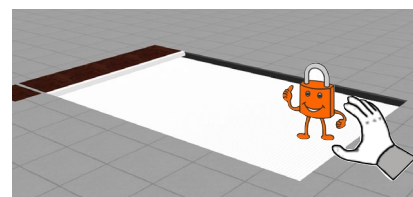

If there are unplanned activations, reduce the sensitivity level by selecting the setting for the next bigger width.

card activated	test	
	O	F
Opening, control in progress		
Opening without control		
Closure		
Protection ON		

Push-lock

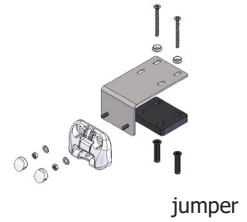
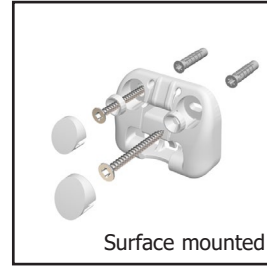
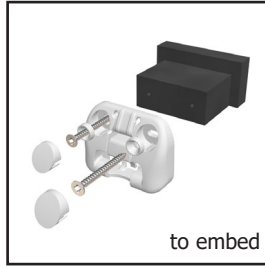

FASTENER KIT POSITIONING RULES

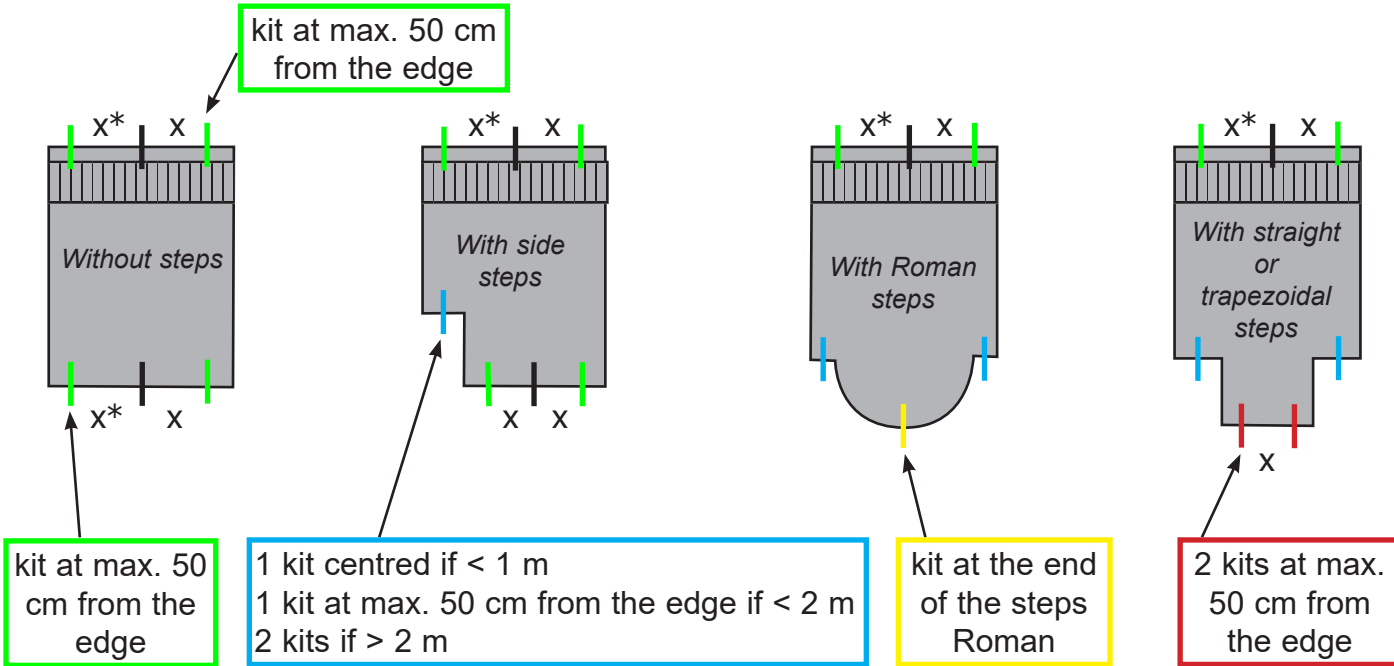

* X must never exceed 2 m

The position of the fastener kits on the cover is indicated on the drawings shipped with the slats.

All changes to the positioning of the kits must comply with the rules given above. For other cases please contact us.

A water level regulator is mandatory

Insert mounted model

For concrete and panel pools

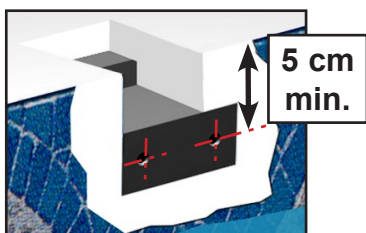

5 cm min.

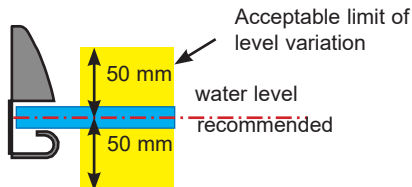

VBA TF Torx stainless steel A4 Ø6 x 50 wood screw

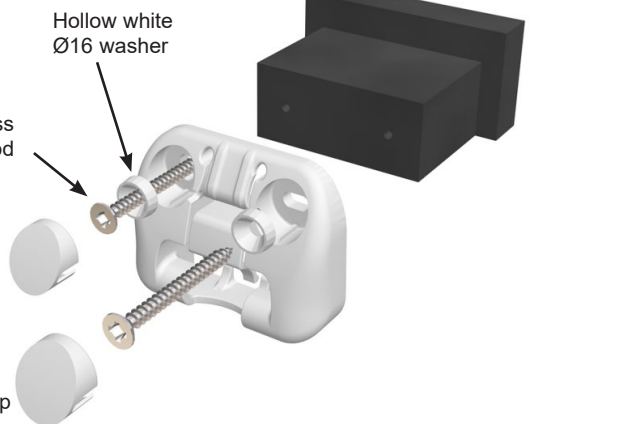

Hang mounted version

For concrete and panel pools

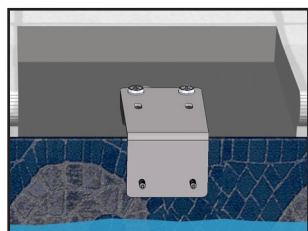

Ø8

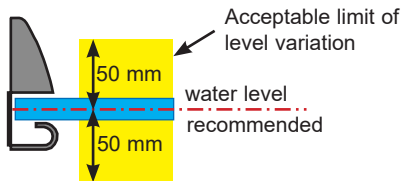

Stainless steel nut A4 M10

VBA TF Torx stainless steel A4 Ø6 x 50 wood screw

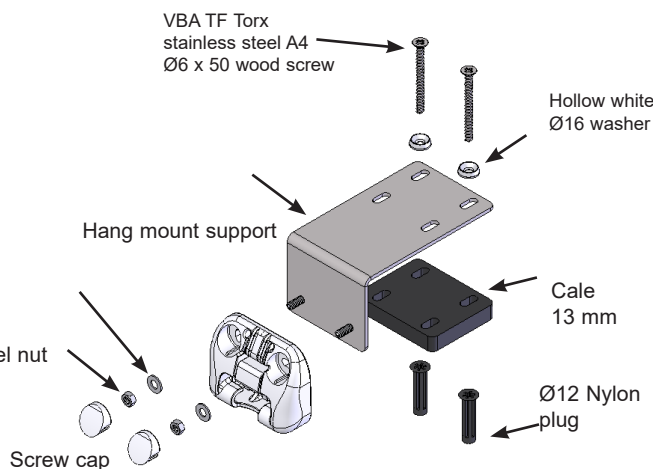

Surface mounted model

For concrete and concrete block pools, as well as pools with wall thickness greater than or equal to 8 mm

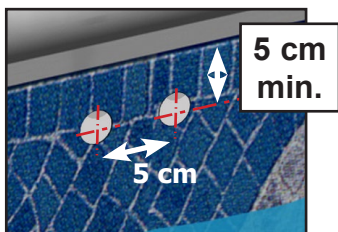

5 cm min.

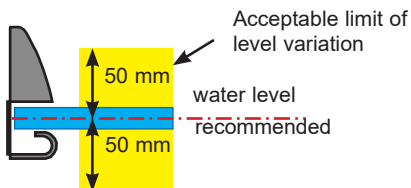

VBA TF Torx stainless steel A4 Ø6 x 50 wood screw

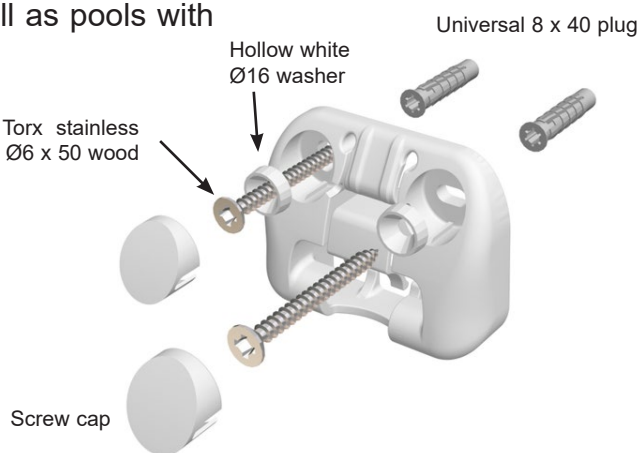

Concrete

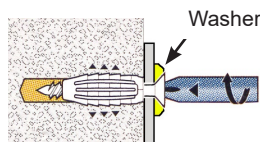

Once the resistance point has been reached stop screwing, this would deteriorate the fixture quality.

Concrete block

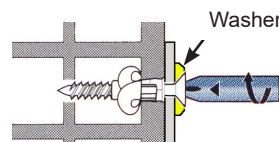

After reaching the resistance point, make 3 more turns of the screwdriver to finish tightening.

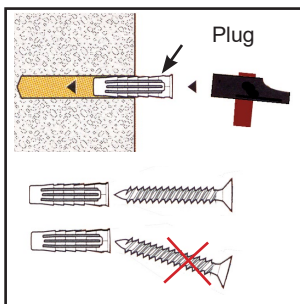

OPENING/ CLOSURE OF THE POOL

**ALWAYS KEEP AN EYE ON THE POOL DURING OPENING OR CLOSING OPERATIONS.
ALWAYS CHECK THAT THE POOL WATER LEVEL IS CONSTANT AND COMPLIANT WITH THE
RECOMMENDATIONS ON THE INSTRUCTIONS**

- It is imperative not to halt the cover in an intermediate position, this can cause the risk of jamming a bather's body under the cover casing, if a bather uses the pool.
- When using an automatic cleaner under the cover, check that the hose does not affect the movement of the slats when opening and closing the cover.
- It is essential to remove floating objects when opening and closing the cover.
- Do not block the cover while extending or retracting.
- Do not activate the automatic cover when it is iced in.
- The opening or closure operation requires about 2 minutes for one person and about 3 minutes to lock or unlock the attachment kits.

Opening: Always release the cover before starting the motor.

- Unlock all the fastening systems.
- Operate the open control.
- Stow the unlocking tools out of the reach of children.
- Lock the WI-Key command



Closure:

- Operate the «contact maintained during closure» close control
- Lock all the fastener systems.
- Stow the unlocking tools out of the reach of children.
- Lock the WI-Key command



Never place products that were not designed for the purpose on slat covers, as this may warp the slats. Never leave objects on the cover (towels, buoys, etc.) because, in direct sunlight, the slats would be locally expanded and the warranty would be void.
«Solar polycarbonate slats are incompatible with bromine treatments and treatments containing bromine. Do not put undiluted chemical products in direct contact with solar polycarbonate slats (e.g. algae protection products). It is essential to first carry out a test on a small surface area.»

46

IMPORTANT

When closing the pool, it is essential to KEEP THE CONTROL PRESSED FOR AT LEAST 3 SECONDS. This is required to guarantee automatic obstacle detection the next time the cover is opened.

LOCKING THE WI-KEY

- Press on for more than 3 seconds until the pilot flashes

= system locked

UNLOCKING THE WI-KEY

- Press and keep it pressed.
- At the same time: successively press the following 3 keys:
- The pilot remains on = emitter unlocked

LIGHT INDICATORS

When you press a key, the light indicators below provide information on the Wi-key status (locked/unlocked), as well as the battery charge level.

	Green LED	----->	Wi-key unlocked
	Red/green flashing LED	----->	Wi-key locked
	Orange LED	----->	Battery level low
	Red LED	----->	Change the batteries (2 x LR03)

Locking

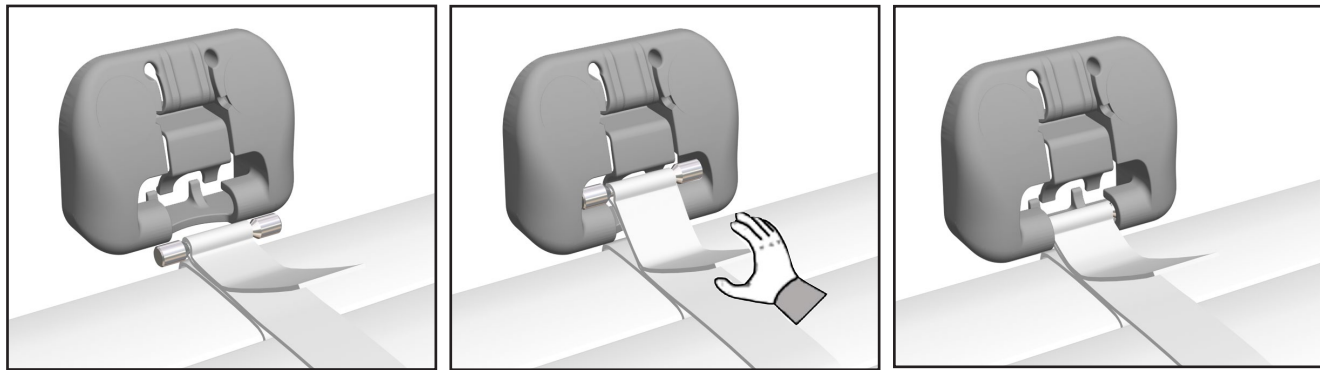

Releasing

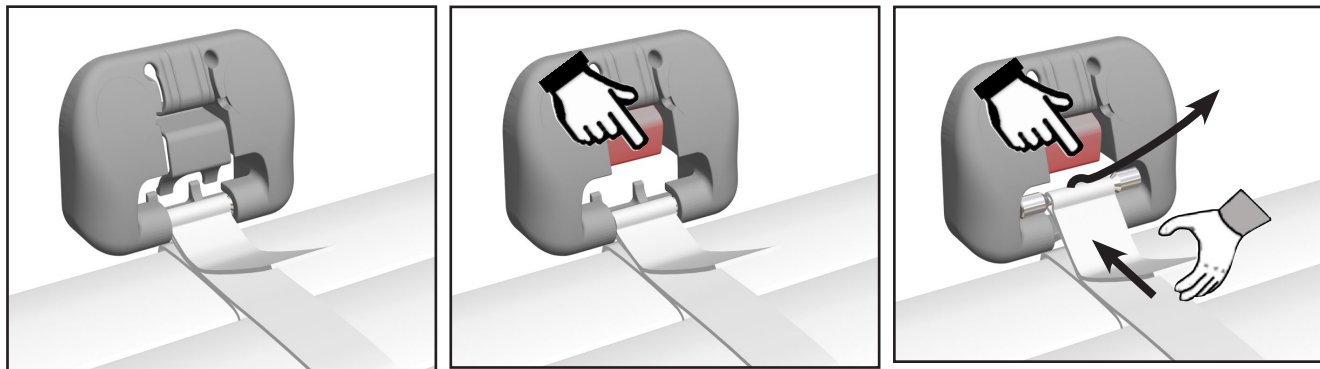

WHAT TO DO IF THE SYSTEM STOPS WHEN OPENING

1 - Stop due to an actual jam: (unreleased locking kits or other...)

- Close the cover for more than 3 seconds, until the tension of the cover is completely released. *(The next opening will remain protected by the system)*
- Remove causes of jamming, and resume opening the pool.

2 - In the event of an unexplained stoppage :

- Close the cover **between 1 and 3 seconds**. *(The next opening will no longer be protected by the system)*
- Open the pool again.

If there are repeated activations, decrease the automatic switch sensitivity level.

- modify the "Trigger sensitivity" parameter. (see page 45)

The use of the automatic cover when the automatic switch is in "deactivated" mode can cause serious damage to the motor, the electric control box, the slats and also void the warranty.

MEANING OF THE LEDS ON THE AUTOMATIC SWITCH

card	activated		Test			O	C	Flashing LED
			●	○	○			
	Opening, control in progress	●	○	○	○	○	Permanent LED	
	Opening without control	○	○	○	○	○		
	Closure	○	○	○	○	○		
	Protection ON	○	○	○	○	○		
card	deactivated		Test			O	C	Flashing LED
			●	○	○			
		○	○	○	○	○		
		○	○	○	○	○		

Pairing -- delivered pre-paired

1 receiver

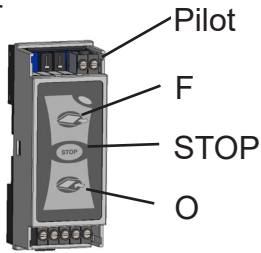

Press «STOP» and, without releasing it, press «O» for more than 3 seconds
OK when the «pilot» flashes green.

an emitter must be paired within the next 30 seconds.

2 emitter

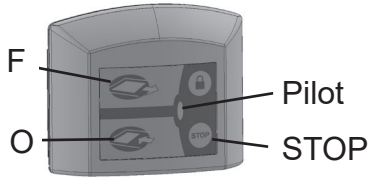

Press «STOP» and, without releasing it, press «O» for more than 3 seconds
OK when the «pilot» flashes red / green.

another emitter must be paired within the next 30 seconds.

Replacing the batteries





Be careful of the seal when re-assembling



	Receiver	Emitter	
Manufacturer	DEL	DEL	
Reference	Wikey receiver	Wikey emitter	
Category	3 (EN 300220-1)	3 (EN 300220-1)	
Range	50m in an obstacle-free zone	50m in a free zone	
	25m through a concrete wall	25m through a concrete wall	
Power supply	12 to 48 VDC 30mA max	Two 1.5V AAA batteries	
Protection index	< IP40	< IP54	

DL6010 CONTROL BOX LED MEANINGS

 Flashing LED	 Flashing LED	 Permanent LED	 Permanent LED
--	--	---	---

 	Initialisation <i>LEDs flash alternatively</i>	 	The motor is running <i>regular slow flashing</i>
--	--	--	---

 	Sensor fault <i>(check connections and cables) permanently on</i>
--	---

 	Electronic fault <i>(check connections and cables / return to the factory) fast flashing</i>
--	--

 	Software fault <i>(reprogram the automatic stops) Permanently on</i>
--	--

POOL WATER LEVEL

- In order to ensure the correct operation of the roller, always check that the pool water level is constant and compliant with manufacturer recommendations.
(the use of a water level regulator is mandatory)
- If the water level is too high, it might come from leaves in the skimmer.
- If the water level is too low there is a risk of jamming.
- In case of hand rails, the pool must be equipped with a water level regulator.

FILTERING

- Programme filtering during sunlight periods and operate it permanently as soon as the water reaches 25°C.

CLEANING (USER'S RESPONSIBILITY)

- Clean your cover fully twice a year (start of season and wintering). This is even more important if you have hard water. If this is the case, use a high pressure cleaner with warm water and a descaling product (see DEL catalogue).

The slats must only be cleaned using clear water or neutral detergents.

Especially avoid using alkaline (basic) or acid cleaning products.

Do not use abrasive products or equipment to clean, this could cause scratches. If necessary make a test on a small area of the cover that is not visible.

- Take the same care to regularly clean the locking systems for optimum operation.
- It is advisable to inspect the whole system in the event of abnormal strain on the cover (eg. somebody falling)
- Check the straps annually

MAINTENANCE

- All work must be carried out by a professional who will contact the manufacturer if necessary. (Contact details on the back of the document)
- All spare parts must be original.
- Inspect the whole cover for damage/wear and tear.
- At the beginning of each season and in the case of accidents (falls or hail on the cover, abnormal strain on the cover, etc.) check that the slats do not have any visible deterioration that could impact the operation of the cover (cracked, punctured, bent slats etc.). Change the slats or the whole cover if necessary.
- In both summer and winter, do not cover the slats with an opaque cover. There is a risk of damage due to excess heat.
- Check the straps (seams) and the anti-abrasion sheath.
- Once a year, check the electrical connections.
- - The «witness» flashes RED = change the control box battery

WINTERING

- Winter the pool depending on its geographic location.
- Close the cover.
- Wintering the gear motors:
 - Close the cover in the safety position.
 - Take the motor off, grease the stainless steel shaft and store it in a dry, ventilated room.
 - Switch the mains supply off (control panel and circuit breaker)
- We recommend you install the IVERNEA winter shield to protect the cover from UVs and dirt

DEAR CUSTOMERS,

THANK YOU FOR CHOOSING A DEL AUTOMATIC COVER.

PLEASE READ THE INSTRUCTIONS BELOW CAREFULLY.

·POOLS CAN BE A SERIOUS DANGER FOR CHILDREN. DROWNING CAN HAPPEN QUICKLY.

S A F E T Y A D V I C E

WHEN CHILDREN ARE AROUND THE POOL THIS REQUIRES YOUR CONSTANT VIGILANCE AND ACTIVE SUPERVISION, EVEN IF THEY CAN SWIM.

LEARN LIFE SAVING TECHNIQUES.

REMEMBER AND POST THE EMERGENCY SERVICE NUMBERS CLOSE TO THE SWIMMING POOL.

- FIRE BRIGADE: 18 (IN FRANCE) OR 112 FROM A CELL PHONE
- AMBULANCE : 15 (IN FRANCE)
- POISON CENTRE:

·THIS COVER IS NOT A SUBSTITUTE FOR COMMON SENSE NOR FOR PERSONAL LIABILITY. THE PURPOSE OF THIS COVER IS NOT TO REPLACE THE VIGILANCE OF PARENTS AND/OR RESPONSIBLE ADULTS WHICH REMAIN THE ESSENTIAL FACTORS FOR THE SAFETY OF YOUNG CHILDREN.

·COMPLY WITH THE WATER HEIGHTS DEFINED BY THE MANUFACTURER.

·THE COVER MUST SYSTEMATICALLY BE CLOSED DURING ALL ABSENCES FROM HOME, HOWEVER SHORT.

·MAKE SURE THERE ARE NO BATHERS OR FOREIGN BODIES IN THE POOL BEFORE AND DURING CLOSING.

·PLACE THE NECESSARY TOOLS TO OPEN THE COVER OUT OF THE REACH OF CHILDREN (THE KEY FOR EXAMPLE)

·THE OPENING ACTION OF THE MECHANISM SHOULD ONLY BE UNDERTAKEN BY A RESPONSIBLE ADULT.

·IT IS FORBIDDEN TO CLIMB ONTO, WALK ON, OR JUMP ON AN AUTOMATIC COVER.

·A CHILD CAN DROWN IN UNDER 3 MINUTES, NO TYPES OF PROTECTIVE MEASURE CAN REPLACE SUPERVISION AND VIGILANCE BY A RESPONSIBLE ADULT.

·THE PHYSICAL PRESENCE OF A RESPONSIBLE ADULT IS ESSENTIAL WHEN THE POOL IS OPEN.

SWIMMING POOL BUILDER

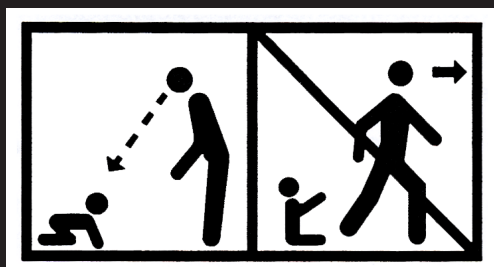

ZA La basse croix rouge 35530 Brécé - tel : 02 99 00 17 72 - fax : 02 99 00 21 79