

CODE 15780, 15781, 22399

DESCRIPTION: CANTABRIC TOP FILTER 400 500 600

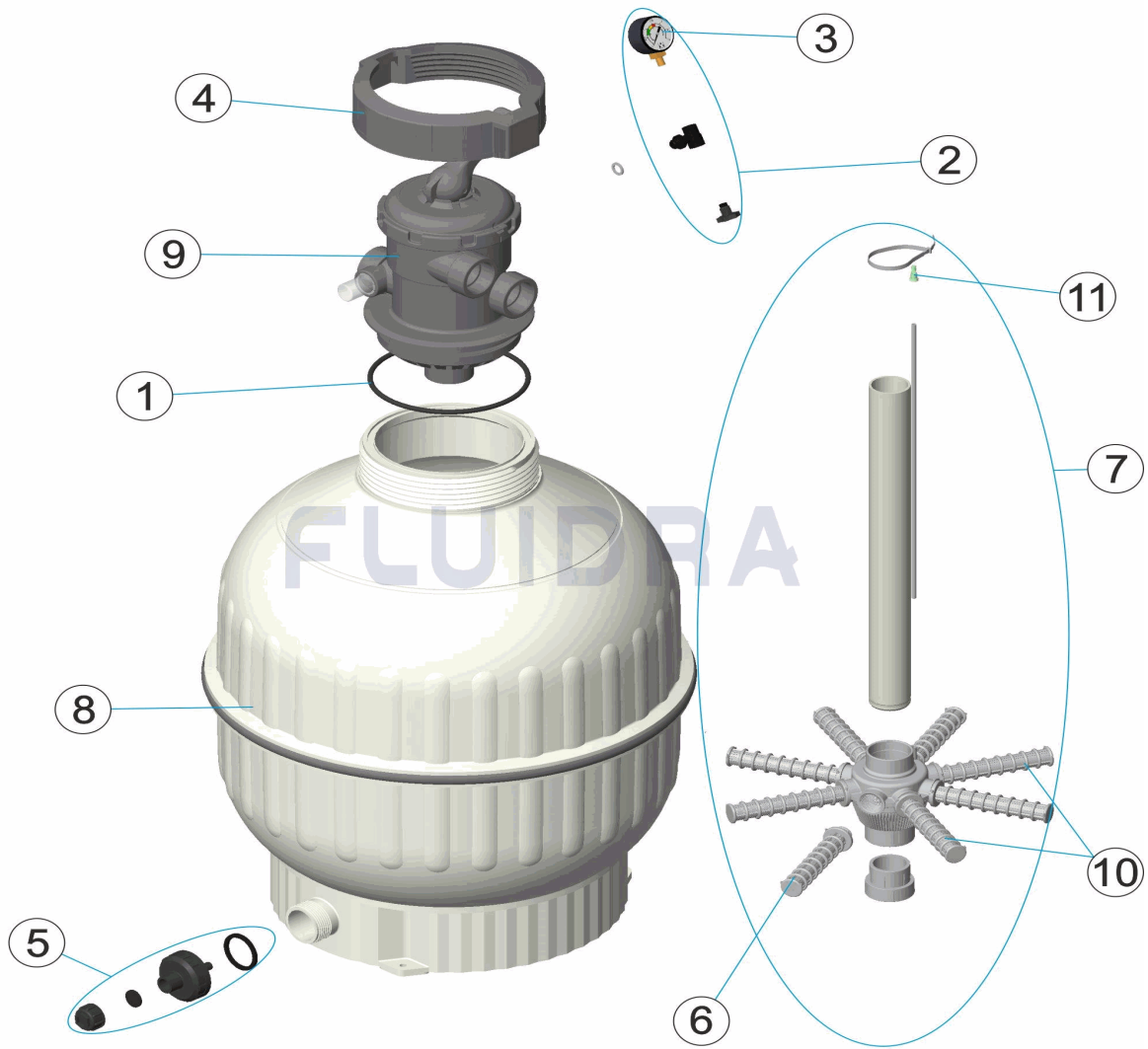

ENGLISH

POS	CODE	DESCRIPTION	QUANTITY	POS	CODE	DESCRIPTION	QUANTITY
1	4404180201	O' RING		7	* 4404180022	COLLECTOR ASSEMBLY CANTABRIC D. 600	
2	4404220101	COMPLETE PRESSURE GAUGE UNIT		8	* 4404180017	PROFILE FACEPLATE D. 400	
3	4404220102	PRESSURE GAUGE 1/8" 3 KG./C "		8	* 4404180018	PROFILE FACEPLATE D. 500	
4	4404180204	OPEN THREADED COLLAR		8	* 4404180019	PROFILE FACEPLATE D. 600	
5	4404180110	SAND PURGE 1 "		9	4404120001	BAYONETTE MULTIPOINT VALVE	
6	* 4404300119	MANIFOLD ARM 3/4" 110 M "		10	* 4404010073	MANIFOLD ARM ASSEMBLY D. 350	
6	* 4404300120	MANIFOLD ARM 3/4" 160 M "		10	* 4404010074	MANIFOLD ARM ASSEMBLY D. 450 - 500	
6	* 4404300712	MANIFOLD ARM 3/4" 225 M "		10	* 4404010075	MANIFOLD ARM ASSEMBLY D. 600	
7	* 4404180020	COLLECTOR ASSEMBLY CANTABRIC D. 40		11	4404040108	AIR PURGE	
7	* 4404180021	COLLECTOR ASSEMBLY CANTABRIC D. 50					

CODE **15780, 15781, 22399**

DESCRIPTION: **CANTABRIC TOP FILTER 400 500 600**

OBSERVATIONS

POS	CODE	OBSERVATIONS
6	* 4404300119	FOR: 22399 [4UT]
6	* 4404300120	FOR: 15780 [4UT]
6	* 4404300712	FOR: 15781 [4UT]
7	* 4404180020	FOR: 22399
7	* 4404180021	FOR: 15780
7	* 4404180022	FOR: 15781
8	* 4404180017	FOR: 22399
8	* 4404180018	FOR: 15780
8	* 4404180019	FOR: 15781
10	* 4404010073	FOR: 22399
10	* 4404010074	FOR: 15780
10	* 4404010075	FOR: 15781